



CERTIFICATION OF TAX DEED APPLICATION

Sections 197.502 and 197.542, Florida Statutes

DR-513
Rule 12D-16.002 F.A.C
Effective 07/19
Page 1 of 2

0326-15

Part 1: Tax Deed Application Information

| | | | |
|-------------------------------------|---|-------------------------|--------------|
| Applicant Name Applicant Address | IDE IDE TECHNOLOGIES INC 3641 N.52 AVE HOLLYWOOD, FL 33021 | Application date | Jun 30, 2025 |
| Property description | MORSE PATRICK J EST OF 977 SANDY BAY DR PENSACOLA, FL 32506 977 SANDY BAY DR 10-2788-100 BEG AT A PT ON W LI OF LT 10 KOEHLERS POINT S/D PLAT DB 69 P 440 AT ITS INTER WITH N LI OF LILLIAN H (Full legal attached.) | Certificate # | 2023 / 5174 |
| | | Date certificate issued | 06/01/2023 |

Part 2: Certificates Owned by Applicant and Filed with Tax Deed Application

| Column 1 Certificate Number | Column 2 Date of Certificate Sale | Column 3 Face Amount of Certificate | Column 4 Interest | Column 5: Total (Column 3 + Column 4) |
|--------------------------------|--------------------------------------|--|----------------------|--|
| # 2023/5174 | 06/01/2023 | 1,004.60 | 376.73 | 1,381.33 |
| →Part 2: Total* | | | | 1,381.33 |

Part 3: Other Certificates Redeemed by Applicant (Other than County)

| Column 1 Certificate Number | Column 2 Date of Other Certificate Sale | Column 3 Face Amount of Other Certificate | Column 4 Tax Collector's Fee | Column 5 Interest | Total (Column 3 + Column 4 + Column 5) |
|--------------------------------|---|---|---------------------------------|----------------------|--|
| # 2025/5478 | 06/01/2025 | 1,133.36 | 6.25 | 56.67 | 1,196.28 |
| # 2024/5250 | 06/01/2024 | 1,090.93 | 6.25 | 94.55 | 1,191.73 |
| Part 3: Total* | | | | | 2,388.01 |

Part 4: Tax Collector Certified Amounts (Lines 1-7)

| | |
|---|----------|
| 1. Cost of all certificates in applicant's possession and other certificates redeemed by applicant (*Total of Parts 2 + 3 above) | 3,769.34 |
| 2. Delinquent taxes paid by the applicant | 0.00 |
| 3. Current taxes paid by the applicant | 0.00 |
| 4. Property information report fee | 200.00 |
| 5. Tax deed application fee | 175.00 |
| 6. Interest accrued by tax collector under s.197.542, F.S. (see Tax Collector Instructions, page 2) | 0.00 |
| 7. Total Paid (Lines 1-6) | 4,144.34 |

I certify the above information is true and the tax certificates, interest, property information report fee, and tax collector's fees have been paid, and that the property information statement is attached.

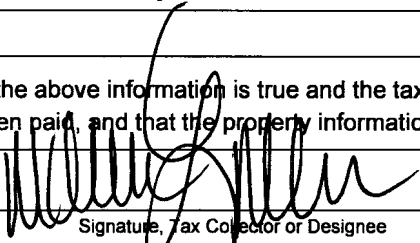
Sign here: 
Signature, Tax Collector or Designee

Escambia, Florida
Date July 2nd, 2025

Send this certification to the Clerk of Court by 10 days after the date signed. See Instructions on Page 2

Part 5: Clerk of Court Certified Amounts (Lines 8-14)

| | |
|---|--|
| 8. Processing tax deed fee | |
| 9. Certified or registered mail charge | |
| 10. Clerk of Court advertising, notice for newspaper, and electronic auction fees | |
| 11. Recording fee for certificate of notice | |
| 12. Sheriff's fees | |
| 13. Interest (see Clerk of Court Instructions, page 2) | |
| 14. Total Paid (Lines 8-13) | |
| 15. Plus one-half of the assessed value of homestead property, if applicable under s. 197.502(6)(c), F.S. | |
| 16. Statutory opening bid (total of Lines 7, 14, 15, and 16 if applicable) | |
| | |
| Sign here: _____ Date of sale <u>03/04/2026</u> | |
| Signature, Clerk of Court or Designee | |

INSTRUCTIONS

Tax Collector (complete Parts 1-4)

Part 2: Certificates Owned by Applicant and Filed with Tax Deed Application

Enter the Face Amount of Certificate in Column 3 and the Interest in Column 4 for each certificate number. Add Columns 3 and 4 and enter the amount in Column 5.

Part 3: Other Certificates Redeemed by Applicant (Other than County)

Total. Add the amounts in Columns 3, 4 and 5

Part 4: Tax Collector Certified Amounts (Lines 1-7)

Line 1, enter the total of Part 2 plus the total of Part 3 above.

Total Paid, Line 7: Add the amounts of Lines 1-6

Line 6, Interest accrued by tax collector. Calculate the 1.5 percent interest accrued from the month after the date of application through the month this form is certified to the clerk. Enter the amount to be certified to the clerk on Line 6. The interest calculated by the tax collector stops before the interest calculated by the clerk begins. See Section 197.542, F.S., and Rule 12D-13.060(3), Florida Administrative Code.

The tax collector's interest for redemption at the time of the tax deed application is a cost of redemption, which encompasses various percentages of interest on certificates and omitted or delinquent taxes under Section 197.502, F.S. This interest is calculated before the tax collector calculates the interest in Section 197.542, F.S.

Attach certified statement of names and addresses of persons who must be notified before the sale of the property. Send this form and any required attachments to the Clerk of Court within 10 days after it is signed.

Clerk of Court (complete Part 5)

Line 13: Interest is calculated at the rate of 1.5 percent per month starting from the first day of the month after the month of certification of this form through the last day of the month in which the sale will be held. Multiply the calculated rate by the total of Line 7, minus Line 6, plus Lines 8 through 12. Enter the amount on Line 13.

Line 14: Enter the total of Lines 8-13. Complete Lines 15-18, if applicable.

BEG AT A PT ON W LI OF LT 10 KOEHLERS POINT S/D PLAT DB 69 P 440 AT ITS INTER WITH N LI OF LILLIAN HW (66 FT R/W) N 1 DEG 07 MIN E ALG SD W LI 482 7/10 FT TO POB CONT SAME COURSE 50 FT S 88 DEG 53 MIN E 110 FT S 1 DEG 07 MIN W 50 FT N 88 DEG 53 MIN 110 FT TO POB OR 1615 P 50 LESS OR 4187 P 1168 RD R/W

APPLICATION FOR TAX DEED

Section 197.502, Florida Statutes

512
R. 12/16

Application Number: 2500617

To: Tax Collector of ESCAMBIA COUNTY, Florida

I,
IDE
IDE TECHNOLOGIES INC
3641 N.52 AVE
HOLLYWOOD, FL 33021,

hold the listed tax certificate and hereby surrender the same to the Tax Collector and make tax deed application thereon:

| Account Number | Certificate No. | Date | Legal Description |
|----------------|-----------------|------------|---|
| 10-2788-100 | 2023/5174 | 06-01-2023 | BEG AT A PT ON W LI OF LT 10 KOEHLERS POINT S/D PLAT DB 69 P 440 AT ITS INTER WITH N LI OF LILLIAN H/W (66 FT R/W) N 1 DEG 07 MIN E ALG SD W LI 482 7/10 FT TO POB CONT SAME COURSE 50 FT S 88 DEG 53 MIN E 110 FT S 1 DEG 07 MIN W 50 FT N 88 DEG 53 MIN 110 FT TO POB OR 1615 P 50 LESS OR 4187 P 1168 RD R/W |

I agree to:

- pay any current taxes, if due and
- redeem all outstanding tax certificates plus interest not in my possession, and
- pay all delinquent and omitted taxes, plus interest covering the property.
- pay all Tax Collector's fees, property information report costs, Clerk of the Court costs, charges and fees, and Sheriff's costs, if applicable.

Attached is the tax sale certificate on which this application is based and all other certificates of the same legal description which are in my possession.

Electronic signature on file
IDE
IDE TECHNOLOGIES INC
3641 N.52 AVE
HOLLYWOOD, FL 33021

06-30-2025
Application Date

Applicant's signature



Gary "Bubba" Peters

Escambia County Property Appraiser

[Real Estate Search](#)
[Tangible Property Search](#)
[Sale List](#)
[Back](#)

[← Nav. Mode](#)
☒ Account
 ☐ Parcel ID
 [➔](#)

[Printer Friendly Version](#)

| General Information | | Assessments | | | | |
|--|---|--|-------------|--------------|--------------|----------------|
| Parcel ID: | 0325321102002010 | Year | Land | Imprv | Total | Cap Val |
| Account: | 102788100 | 2024 | \$17,000 | \$57,089 | \$74,089 | \$63,880 |
| Owners: | MORSE PATRICK J EST OF | 2023 | \$17,000 | \$54,041 | \$71,041 | \$58,073 |
| Mail: | 977 SANDY BAY DR PENSACOLA, FL 32506 | 2022 | \$10,625 | \$48,221 | \$58,846 | \$52,794 |
| Situs: | 977 SANDY BAY DR 32506 | Disclaimer | | | | |
| Use Code: | SINGLE FAMILY RESID 🔍 | Tax Estimator | | | | |
| Taxing Authority: | COUNTY MSTU | Change of Address | | | | |
| Tax Inquiry: | Open Tax Inquiry Window | File for Exemption(s) Online | | | | |
| Tax Inquiry link courtesy of Scott Lunsford Escambia County Tax Collector | | Report Storm Damage | | | | |

| | |
|---|---|
| Sales Data Type List 🔍 | 2024 Certified Roll Exemptions |
| Sale Date Book Page Value Type Multi Parcel Records 02/1982 1615 50 \$26,534 WD N 📄 | None |
| Official Records Inquiry courtesy of Pam Childers Escambia County Clerk of the Circuit Court and Comptroller | Legal Description |
| | BEG AT A PT ON W LI OF LT 10 KOEHLERS POINT S/D PLAT DB 69 P 440 AT ITS INTER WITH N LI OF LILLIAN H/W (66 FT R/W) N... 🔍 |
| | Extra Features |
| | METAL BUILDING |

| Parcel Information | | Launch Interactive Map | |
|---|---|--|--|
| <div>Section Map Id: 03-25-32</div> <div>Approx. Acreage: 0.1249</div> <div>Zoned: MDR</div> <div>Evacuation & Flood Information Open Report</div> | <div> </div> <div>12.65</div> <div></div> | <div></div> <div>View Florida Department of Environmental Protection(DEP) Data</div> | |

[Buildings](#)

Address: 977 SANDY BAY DR, Improvement Type: SINGLE FAMILY, Year Built: 1958, Effective Year: 1960, PA Building ID#: 117207

Structural Elements

DECOR/MILLWORK-AVERAGE
DWELLING UNITS-1
EXTERIOR WALL-CONCRETE BLOCK
FLOOR COVER-ASPHALT TILE
FOUNDATION-SLAB ON GRADE
HEAT/AIR-WALL/FLOOR FURN
INTERIOR WALL-DRYWALL-PLASTER
NO. PLUMBING FIXTURES-3
NO. STORIES-1
ROOF COVER-BLT UP ON WOOD
ROOF FRAMING-FLAT/SHED
STORY HEIGHT-0
STRUCTURAL FRAME-MASONRY PIL/STL



Areas - 924 Total SF

BASE AREA - 840

OPEN PORCH FIN - 84

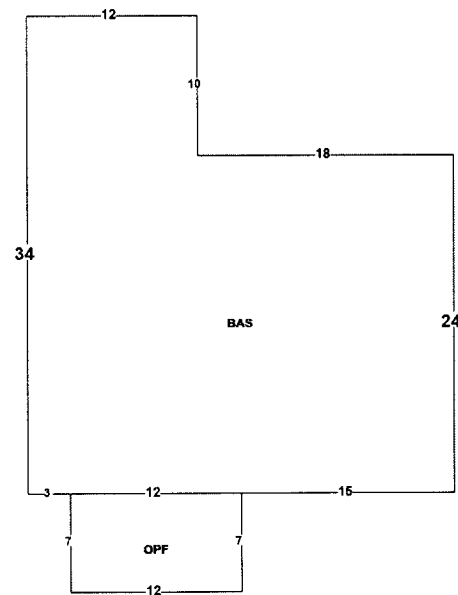

Images



6/21/2021 12:00:00 AM

The primary use of the assessment data is for the preparation of the current year tax roll. No responsibility or liability is assumed for inaccuracies or errors.

Last Updated: 07/14/2025 (tc: 169500)

NOTICE OF APPLICATION FOR TAX DEED

NOTICE IS HEREBY GIVEN, That **IDE TECHNOLOGIES INC** holder of **Tax Certificate No. 05174**, issued the **1st** day of **June, A.D., 2023** has filed same in my office and has made application for a tax deed to be issued thereon. Said certificate embraces the following described property in the County of Escambia, State of Florida, to wit:

BEG AT A PT ON W LI OF LT 10 KOEHLERS POINT S/D PLAT DB 69 P 440 AT ITS INTER WITH N LI OF LILLIAN H/W (66 FT R/W) N 1 DEG 07 MIN E ALG SD W LI 482 7/10 FT TO POB CONT SAME COURSE 50 FT S 88 DEG 53 MIN E 110 FT S 1 DEG 07 MIN W 50 FT N 88 DEG 53 MIN 110 FT TO POB OR 1615 P 50 LESS OR 4187 P 1168 RD R/W

SECTION 03, TOWNSHIP 2 S, RANGE 32 W

TAX ACCOUNT NUMBER 102788100 (0326-15)

The assessment of the said property under the said certificate issued was in the name of

EST OF PATRICK J MORSE

Unless said certificate shall be redeemed according to law, the property described therein will be sold to the highest bidder at public auction at 10:00 A.M. on the **first** Wednesday in the month of March, which is the **4th day of March 2026**.

Dated this 15th day of July 2025.

For information regarding the Tax Deed auction, please contact the Tax Deeds Division at 850-595-3793 or email TAXDEEDS@ESCAMBIACLERK.COM.

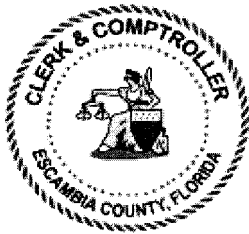

PAM CHILDERS
CLERK OF THE CIRCUIT COURT
ESCAMBIA COUNTY, FLORIDA

By:
Emily Hogg
Deputy Clerk