



# CERTIFICATION OF TAX DEED APPLICATION

Sections 197.502 and 197.542, Florida Statutes

DR-513  
Rule 12D-16.002 F.A.C  
Effective 07/19  
Page 1 of 2

0324-66

Part 1: Tax Deed Application Information			
Applicant Name Applicant Address	TLGFY, LLC CAPITAL ONE, N.A., AS COLLATERAL ASSIGNEE OF TLGFY, LLC PO BOX 669139 DALLAS, TX 75266-9139	Application date	Jul 26, 2023
Property description	ST LUKE MISSIONARY BAPTIST CHURCH 2436 N HIGHWAY 29 CANTONMENT, FL 32533 2436 N HIGHWAY 29 12-0566-700 BEG AT INTER OF N LI OF S1/2 OF NW1/4 OF NE1/4 OF SEC AND E LI OF US 29 RW S ALG CURVE OF RD 544 FT (Full legal attached.)	Certificate #	2021 / 5750
		Date certificate issued	06/01/2021

Part 2: Certificates Owned by Applicant and Filed with Tax Deed Application				
Column 1 Certificate Number	Column 2 Date of Certificate Sale	Column 3 Face Amount of Certificate	Column 4 Interest	Column 5: Total (Column 3 + Column 4)
# 2021/5750	06/01/2021	1,175.04	58.75	1,233.79
# 2022/6259	06/01/2022	1,184.77	59.24	1,244.01
→ Part 2: Total*				2,477.80

Part 3: Other Certificates Redeemed by Applicant (Other than County)					
Column 1 Certificate Number	Column 2 Date of Other Certificate Sale	Column 3 Face Amount of Other Certificate	Column 4 Tax Collector's Fee	Column 5 Interest	Total (Column 3 + Column 4 + Column 5)
# 2023/6387	06/01/2023	1,229.42	6.25	61.47	1,297.14
Part 3: Total*					1,297.14

Part 4: Tax Collector Certified Amounts (Lines 1-7)	
1. Cost of all certificates in applicant's possession and other certificates redeemed by applicant (*Total of Parts 2 + 3 above)	3,774.94
2. Delinquent taxes paid by the applicant	0.00
3. Current taxes paid by the applicant	0.00
4. Property information report fee	200.00
5. Tax deed application fee	175.00
6. Interest accrued by tax collector under s.197.542, F.S. (see Tax Collector Instructions, page 2)	0.00
7. <b>Total Paid (Lines 1-6)</b>	<b>4,149.94</b>

I certify the above information is true and the tax certificates, interest, property information report fee, and tax collector's fees have been paid, and that the property information statement is attached.

Sign here: Jennifer N. Cassidy Escambia, Florida  
 Signature, Tax Collector or Designee Date August 11th, 2023

Send this certification to the Clerk of Court by 10 days after the date signed. See Instructions on Page 2

+ \$12.50

<b>Part 5: Clerk of Court Certified Amounts (Lines 8-14)</b>	
8. Processing tax deed fee	
9. Certified or registered mail charge	
10. Clerk of Court advertising, notice for newspaper, and electronic auction fees	
11. Recording fee for certificate of notice	
12. Sheriff's fees	
13. Interest (see Clerk of Court Instructions, page 2)	
14. <b>Total Paid (Lines 8-13)</b>	
15. Plus one-half of the assessed value of homestead property, if applicable under s. 197.502(6)(c), F.S.	
16. Statutory opening bid (total of Lines 7, 14, 15, and 16 if applicable)	
Sign here: _____ Date of sale <u>03/06/2024</u>	
Signature, Clerk of Court or Designee	

**INSTRUCTIONS**

**Tax Collector (complete Parts 1-4)**

**Part 2: Certificates Owned by Applicant and Filed with Tax Deed Application**

Enter the Face Amount of Certificate in Column 3 and the Interest in Column 4 for each certificate number. Add Columns 3 and 4 and enter the amount in Column 5.

**Part 3: Other Certificates Redeemed by Applicant (Other than County)**

**Total.** Add the amounts in Columns 3, 4 and 5

**Part 4: Tax Collector Certified Amounts (Lines 1-7)**

**Line 1,** enter the total of Part 2 plus the total of Part 3 above.

**Total Paid, Line 7:** Add the amounts of Lines 1-6

**Line 6, Interest accrued by tax collector.** Calculate the 1.5 percent interest accrued from the month after the date of application through the month this form is certified to the clerk. Enter the amount to be certified to the clerk on **Line 6**. The interest calculated by the tax collector stops before the interest calculated by the clerk begins. See Section 197.542, F.S., and Rule 12D-13.060(3), Florida Administrative Code.

The tax collector's interest for redemption at the time of the tax deed application is a cost of redemption, which encompasses various percentages of interest on certificates and omitted or delinquent taxes under Section 197.502, F.S. This interest is calculated before the tax collector calculates the interest in Section 197.542, F.S.

Attach certified statement of names and addresses of persons who must be notified before the sale of the property. Send this form and any required attachments to the Clerk of Court within 10 days after it is signed.

**Clerk of Court (complete Part 5)**

**Line 13: Interest** is calculated at the rate of 1.5 percent per month starting from the first day of the month after the month of certification of this form through the last day of the month in which the sale will be held. Multiply the calculated rate by the total of **Line 7**, minus **Line 6**, plus **Lines 8** through **12**. Enter the amount on **Line 13**.

**Line 14:** Enter the total of Lines 8-13. Complete Lines 15-18, if applicable.

BEG AT INTER OF N LI OF S1/2 OF NW1/4 OF NE1/4 OF SEC AND E LI OF US 29 R/W S ALG CURVE OF RD 544 FT FOR POB N 54 DEG 39 MIN E 100 FT S 39 DEG 42 MIN E 100 FT S 54 DEG 39 MIN W 100 FT N 40 DEG 27 MIN W 18 1/10 FT TO CURVE TO RIGHT HAVING RADIUS OF 2732 93/100 FT ALG CURVE 81 9/10 FT TO POB OR 380 P 364 ALSO BEG AT SE COR OF NW1/4 OF NE1/4 OF SEC N 87 DEG 5 MIN 38 SEC W ALG S LI 461 36/100 FT TO ELY R/W LI OF HWY 29 (200 FT R/W) N 37 DEG 50 MIN 27 SEC W 197 09/ 100 FT N 57 DEG 15 MIN 33 SEC E 100 FT FOR POB N 57 DEG 15 MIN 33 SEC E 52 88/ 100 FT N 33 DEG 58 MIN 31 SEC W 35 37/100 FT N 87 DEG 1 MIN 21 SEC W 71 41/100 FT S 37 DEG 5 MIN 27 SEC E 77 27/100 FT TO POB OR 5976 P 1616

# APPLICATION FOR TAX DEED

Section 197.502, Florida Statutes

512  
R. 12/16

Application Number: 2300530

To: Tax Collector of ESCAMBIA COUNTY, Florida

I,  
TLGFY, LLC  
CAPITAL ONE, N.A., AS COLLATERAL ASSIGNEE OF TLGFY, LLC  
PO BOX 669139  
DALLAS, TX 75266-9139,

hold the listed tax certificate and hereby surrender the same to the Tax Collector and make tax deed application thereon:

Account Number	Certificate No.	Date	Legal Description
12-0566-700	2021/5750	06-01-2021	BEG AT INTER OF N LI OF S1/2 OF NW1/4 OF NE1/4 OF SEC AND E LI OF US 29 R/W S ALG CURVE OF RD 544 FT FOR POB N 54 DEG 39 MIN E 100 FT S 39 DEG 42 MIN E 100 FT S 54 DEG 39 MIN W 100 FT N 40 DEG 27 MIN W 18 1/10 FT TO CURVE TO RIGHT HAVING RADIUS OF 2732 93/100 FT ALG CURVE 81 9/10 FT TO POB OR 380 P 364 ALSO BEG AT SE COR OF NW1/4 OF NE1/4 OF SEC N 87 DEG 5 MIN 38 SEC W ALG S LI 461 36/100 FT TO ELY R/W LI OF HWY 29 (200 FT R/W) N 37 DEG 50 MIN 27 SEC W 197 09/ 100 FT N 57 DEG 15 MIN 33 SEC E 100 FT FOR POB N 57 DEG 15 MIN 33 SEC E 52 88/ 100 FT N 33 DEG 58 MIN 31 SEC W 35 37/100 FT N 87 DEG 1 MIN 21 SEC W 71 41/100 FT S 37 DEG 5 MIN 27 SEC E 77 27/100 FT TO POB OR 5976 P 1616

I agree to:

- pay any current taxes, if due and
- redeem all outstanding tax certificates plus interest not in my possession, and
- pay all delinquent and omitted taxes, plus interest covering the property.
- pay all Tax Collector's fees, property information report costs, Clerk of the Court costs, charges and fees, and Sheriff's costs, if applicable.

Attached is the tax sale certificate on which this application is based and all other certificates of the same legal description which are in my possession.

Electronic signature on file  
TLGFY, LLC  
CAPITAL ONE, N.A., AS COLLATERAL ASSIGNEE OF  
TLGFY, LLC  
PO BOX 669139  
DALLAS, TX 75266-9139

07-26-2023  
Application Date

---

Applicant's signature



# Chris Jones Escambia County Property Appraiser

[Real Estate Search](#)

[Tangible Property Search](#)

[Sale List](#)

[Back](#)

◀ Nav. Mode  Account  Parcel ID ▶

[Printer Friendly Version](#)

General Information		Assessments				
<b>Parcel ID:</b>	332N311201012001	<b>Year</b>	<b>Land</b>	<b>Imprv</b>	<b>Total</b>	<b>Cap Val</b>
<b>Account:</b>	120566700	2023	\$4,133	\$61,858	\$65,991	\$65,991
<b>Owners:</b>	ST LUKE MISSIONARY BAPTIST CHURCH	2022	\$4,133	\$61,452	\$65,585	\$65,585
<b>Mail:</b>	2436 N HIGHWAY 29 CANTONMENT, FL 32533	2021	\$4,133	\$58,314	\$62,447	\$62,447
<b>Situs:</b>	2436 N HIGHWAY 29 32533	<b>Disclaimer</b>				
<b>Use Code:</b>	CHURCH 🔍	<b>Tax Estimator</b>				
<b>Units:</b>	2	<b>File for New Homestead Exemption Online</b>				
<b>Taxing Authority:</b>	COUNTY MSTU	<b>Report Storm Damage</b>				
<b>Tax Inquiry:</b>	<a href="#">Open Tax Inquiry Window</a>					
Tax Inquiry link courtesy of Scott Lunsford Escambia County Tax Collector						

Sales Data						2023 Certified Roll Exemptions
<b>Sale Date</b>	<b>Book</b>	<b>Page</b>	<b>Value</b>	<b>Type</b>	<b>Official Records (New Window)</b>	None
01/1975	887	582	\$100	QC		<b>Legal Description</b> 🔍
Official Records Inquiry courtesy of Pam Childers Escambia County Clerk of the Circuit Court and Comptroller						BEG AT INTER OF N LI OF S1/2 OF NW1/4 OF NE1/4 OF SEC AND E LI OF US 29 R/W S ALG CURVE OF RD 544 FT FOR POB N 54 DEG...
						<b>Extra Features</b>
						None

**Section**

**Map Id:**  
33-2N-31

**Approx. Acreage:**  
0.3017

**Zoned:** 🔍  
RMU  
RMU

**Evacuation & Flood Information**  
[Open Report](#)

[View Florida Department of Environmental Protection\(DEP\) Data](#)

**Parcel Information** [Launch Interactive Map](#)

Buildings
Address: 2436 N HIGHWAY 29, Year Built: 1965, Effective Year: 1965, PA Building ID#: 13110

**Structural Elements**

**DECOR/MILLWORK-BELOW AVERAGE**  
**DWELLING UNITS-1**  
**EXTERIOR WALL-CONCRETE BLOCK**  
**FLOOR COVER-VINYL ASBESTOS**  
**FOUNDATION-SLAB ON GRADE**  
**HEAT/AIR-CENTRAL H/AC**  
**INTERIOR WALL-PANEL-PLYWOOD**  
**NO. PLUMBING FIXTURES-4**  
**NO. STORIES-1**  
**ROOF COVER-DIMEN/ARCH SHNG**  
**ROOF FRAMING-GABLE**  
**STORY HEIGHT-10**  
**STRUCTURAL FRAME-MASONRY PIL/STL**

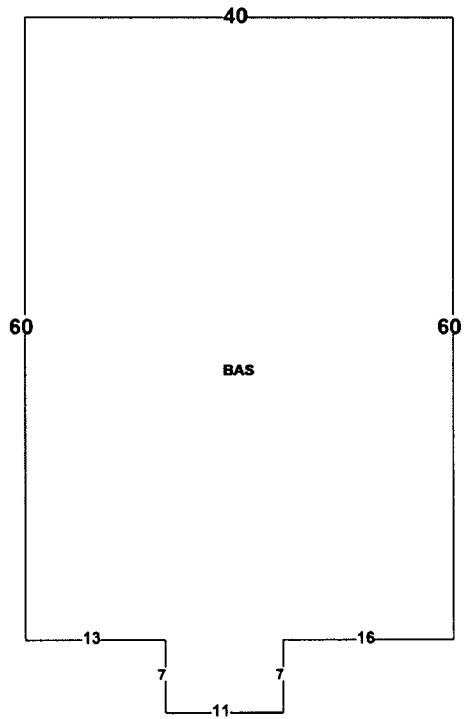

**Areas - 2477 Total SF**

**BASE AREA - 2477**

Year Built: 1950, Effective Year: 1950, PA Building ID#: 13111

**Structural Elements**

**DECOR/MILLWORK-BELOW AVERAGE**  
**DWELLING UNITS-1**  
**EXTERIOR WALL-SIDING-SHT.AVG.**  
**FLOOR COVER-PINE/SOFTWOOD**  
**FOUNDATION-WOOD/SUB FLOOR**  
**HEAT/AIR-UNIT HEATERS**  
**INTERIOR WALL-PANEL-PLYWOOD**  
**NO. PLUMBING FIXTURES-3**  
**NO. STORIES-1**  
**ROOF COVER-DIMEN/ARCH SHNG**  
**ROOF FRAMING-GABLE**  
**STORY HEIGHT-8**  
**STRUCTURAL FRAME-WOOD FRAME**

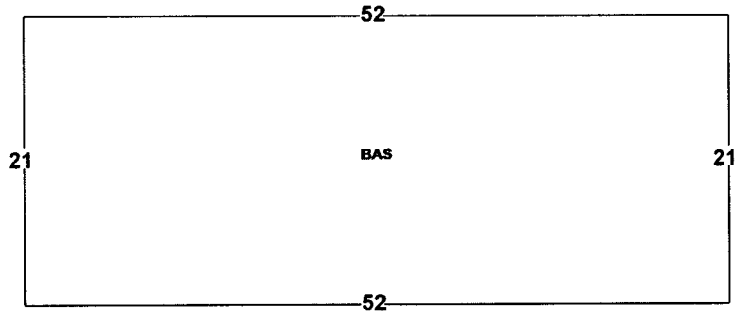

**Areas - 1092 Total SF**

**BASE AREA - 1092**

**Images**



7/15/2019 12:00:00 AM

The primary use of the assessment data is for the preparation of the current year tax roll. No responsibility or liability is assumed for inaccuracies or errors.

## NOTICE OF APPLICATION FOR TAX DEED

NOTICE IS HEREBY GIVEN, That **TLGFY LLC** holder of **Tax Certificate No. 05750**, issued the **1st** day of **June, A.D., 2021** has filed same in my office and has made application for a tax deed to be issued thereon. Said certificate embraces the following described property in the County of Escambia, State of Florida, to wit:

(see attached)

**SECTION 33, TOWNSHIP 2 N, RANGE 31 W**

**TAX ACCOUNT NUMBER 120566700 (0324-66)**

The assessment of the said property under the said certificate issued was in the name of

**ST LUKE MISSIONARY BAPTIST CHURCH**

Unless said certificate shall be redeemed according to law, the property described therein will be sold to the highest bidder at public auction at 9:00 A.M. on the **first** Wednesday in the month of March, which is the **6th day of March 2024**.

Dated this 18th day of August 2023.

In accordance with the AMERICANS WITH DISABILITIES ACT, if you are a person with a disability who needs special accommodation in order to participate in this proceeding you are entitled to the provision of certain assistance. Please contact Emily Hogg not later than seven days prior to the proceeding at Escambia County Government Complex, 221 Palafox Place Ste 110, Pensacola FL 32502. Telephone: 850-595-3793.



PAM CHILDERS  
CLERK OF THE CIRCUIT COURT  
ESCAMBIA COUNTY, FLORIDA

By:  
Emily Hogg  
Deputy Clerk

# LEGAL DESCRIPTION

BEG AT INTER OF N LI OF S1/2 OF NW1/4 OF NE1/4 OF SEC AND E LI OF US 29 R/W S ALG CURVE OF RD 544 FT FOR POB N 54 DEG 39 MIN E 100 FT S 39 DEG 42 MIN E 100 FT S 54 DEG 39 MIN W 100 FT N 40 DEG 27 MIN W 18 1/10 FT TO CURVE TO RIGHT HAVING RADIUS OF 2732 93/100 FT ALG CURVE 81 9/10 FT TO POB OR 380 P 364 ALSO BEG AT SE COR OF NW1/4 OF NE1/4 OF SEC N 87 DEG 5 MIN 38 SEC W ALG S LI 461 36/100 FT TO ELY R/W LI OF HWY 29 (200 FT R/W) N 37 DEG 50 MIN 27 SEC W 197 09/100 FT N 57 DEG 15 MIN 33 SEC E 100 FT FOR POB N 57 DEG 15 MIN 33 SEC E 52 88/100 FT N 33 DEG 58 MIN 31 SEC W 35 37/100 FT N 87 DEG 1 MIN 21 SEC W 71 41/100 FT S 37 DEG 5 MIN 27 SEC E 77 27/100 FT TO POB OR 5976 P 1616



**PAM CHILDERS**  
 CLERK OF THE CIRCUIT COURT  
 ARCHIVES AND RECORDS  
 CHILDSUPPORT  
 CIRCUIT CIVIL  
 CIRCUIT CRIMINAL  
 COUNTY CIVIL  
 COUNTY CRIMINAL  
 DOMESTIC RELATIONS  
 FAMILY LAW  
 JURY ASSEMBLY  
 JUVENILE  
 MENTAL HEALTH  
 MIS  
 OPERATIONAL SERVICES  
 PROBATE  
 TRAFFIC



**COUNTY OF ESCAMBIA  
 OFFICE OF THE  
 CLERK OF THE CIRCUIT COURT**

**BRANCH OFFICES  
 ARCHIVES AND RECORDS  
 JUVENILE DIVISION  
 CENTURY**

CLERK TO THE BOARD OF  
 COUNTY COMMISSIONERS  
 OFFICIAL RECORDS  
 COUNTY TREASURY  
 AUDITOR

**PAM CHILDERS, CLERK OF THE CIRCUIT COURT  
 Tax Certificate Redeemed From Sale  
 Account: 120566700 Certificate Number: 005750 of 2021**

**Payor: ST LUKE MISSIONARY BAPTIST CHURCH 2436 NORTH HWY 29 CANTONMENT, FL  
 32533 Date 9/25/2023**

Clerk's Check #	6635803834	Clerk's Total	\$510.72
Tax Collector Check #	1	Tax Collector's Total	\$4,660.43
		Postage	\$60.00
		Researcher Copies	\$0.00
		Recording	\$10.00
		Prep Fee	\$7.00
		Total Received	<del>\$5,248.15</del>

**\$4,436.62**  
~~\$5,248.15~~  
**\$4,453.62**

**PAM CHILDERS**  
 Clerk of the Circuit Court

Received By:  
 Deputy Clerk

**PAM CHILDERS**  
 CLERK OF THE CIRCUIT COURT  
 ARCHIVES AND RECORDS  
 CHILDSUPPORT  
 CIRCUIT CIVIL  
 CIRCUIT CRIMINAL  
 COUNTY CIVIL  
 COUNTY CRIMINAL  
 DOMESTIC RELATIONS  
 FAMILY LAW  
 JURY ASSEMBLY  
 JUVENILE  
 MENTAL HEALTH  
 MIS  
 OPERATIONAL SERVICES  
 PROBATE  
 TRAFFIC



**BRANCH OFFICES**  
**ARCHIVES AND RECORDS**  
**JUVENILE DIVISION**  
**CENTURY**

CLERK TO THE BOARD OF  
 COUNTY COMMISSIONERS  
 OFFICIAL RECORDS  
 COUNTY TREASURY  
 AUDITOR

**COUNTY OF ESCAMBIA**  
**OFFICE OF THE**  
**CLERK OF THE CIRCUIT COURT**

**Case # 2021 TD 005750**  
**Redeemed Date 9/25/2023**

**Name ST LUKE MISSIONARY BAPTIST CHURCH 2436 NORTH HWY 29 CANTONMENT, FL 32533**

Clerk's Total = TAXDEED	\$510.72	<del>\$510.72</del> \$4,436.62
Due Tax Collector = TAXDEED	\$4,660.43	
Postage = TD2	\$60.00	
ResearcherCopies = TD6	\$0.00	
Release TDA Notice (Recording) = RECORD2	\$10.00	
Release TDA Notice (Prep Fee) = TD4	\$7.00	

• For Office Use Only

Date	Docket	Desc	Amount Owed	Amount Due	Payee Name
------	--------	------	-------------	------------	------------

**FINANGIAL SUMMARY**

No Information Available - See Dockets



**PAM CHILDERS**  
**CLERK OF THE CIRCUIT COURT**  
**ESCAMBIA COUNTY, FLORIDA**

**Tax Deed - Redemption Calculator**

**Account: 120566700 Certificate Number: 005750 of 2021**

Redemption  No  Application Date  Interest Rate

	Final Redemption Payment ESTIMATED	Redemption Overpayment ACTUAL
	Auction Date <input type="text" value="3/6/2024"/>	Redemption Date <input type="text" value="9/25/2023"/>
Months	8	2
Tax Collector	<input type="text" value="\$4,149.94"/>	<input type="text" value="\$4,149.94"/>
Tax Collector Interest	\$497.99	\$124.50
Tax Collector Fee	<input type="text" value="\$12.50"/>	<input type="text" value="\$12.50"/>
Total Tax Collector	\$4,660.43	<input type="text" value="\$4,286.94"/> TC
Record TDA Notice	<input type="text" value="\$17.00"/>	<input type="text" value="\$17.00"/>
Clerk Fee	<input type="text" value="\$119.00"/>	<input type="text" value="\$119.00"/>
Sheriff Fee	<input type="text" value="\$120.00"/>	<input type="text" value="\$120.00"/>
Legal Advertisement	<input type="text" value="\$200.00"/>	<input type="text" value="\$200.00"/>
App. Fee Interest	\$54.72	\$13.68
Total Clerk	\$510.72	<input type="text" value="\$469.68"/> CH
Release TDA Notice (Recording)	<input type="text" value="\$10.00"/>	<input type="text" value="\$10.00"/>
Release TDA Notice (Prep Fee)	<input type="text" value="\$7.00"/>	<input type="text" value="\$7.00"/>
Postage	<input type="text" value="\$60.00"/>	<input type="text" value="\$0.00"/>
Researcher Copies	<input type="text" value="\$0.00"/>	<input type="text" value="\$0.00"/>
Total Redemption Amount	\$5,248.15	\$4,773.62
	Repayment Overpayment Refund Amount	\$474.53
Book/Page	<input type="text" value="9028"/>	<input type="text" value="1554"/>

**RELEASE OF NOTICE OF APPLICATION FOR TAX DEED**

Pursuant to § 197.502(5)(c), Florida Statutes, the Escambia County Clerk of Court fully releases the Notice of Tax Deed Application recorded at Official Records Book 9028, Page 1554, of Escambia County, for the tax certificate, tax deed, and property described below:

Tax Certificate No. Certificate No. 05750, issued the 1st day of June, A.D., 2021

TAX ACCOUNT NUMBER: 120566700 (0324-66)

(see attached)

**SECTION 33, TOWNSHIP 2 N, RANGE 31 W**

NAME IN WHICH ASSESSED: ST LUKE MISSIONARY BAPTIST CHURCH

Dated this 25th day of September 2023.



PAM CHILDERS  
CLERK OF THE CIRCUIT COURT  
ESCAMBIA COUNTY, FLORIDA

By:  
Emily Hogg  
Deputy Clerk

## LEGAL DESCRIPTION

BEG AT INTER OF N LI OF S1/2 OF NW1/4 OF NE1/4 OF SEC AND E LI OF US 29 R/W S ALG CURVE OF RD 544 FT FOR POB N 54 DEG 39 MIN E 100 FT S 39 DEG 42 MIN E 100 FT S 54 DEG 39 MIN W 100 FT N 40 DEG 27 MIN W 18 1/10 FT TO CURVE TO RIGHT HAVING RADIUS OF 2732 93/100 FT ALG CURVE 81 9/10 FT TO POB OR 380 P 364 ALSO BEG AT SE COR OF NW1/4 OF NE1/4 OF SEC N 87 DEG 5 MIN 38 SEC W ALG S LI 461 36/100 FT TO ELY R/W LI OF HWY 29 (200 FT R/W) N 37 DEG 50 MIN 27 SEC W 197 09/ 100 FT N 57 DEG 15 MIN 33 SEC E 100 FT FOR POB N 57 DEG 15 MIN 33 SEC E 52 88/ 100 FT N 33 DEG 58 MIN 31 SEC W 35 37/100 FT N 87 DEG 1 MIN 21 SEC W 71 41/100 FT S 37 DEG 5 MIN 27 SEC E 77 27/100 FT TO POB OR 5976 P 1616