



CERTIFICATION OF TAX DEED APPLICATION

Sections 197.502 and 197.542, Florida Statutes

DR-513
Rule 12D-16.002 F.A.C
Effective 07/19
Page 1 of 2

0422-22

Part 1: Tax Deed Application Information

Applicant Name Applicant Address	CITRUS CAPITAL HOLDINGS, LLC CITRUS CAPITAL HOLDINGS FBO SEC PTY PO BOX 54226 NEW ORLEANS, LA 70154-4226	Application date	Apr 16, 2021
Property description	ROGGEVEEN PHILIP 1816 TULLY RD # 280 SAN JOSE, CA 95122 9950 LYNNDAL DR 11-4445-770 BEG AT SE COR OF SW 1/4 OF SE 1/4 OF SEC 33 N ALG E LI OF SW 1/2 OF SE 1/4 433 FT FOR POB CONT SAME (Full legal attached.)	Certificate #	2019 / 6739
		Date certificate issued	06/01/2019

Part 2: Certificates Owned by Applicant and Filed with Tax Deed Application

Column 1 Certificate Number	Column 2 Date of Certificate Sale	Column 3 Face Amount of Certificate	Column 4 Interest	Column 5: Total (Column 3 + Column 4)
# 2019/6739	06/01/2019	1,602.09	80.10	1,682.19
→Part 2: Total*				1,682.19

Part 3: Other Certificates Redeemed by Applicant (Other than County)

Column 1 Certificate Number	Column 2 Date of Other Certificate Sale	Column 3 Face Amount of Other Certificate	Column 4 Tax Collector's Fee	Column 5 Interest	Total (Column 3 + Column 4 + Column 5)
# 2020/7101	06/01/2020	1,667.25	6.25	83.36	1,756.86
Part 3: Total*					1,756.86

Part 4: Tax Collector Certified Amounts (Lines 1-7)

1. Cost of all certificates in applicant's possession and other certificates redeemed by applicant (*Total of Parts 2 + 3 above)	3,439.05
2. Delinquent taxes paid by the applicant	0.00
3. Current taxes paid by the applicant	1,685.28
4. Property information report fee	200.00
5. Tax deed application fee	175.00
6. Interest accrued by tax collector under s.197.542, F.S. (see Tax Collector Instructions, page 2)	0.00
7. Total Paid (Lines 1-6)	5,499.33

I certify the above information is true and the tax certificates, interest, property information report fee, and tax collector's fees have been paid, and that the property information statement is attached.

Sign here: Candice Lewis
Signature, Tax Collector or Designee

Escambia, Florida
Date April 27th, 2021

Send this certification to the Clerk of Court by 10 days after the date signed. See Instructions on Page 2

Part 5: Clerk of Court Certified Amounts (Lines 8-14)	
8. Processing tax deed fee	
9. Certified or registered mail charge	
10. Clerk of Court advertising, notice for newspaper, and electronic auction fees	
11. Recording fee for certificate of notice	
12. Sheriff's fees	
13. Interest (see Clerk of Court Instructions, page 2)	
14. Total Paid (Lines 8-13)	
15. Plus one-half of the assessed value of homestead property, if applicable under s. 197.502(6)(c), F.S.	
16. Statutory opening bid (total of Lines 7, 14, 15, and 16 if applicable)	
Sign here: _____ Date of sale <u>04/04/2022</u> Signature, Clerk of Court or Designee	

INSTRUCTIONS + 6.25

Tax Collector (complete Parts 1-4)

Part 2: Certificates Owned by Applicant and Filed with Tax Deed Application
 Enter the Face Amount of Certificate in Column 3 and the Interest in Column 4 for each certificate number. Add Columns 3 and 4 and enter the amount in Column 5.

Part 3: Other Certificates Redeemed by Applicant (Other than County)
 Total. Add the amounts in Columns 3, 4 and 5

Part 4: Tax Collector Certified Amounts (Lines 1-7)

Line 1, enter the total of Part 2 plus the total of Part 3 above.

Total Paid, Line 7: Add the amounts of Lines 1-6

Line 6, Interest accrued by tax collector. Calculate the 1.5 percent interest accrued from the month after the date of application through the month this form is certified to the clerk. Enter the amount to be certified to the clerk on Line 6. The interest calculated by the tax collector stops before the interest calculated by the clerk begins. See Section 197.542, F.S., and Rule 12D-13.060(3), Florida Administrative Code.

The tax collector's interest for redemption at the time of the tax deed application is a cost of redemption, which encompasses various percentages of interest on certificates and omitted or delinquent taxes under Section 197.502, F.S. This interest is calculated before the tax collector calculates the interest in Section 197.542, F.S.

Attach certified statement of names and addresses of persons who must be notified before the sale of the property. Send this form and any required attachments to the Clerk of Court within 10 days after it is signed.

Clerk of Court (complete Part 5)

Line 13: Interest is calculated at the rate of 1.5 percent per month starting from the first day of the month after the month of certification of this form through the last day of the month in which the sale will be held. Multiply the calculated rate by the total of Line 7, minus Line 6, plus Lines 8 through 12. Enter the amount on Line 13.

Line 14: Enter the total of Lines 8-13. Complete Lines 15-18, if applicable.

BEG AT SE COR OF SW 1/4 OF SE 1/4 OF SEC 33 N ALG E LI OF SW 1/2 OF SE 1/4 433 FT FOR POB CONT SAME COURSE 300 FT W PARL TO N LI 200 FT TO E R/W LI OF RD S ALG SD R/W 300 FT E PARL TO N LI 200 FT TO POB OR 7355 P 197 LESS OR 4441 P 1052 WELCH

APPLICATION FOR TAX DEED

Section 197.502, Florida Statutes

512
R. 12/16

Application Number: 2100233

To: Tax Collector of ESCAMBIA COUNTY, Florida

I,
CITRUS CAPITAL HOLDINGS, LLC
CITRUS CAPITAL HOLDINGS FBO SEC PTY
PO BOX 54226
NEW ORLEANS, LA 70154-4226,

hold the listed tax certificate and hereby surrender the same to the Tax Collector and make tax deed application thereon:

Account Number	Certificate No.	Date	Legal Description
11-4445-770	2019/6739	06-01-2019	BEG AT SE COR OF SW 1/4 OF SE 1/4 OF SEC 33 N ALG E LI OF SW 1/2 OF SE 1/4 433 FT FOR POB CONT SAME COURSE 300 FT W PARL TO N LI 200 FT TO E R/W LI OF RD S ALG SD R/W 300 FT E PARL TO N LI 200 FT TO POB OR 7355 P 197 LESS OR 4441 P 1052 WELCH

I agree to:

- pay any current taxes, if due and
- redeem all outstanding tax certificates plus interest not in my possession, and
- pay all delinquent and omitted taxes, plus interest covering the property.
- pay all Tax Collector's fees, property information report costs, Clerk of the Court costs, charges and fees, and Sheriff's costs, if applicable.

Attached is the tax sale certificate on which this application is based and all other certificates of the same legal description which are in my possession.

Electronic signature on file
CITRUS CAPITAL HOLDINGS, LLC
CITRUS CAPITAL HOLDINGS FBO SEC PTY
PO BOX 54226
NEW ORLEANS, LA 70154-4226

04-16-2021
Application Date

Applicant's signature



Chris Jones Escambia County Property Appraiser

Real Estate Search

Tangible Property Search

Sale List

← Nav. Mode Account Reference →

Printer Friendly Version

<p>General Information</p> <p>Reference: 331N314320000000</p> <p>Account: 114445770</p> <p>Owners: ROGGEVEEN PHILIP</p> <p>Mail: C/O GARDINER CAPITAL LLC 716 LAKEWOOD RD PENSACOLA, FL 32507</p> <p>Situs: 9950 LYNNDALE DR 32526</p> <p>Use Code: SINGLE FAMILY RESID </p> <p>Taxing Authority: COUNTY MSTU</p> <p>Tax Inquiry: Open Tax Inquiry Window</p> <p>Tax Inquiry link courtesy of Scott Lunsford Escambia County Tax Collector</p>	<p>Assessments</p> <table border="1"> <thead> <tr> <th>Year</th> <th>Land</th> <th>Imprv</th> <th>Total</th> <th>Cap Val</th> </tr> </thead> <tbody> <tr> <td>2020</td> <td>\$19,800</td> <td>\$93,051</td> <td>\$112,851</td> <td>\$109,455</td> </tr> <tr> <td>2019</td> <td>\$11,514</td> <td>\$87,991</td> <td>\$99,505</td> <td>\$99,505</td> </tr> <tr> <td>2018</td> <td>\$11,514</td> <td>\$81,746</td> <td>\$93,260</td> <td>\$93,260</td> </tr> </tbody> </table> <p>Disclaimer</p> <p>Market Value Breakdown Letter</p> <p>Tax Estimator</p> <p>File for New Homestead Exemption Online</p> <p>Report Storm Damage</p>	Year	Land	Imprv	Total	Cap Val	2020	\$19,800	\$93,051	\$112,851	\$109,455	2019	\$11,514	\$87,991	\$99,505	\$99,505	2018	\$11,514	\$81,746	\$93,260	\$93,260																						
Year	Land	Imprv	Total	Cap Val																																							
2020	\$19,800	\$93,051	\$112,851	\$109,455																																							
2019	\$11,514	\$87,991	\$99,505	\$99,505																																							
2018	\$11,514	\$81,746	\$93,260	\$93,260																																							
<p>Sales Data</p> <table border="1"> <thead> <tr> <th>Sale Date</th> <th>Book</th> <th>Page</th> <th>Value</th> <th>Type</th> <th>Official Records (New Window)</th> </tr> </thead> <tbody> <tr> <td>02/17/2021</td> <td>8466</td> <td>655</td> <td>\$100</td> <td>QC</td> <td></td> </tr> <tr> <td>06/03/2015</td> <td>7355</td> <td>197</td> <td>\$27,600</td> <td>CT</td> <td></td> </tr> <tr> <td>03/16/2010</td> <td>6647</td> <td>370</td> <td>\$100</td> <td>CJ</td> <td></td> </tr> <tr> <td>01/11/2008</td> <td>6274</td> <td>1933</td> <td>\$100</td> <td>CJ</td> <td></td> </tr> <tr> <td>08/1981</td> <td>1575</td> <td>160</td> <td>\$2,800</td> <td>WD</td> <td></td> </tr> <tr> <td>01/1975</td> <td>948</td> <td>730</td> <td>\$2,800</td> <td>SC</td> <td></td> </tr> </tbody> </table> <p>Official Records Inquiry courtesy of Pam Childers Escambia County Clerk of the Circuit Court and Comptroller</p>	Sale Date	Book	Page	Value	Type	Official Records (New Window)	02/17/2021	8466	655	\$100	QC		06/03/2015	7355	197	\$27,600	CT		03/16/2010	6647	370	\$100	CJ		01/11/2008	6274	1933	\$100	CJ		08/1981	1575	160	\$2,800	WD		01/1975	948	730	\$2,800	SC		<p>2020 Certified Roll Exemptions</p> <p>None</p> <p>Legal Description </p> <p>BEG AT SE COR OF SW 1/4 OF SE 1/4 OF SEC 33 N ALG E LI OF SW 1/2 OF SE 1/4 433 FT FOR POB CONT SAME COURSE 300 FT W...</p> <p>Extra Features</p> <p>METAL BUILDING</p>
Sale Date	Book	Page	Value	Type	Official Records (New Window)																																						
02/17/2021	8466	655	\$100	QC																																							
06/03/2015	7355	197	\$27,600	CT																																							
03/16/2010	6647	370	\$100	CJ																																							
01/11/2008	6274	1933	\$100	CJ																																							
08/1981	1575	160	\$2,800	WD																																							
01/1975	948	730	\$2,800	SC																																							

<p>Parcel Information</p> <p>Section</p> <p>Map Id: 33-1N-31</p> <p>Approx. Acreage: 0.9960</p> <p>Zoned: LDR</p> <p>Evacuation & Flood Information</p> <p>Open Report</p>	<p>Launch Interactive Map</p>
---	---

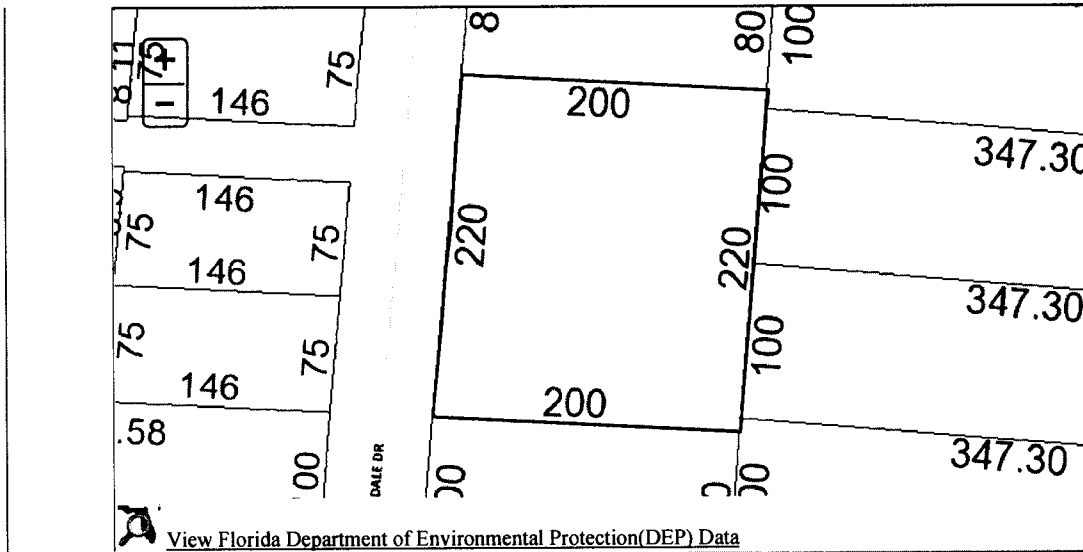

View Florida Department of Environmental Protection (DEP) Data

Buildings

Address: 9950 LYNNDALE DR, Year Built: 1989, Effective Year: 1989, PA Building ID#: 10752

Structural Elements

- DECOR/MILLWORK-AVERAGE
- DWELLING UNITS-1
- EXTERIOR WALL-BRICK-FACE/VENEER
- FLOOR COVER-CARPET
- FOUNDATION-SLAB ON GRADE
- HEAT/AIR-CENTRAL H/AC
- INTERIOR WALL-DRYWALL-PLASTER
- NO. PLUMBING FIXTURES-6
- NO. STORIES-1
- ROOF COVER-COMPOSITION SHG
- ROOF FRAMING-GABLE
- STORY HEIGHT-0
- STRUCTURAL FRAME-WOOD FRAME

Areas - 2019 Total SF

- BASE AREA - 1431
- GARAGE FIN - 324
- OPEN PORCH FIN - 96
- SCRN PORCH FIN - 168

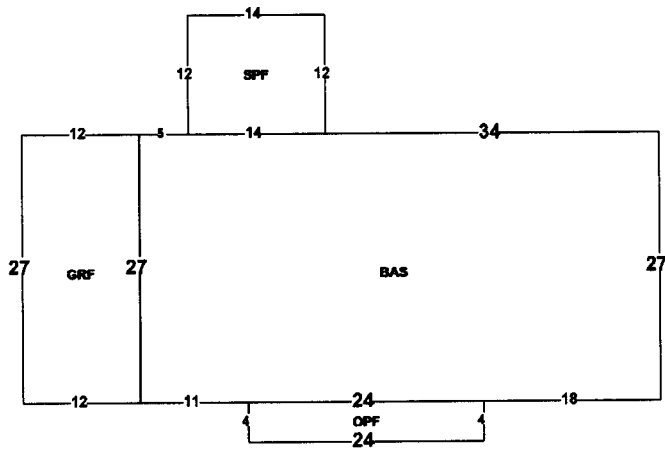

Images



5/20/16

The primary use of the assessment data is for the preparation of the current year tax roll. No responsibility or liability is assumed for inaccuracies or errors.

PAM CHILDERS
 CLERK OF THE CIRCUIT COURT
 ARCHIVES AND RECORDS
 CHILDSUPPORT
 CIRCUIT CIVIL
 CIRCUIT CRIMINAL
 COUNTY CIVIL
 COUNTY CRIMINAL
 DOMESTIC RELATIONS
 FAMILY LAW
 JURY ASSEMBLY
 JUVENILE
 MENTAL HEALTH
 MIS
 OPERATIONAL SERVICES
 PROBATE
 TRAFFIC



**COUNTY OF ESCAMBIA
 OFFICE OF THE
 CLERK OF THE CIRCUIT COURT**

**BRANCH OFFICES
 ARCHIVES AND RECORDS
 JUVENILE DIVISION
 CENTURY**

CLERK TO THE BOARD OF
 COUNTY COMMISSIONERS
 OFFICIAL RECORDS
 COUNTY TREASURY
 AUDITOR

**PAM CHILDERS, CLERK OF THE CIRCUIT COURT
 Tax Certificate Redeemed From Sale
 Account: 114445770 Certificate Number: 006739 of 2019**

Payor: PHILIP ROGGEVEEN 716 LAKEWOOD RD PENSACOLA, FL 32507 Date 05/11/2021

Clerk's Check #	6650602491	Clerk's Total	\$551.06 5,742.08
Tax Collector Check #	1	Tax Collector's Total	\$6,495.46
		Postage	\$0.00
		Researcher Copies	\$0.00
		Recording	\$10.00
		Prep Fee	\$7.00
		Total Received	\$7,123.52

\$5,759.08

**PAM CHILDERS
 Clerk of the Circuit Court**

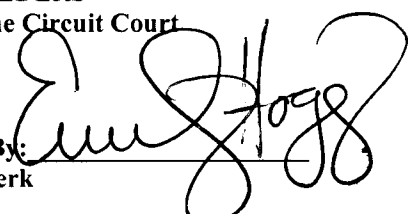
Received By: 
 Deputy Clerk

PAM CHILDERS
 CLERK OF THE CIRCUIT COURT
 ARCHIVES AND RECORDS
 CHILDSUPPORT
 CIRCUIT CIVIL
 CIRCUIT CRIMINAL
 COUNTY CIVIL
 COUNTY CRIMINAL
 DOMESTIC RELATIONS
 FAMILY LAW
 JURY ASSEMBLY
 JUVENILE
 MENTAL HEALTH
 MIS
 OPERATIONAL SERVICES
 PROBATE
 TRAFFIC



BRANCH OFFICES
ARCHIVES AND RECORDS
JUVENILE DIVISION
CENTURY

CLERK TO THE BOARD OF
 COUNTY COMMISSIONERS
 OFFICIAL RECORDS
 COUNTY TREASURY
 AUDITOR

COUNTY OF ESCAMBIA
OFFICE OF THE
CLERK OF THE CIRCUIT COURT

Case # 2019 TD 006739

Redeemed Date 05/11/2021

Name PHILIP ROGGEVEEN 716 LAKEWOOD RD PENSACOLA, FL 32507

Clerk's Total = TAXDEED	\$551.06 5,742.08
Due Tax Collector = TAXDEED	\$6,495.46
Postage = TD2	\$60.00
ResearcherCopies = TD6	\$0.00
Release TDA Notice (Recording) = RECORD2	\$10.00
Release TDA Notice (Prep Fee) = TD4	\$7.00

• For Office Use Only

Date	Docket	Desc	Amount Owed	Amount Due	Payee Name
------	--------	------	-------------	------------	------------

FINANCIAL SUMMARY

No Information Available - See Dockets

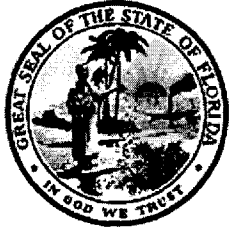

PAM CHILDERS
CLERK OF THE CIRCUIT COURT
ESCAMBIA COUNTY, FLORIDA

Tax Deed - Redemption Calculator
Account: 114445770 Certificate Number: 006739 of 2019

Redemption Yes
 Application Date
 Interest Rate

	Final Redemption Payment ESTIMATED	Redemption Overpayment ACTUAL
	Auction Date <input type="text" value="04/04/2022"/>	Redemption Date <input type="text" value="05/11/2021"/>
Months	12	1
Tax Collector	<input type="text" value="\$5,499.33"/>	<input type="text" value="\$5,499.33"/>
Tax Collector Interest	\$989.88	\$82.49
Tax Collector Fee	<input type="text" value="\$6.25"/>	<input type="text" value="\$6.25"/>
Total Tax Collector	\$6,495.46	<input type="text" value="\$5,588.07"/> TC
Record TDA Notice	<input type="text" value="\$17.00"/>	<input type="text" value="\$17.00"/>
Clerk Fee	<input type="text" value="\$130.00"/>	<input type="text" value="\$130.00"/>
Sheriff Fee	<input type="text" value="\$120.00"/>	<input type="text" value="\$120.00"/>
Legal Advertisement	<input type="text" value="\$200.00"/>	<input type="text" value="\$200.00"/>
App. Fee Interest	\$84.06	\$7.01
Total Clerk	\$551.06	<input type="text" value="\$474.01"/> CH
Release TDA Notice (Recording)	<input type="text" value="\$10.00"/>	<input type="text" value="\$10.00"/>
Release TDA Notice (Prep Fee)	<input type="text" value="\$7.00"/>	<input type="text" value="\$7.00"/>
Postage	<input type="text" value="\$60.00"/>	<input type="text" value="\$0.00"/>
Researcher Copies	<input type="text" value="\$0.00"/>	<input type="text" value="\$0.00"/>
Total Redemption Amount	\$7,123.52	\$6,079.08
	Repayment Overpayment Refund Amount	\$1,044.44
Book/Page	<input type="text"/>	<input type="text"/>

RELEASE OF NOTICE OF APPLICATION FOR TAX DEED

Pursuant to § 197.502(5)(c), Florida Statutes, the Escambia County Clerk of Court fully releases the Notice of Tax Deed Application recorded at Official Records Book 8528, Page 351, of Escambia County, for the tax certificate, tax deed, and property described below:

Tax Certificate No. Certificate No. 06739, issued the 1st day of June, A.D., 2019

TAX ACCOUNT NUMBER: 114445770 (0422-22)

DESCRIPTION OF PROPERTY:

**BEG AT SE COR OF SW 1/4 OF SE 1/4 OF SEC 33 N ALG E LI OF SW 1/2 OF SE 1/4 433 FT FOR
POB CONT SAME COURSE 300 FT W PARL TO N LI 200 FT TO E R/W LI OF RD S ALG SD
R/W 300 FT E PARL TO N LI 200 FT TO POB OR 7355 P 197 LESS OR 4441 P 1052 WELCH**

SECTION 33, TOWNSHIP 1 N, RANGE 31 W

NAME IN WHICH ASSESSED: PHILIP ROGGEVEEN

Dated this 11th day of May 2021.



PAM CHILDERS
CLERK OF THE CIRCUIT COURT
ESCAMBIA COUNTY, FLORIDA

By:
Emily Hogg
Deputy Clerk

NOTICE OF APPLICATION FOR TAX DEED

NOTICE IS HEREBY GIVEN, That **CITRUS CAPITAL HOLDINGS LLC** holder of **Tax Certificate No. 06739**, issued the **1st** day of **June, A.D., 2019** has filed same in my office and has made application for a tax deed to be issued thereon. Said certificate embraces the following described property in the County of Escambia, State of Florida, to wit:

BEG AT SE COR OF SW 1/4 OF SE 1/4 OF SEC 33 N ALG E LI OF SW 1/2 OF SE 1/4 433 FT FOR POB CONT SAME COURSE 300 FT W PARL TO N LI 200 FT TO E R/W LI OF RD S ALG SD R/W 300 FT E PARL TO N LI 200 FT TO POB OR 7355 P 197 LESS OR 4441 P 1052 WELCH

SECTION 33, TOWNSHIP 1 N, RANGE 31 W

TAX ACCOUNT NUMBER 114445770 (0422-22)

The assessment of the said property under the said certificate issued was in the name of

PHILIP ROGGEVEEN

Unless said certificate shall be redeemed according to law, the property described therein will be sold to the highest bidder at public auction at 9:00 A.M. on the **first** Monday in the month of April, which is the **4th** day of **April 2022**.

Dated this 11th day of May 2021.

In accordance with the AMERICANS WITH DISABILITIES ACT, if you are a person with a disability who needs special accommodation in order to participate in this proceeding you are entitled to the provision of certain assistance. Please contact Emily Hogg not later than seven days prior to the proceeding at Escambia County Government Complex, 221 Palafox Place Ste 110, Pensacola FL 32502. Telephone: 850-595-3793.



PAM CHILDERS
CLERK OF THE CIRCUIT COURT
ESCAMBIA COUNTY, FLORIDA

By:
Emily Hogg
Deputy Clerk