

TAX COLLECTOR'S CERTIFICATION

**Application
Date / Number
Apr 15, 2014 / 140066**

This is to certify that the holder listed below of Tax Sale Certificate Number **2012 / 10493.0000** , issued the **1st day of June, 2012**, and which encumbers the following described property located in the County of Escambia, State of Florida to wit: **Parcel ID Number: 14-3029-000**

Certificate Holder:
PPF HOLDINGS III LTD.
U.S. BANK CUSTODIAN FOR PPF HO
P.O. BOX 645051
CINCINNATI, OHIO 45264

Property Owner:
DEL GALLO PAMELA R
890 WOODBINE DR
PENSACOLA , FLORIDA 32503

Legal Description:
E 35 FT OF LT 4 AND W 27 1/2 FT OF LT 5 BLK 358 NEW CITY TRACT OR 6332 P 312 CA 36

has surrendered same in my office and made written application for tax deed in accordance with Florida Statutes. I certify that the following tax certificates, interest, ownership and encumbrance report fee, and Tax Collector's fees have been paid:

CERTIFICATES OWNED BY APPLICANT AND FILED IN CONNECTION WITH THIS TAX DEED APPLICATION:

Cert. Year	Certificate Number	Date of Sale	Face Amt	T/C Fee	Interest	Total
2012	10493.0000	06/01/12	\$1,602.44	\$0.00	\$138.21	\$1,740.65

CERTIFICATES REDEEMED BY APPLICANT OR INCLUDED (COUNTY) IN CONNECTION WITH THIS APPLICATION:

Cert. Year	Certificate Number	Date of Sale	Face Amt	T/C Fee	Interest	Total
2013	9580.0000	06/01/13	\$1,544.51	\$6.25	\$77.23	\$1,627.99

1. Total of all Certificates in Applicant's Possession and Cost of the Certificates Redeemed by Applicant or Included (County)	\$3,368.64
2. Total of Delinquent Taxes Paid by Tax Deed Application	\$0.00
3. Total of Current Taxes Paid by Tax Deed Applicant (2013)	\$1,422.99
4. Ownership and Encumbrance Report Fee	\$250.00
5. Tax Deed Application Fee	\$75.00
6. Total Certified by Tax Collector to Clerk of Court	\$5,116.63
7. Clerk of Court Statutory Fee	
8. Clerk of Court Certified Mail Charge	
9. Clerk of Court Advertising Charge	
10. Sheriff's Fee	
11. _____	
12. Total of Lines 6 thru 11	\$5,116.63
13. Interest Computed by Clerk of Court Per Florida Statutes.....(%)	
14. One-Half of the assessed value of homestead property. If applicable pursuant to section 197.502, F.S.	
15. Statutory (Opening) Bid; Total of Lines 12 thru 14	
16. Redemption Fee	\$6.25
17. Total Amount to Redeem	

*Done this 15th day of April, 2014

TAX COLLECTOR, ESCAMBIA COUNTY, FLORIDA

By Candice Lewis

Date of Sale: October 6, 2014

* This certification must be surrendered to the Clerk of the Circuit Court no later than ten days after this date.

Notice to Tax Collector of Application for Tax Deed

TO: Tax Collector of Escambia County

In accordance with Florida Statutes, I,

**PPF HOLDINGS III LTD.
U.S. BANK CUSTODIAN FOR PPF HO
P.O. BOX 645051
CINCINNATI, Ohio, 45264**

holder of the following tax sale certificate hereby surrender same to the Tax Collector and make tax deed application thereon:

Certificate No.	Parcel ID Number	Date	Legal Description
10493.0000	14-3029-000	06/01/2012	E 35 FT OF LT 4 AND W 27 1/2 FT OF LT 5 BLK 358 NEW CITY TRACT OR 6332 P 312 CA 36

2013 TAX ROLL

DEL GALLO PAMELA R
890 WOODBINE DR
PENSACOLA , Florida 32503

I agree to pay all delinquent taxes, redeem all outstanding certificates not in my possession, pay any omitted taxes, and pay current taxes, if due, covering the land, and pay any interest earned (a) on tax certificates not in my possession, (b) on omitted taxes or (c) on delinquent taxes. I also agree to pay all Tax Collector's fees, ownership and encumbrance reports costs, Clerk of the Court costs, charges and fees and Sheriff's costs, if applicable. Attached is the above-mentioned tax sale certificate on which this application is based and all other certificates of the same legal description which are in my possession.

tda2012 (Taimur Jamil)
Applicant's Signature

04/15/2014
Date



Chris Jones Escambia County Property Appraiser

- Real Estate Search
- Tangible Property Search
- Sale List
- Amendment 1/Portability Calculations

[Back](#)

← [Navigate Mode](#) [Account](#) [Reference](#) →

[Printer Friendly Version](#)

General Information	
Reference:	000S009025040358
Account:	143029000
Owners:	DEL GALLO PAMELA R
Mail:	890 WOODBINE DR PENSACOLA, FL 32503
Situs:	1551 E BAARS ST 32503
Use Code:	SINGLE FAMILY RESID
Taxing Authority:	PENSACOLA CITY LIMITS
Tax Inquiry:	Open Tax Inquiry Window
Tax Inquiry link courtesy of Janet Holley Escambia County Tax Collector	

2013 Certified Roll Assessment	
Improvements:	\$38,121
Land:	\$32,657
Total:	\$70,778
<i>Save Our Homes:</i>	\$0
Disclaimer	
Amendment 1/Portability Calculations	

Sales Data						
Sale Date	Book	Page	Value	Type	Official Records (New Window)	
05/22/2008	6332	312	\$100	WD	View Instr	
04/2002	4892	1788	\$65,600	WD	View Instr	
12/1985	2160	153	\$100	WD	View Instr	
12/1982	1790	181	\$100	QC	View Instr	
Official Records Inquiry courtesy of Pam Childers Escambia County Clerk of the Circuit Court and Comptroller						

2013 Certified Roll Exemptions	
None	
Legal Description	
E 35 FT OF LT 4 AND W 27 1/2 FT OF LT 5 BLK 358 NEW CITY TRACT OR 6332 P 312...	
Extra Features	
None	

Parcel Information

[Launch Interactive Map](#)

Section Map Id:
CA036

Approx. Acreage:
0.2000

Zoned:
R-1AA

Evacuation & Flood Information
[Open Report](#)

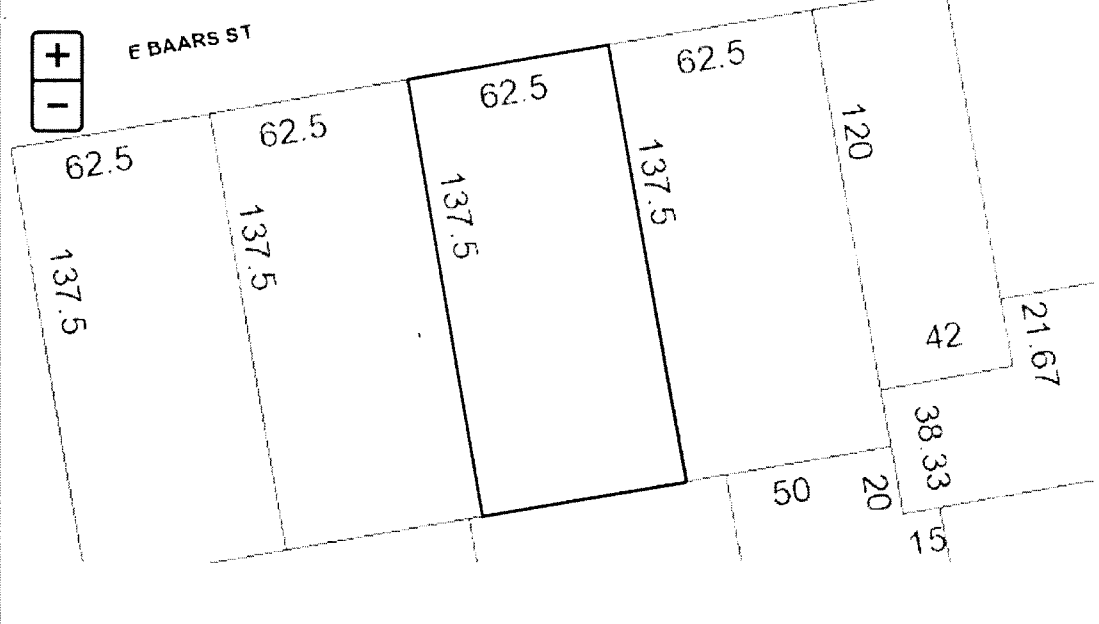

Buildings

Building 1 - Address: 1551 E BAARS ST, Year Built: 1953, Effective Year: 1965	
Structural Elements	
DECOR/MILLWORK-AVERAGE	
DWELLING UNITS-1.00	
EXTERIOR WALL-BRICK-COMMON	
EXTERIOR WALL-SIDING-SHT.AVG.	

FLOOR COVER-HARDWOOD/PARQET
FOUNDATION-SLAB ON GRADE
HEAT/AIR-CENTRAL H/AC
INTERIOR WALL-DRYWALL-PLASTER
NO. PLUMBING FIXTURES-3.00
NO. STORIES-1.00
ROOF COVER-COMPOSITION SHG
ROOF FRAMING-HIP
STRUCTURAL FRAME-WOOD FRAME

Areas - 1444 Total SF

BASE AREA - 1128
CARPORT FIN - 240
OPEN PORCH FIN - 76

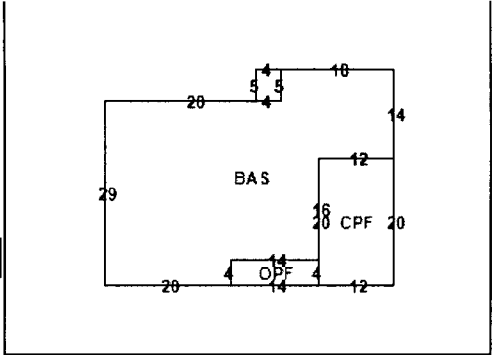

Images

None

The primary use of the assessment data is for the preparation of the current year tax roll. No responsibility or liability is assumed for inaccuracies or errors.