

**TAX COLLECTOR'S CERTIFICATION**

**Application  
Date / Number  
Apr 15, 2014 / 140055**

This is to certify that the holder listed below of Tax Sale Certificate Number **2012 / 7962.0000** , issued the **1st day of June, 2012**, and which encumbers the following described property located in the County of Escambia, State of Florida to wit: **Parcel ID Number: 11-1763-010**

**Certificate Holder:**  
PPF HOLDINGS III LTD.  
U.S. BANK CUSTODIAN FOR PPF HO  
P.O. BOX 645051  
CINCINNATI, OHIO 45264

**Property Owner:**  
CROLEY MILDRED & SIMS DOROTHY &  
20 UPTON RD  
CENTURY , FLORIDA 32535

**Legal Description:**

BEG SE COR OF NW 1/4 OF SE 1/4 W 447 FT N 60 DEG W TO E R/W LI OF HWY 29 NLY ALG R/W LI 567 FT 84 DEG 28 MIN RT 195 FT FOR POB CONT SAME COURSE 75 FT ...

**See attachment for full legal description.**

has surrendered same in my office and made written application for tax deed in accordance with Florida Statutes. I certify that the following tax certificates, interest, ownership and encumbrance report fee, and Tax Collector's fees have been paid:

**CERTIFICATES OWNED BY APPLICANT AND FILED IN CONNECTION WITH THIS TAX DEED APPLICATION:**

Cert. Year	Certificate Number	Date of Sale	Face Amt	T/C Fee	Interest	Total
2012	7962.0000	06/01/12	\$535.52	\$0.00	\$48.76	\$584.28

**CERTIFICATES REDEEMED BY APPLICANT OR INCLUDED (COUNTY) IN CONNECTION WITH THIS APPLICATION:**

Cert. Year	Certificate Number	Date of Sale	Face Amt	T/C Fee	Interest	Total
2013	7374.0000	06/01/13	\$642.01	\$6.25	\$32.10	\$680.36

1. Total of all Certificates in Applicant's Possession and Cost of the Certificates Redeemed by Applicant or Included (County)
2. Total of Delinquent Taxes Paid by Tax Deed Application
3. Total of Current Taxes Paid by Tax Deed Applicant (2013)
4. Ownership and Encumbrance Report Fee
5. Tax Deed Application Fee
6. Total Certified by Tax Collector to Clerk of Court
7. Clerk of Court Statutory Fee
8. Clerk of Court Certified Mail Charge
9. Clerk of Court Advertising Charge
10. Sheriff's Fee
11. \_\_\_\_\_
12. Total of Lines 6 thru 11
13. Interest Computed by Clerk of Court Per Florida Statutes.....( %)
14. One-Half of the assessed value of homestead property. If applicable pursuant to section 197.502, F.S.
15. Statutory (Opening) Bid; Total of Lines 12 thru 14
16. Redemption Fee
17. Total Amount to Redeem

\$1,264.64
\$0.00
\$590.89
\$250.00
\$75.00
\$2,180.53
\$2,180.53
\$32,251.00
\$6.25

\*Done this 15th day of April, 2014

TAX COLLECTOR, ESCAMBIA COUNTY, FLORIDA

By Candice Lewis

Date of Sale: October 6, 2014

\* This certification must be surrendered to the Clerk of the Circuit Court no later than ten days after this date.

FORM 513  
(r.12/00)

**TAX COLLECTOR'S CERTIFICATION**

**APPLICATION DATE**

4/15/2014

**FULL LEGAL DESCRIPTION**  
**Parcel ID Number: 11-1763-010**

April 23, 2014  
Tax Year: 2011  
Certificate Number: 7962.0000

BEG SE COR OF NW 1/4 OF SE 1/4 W 447 FT N 60 DEG W TO E R/W LI OF HWY 29 NLY ALG R/W LI 567 FT 84 DEG  
28 MIN RT 195 FT FOR POB CONT SAME COURSE 75 FT 90 DEG LEFT 115 FT 90 DEG LEFT 75 FT 90 DEG LEFT  
115 FT TO POB OR 6573 P 1012

## Notice to Tax Collector of Application for Tax Deed

**TO: Tax Collector of Escambia County**

In accordance with Florida Statutes, I,

**PPF HOLDINGS III LTD.  
U.S. BANK CUSTODIAN FOR PPF HO  
P.O. BOX 645051  
CINCINNATI, Ohio, 45264**

holder of the following tax sale certificate hereby surrender same to the Tax Collector and make tax deed application thereon:

<b>Certificate No.</b>	<b>Parcel ID Number</b>	<b>Date</b>	<b>Legal Description</b>
7962.0000	11-1763-010	06/01/2012	BEG SE COR OF NW 1/4 OF SE 1/4 W 447 FT N 60 DEG W TO E R/W LI OF HWY 29 NLY ALG R/W LI 567 FT 84 DEG 28 MIN RT 195 FT FOR POB CONT SAME COURSE 75 FT 90 DEG LEFT 115 FT 90 DEG LEFT 75 FT 90 DEG LEFT 115 FT TO POB OR 6573 P 1012

### **2013 TAX ROLL**

CROLEY MILDRED & SIMS DOROTHY &  
20 UPTON RD  
CENTURY , Florida 32535

I agree to pay all delinquent taxes, redeem all outstanding certificates not in my possession, pay any omitted taxes, and pay current taxes, if due, covering the land, and pay any interest earned (a) on tax certificates not in my possession, (b) on omitted taxes or (c) on delinquent taxes. I also agree to pay all Tax Collector's fees, ownership and encumbrance reports costs, Clerk of the Court costs, charges and fees and Sheriff's costs, if applicable. Attached is the above-mentioned tax sale certificate on which this application is based and all other certificates of the same legal description which are in my possession.

tda2012 (Taimur Jamil)  
Applicant's Signature

04/15/2014  
Date



# Chris Jones Escambia County Property Appraiser

- Real Estate Search
- Tangible Property Search
- Sale List
- Amendment 1/Portability Calculations

[Back](#)

← [Navigate Mode](#)  [Account](#)  [Reference](#) →

[Printer Friendly Version](#)

General Information	2013 Certified Roll Assessment
<b>Reference:</b> 075N304201001005	<b>Improvements:</b> \$64,915
<b>Account:</b> 111763010	<b>Land:</b> \$2,010
<b>Owners:</b> CROLEY MILDRED & SIMS DOROTHY & BUSH KATHY	<b>Total:</b> \$66,925
<b>Mail:</b> 20 UPTON RD CENTURY, FL 32535	<u>Save Our Homes:</u> \$64,502
<b>Situs:</b> 20 UPTON RD 32535	<a href="#">Disclaimer</a>
<b>Use Code:</b> SINGLE FAMILY RESID	<a href="#">Amendment 1/Portability Calculations</a>
<b>Taxing Authority:</b> CENTURY CITY LIMITS	
<b>Tax Inquiry:</b> <a href="#">Open Tax Inquiry Window</a>	
Tax Inquiry link courtesy of Janet Holley Escambia County Tax Collector	

Sales Data	2013 Certified Roll Exemptions
<b>Sale Date</b> <b>Book</b> <b>Page</b> <b>Value</b> <b>Type</b> <b>Official Records (New Window)</b>	HOMESTEAD EXEMPTION, WIDOW
03/25/2010 6573 1012 \$100 QC <a href="#">View Instr</a>	<b>Legal Description</b>
Official Records Inquiry courtesy of Pam Childers Escambia County Clerk of the Circuit Court and Comptroller	BEG SE COR OF NW 1/4 OF SE 1/4 W 447 FT N 60 DEG W TO E R/W LI OF HWY 29 NLY ALG R/W LI 567 FT 84 DEG 28 MIN RT 195 FT...
	<b>Extra Features</b>
	METAL SHED

**Parcel Information** [Launch Interactive Map](#)

**Section Map Id:**  
07-5N-30-2

**Approx. Acreage:**  
0.2300

**Zoned:**   
INCORP

**Evacuation & Flood Information**  
[Open Report](#)

Buildings
Building 1 - Address: 20 UPTON RD, Year Built: 1982, Effective Year: 1982
<b>Structural Elements</b>
DECOR/MILLWORK-AVERAGE
DWELLING UNITS-1.00
EXTERIOR WALL-BRICK-FACE
FLOOR COVER-HARDWOOD/PARQET

**FLOOR COVER-VINYL/CORK**  
**FOUNDATION-SLAB ON GRADE**  
**HEAT/AIR-CENTRAL H/AC**  
**INTERIOR WALL-DRYWALL-PLASTER**  
**INTERIOR WALL-PANEL-PLYWOOD**  
**NO. PLUMBING FIXTURES-6.00**  
**NO. STORIES-1.00**  
**ROOF COVER-COMPOSITION SHG**  
**ROOF FRAMING-GABLE**  
**STRUCTURAL FRAME-WOOD FRAME**

 Areas - 2778 Total SF
<b>BASE AREA - 1551</b>
<b>GARAGE FIN - 484</b>
<b>OPEN PORCH FIN - 248</b>
<b>PATIO - 253</b>
<b>UTILITY FIN - 242</b>

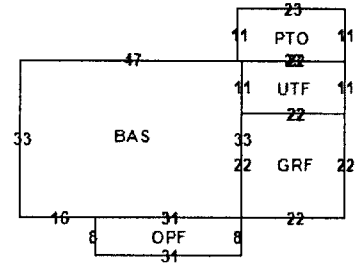

Images



11/15/10

The primary use of the assessment data is for the preparation of the current year tax roll. No responsibility or liability is assumed for inaccuracies or errors.

# Southern Guaranty Title Company

4400 Bayou Boulevard, Suite 13B

Pensacola, Florida 32503

Telephone: 850-478-8121

Facsimile: 850-476-1437

14-668

## OWNERSHIP AND ENCUMBRANCE REPORT

File No.: 11329

July 14, 2014

Escambia County Tax Collector  
P.O. Box 1312  
Pensacola, Florida 32591

Pursuant to your request, the Company has caused a search to be made of the Public Records of Escambia County, Florida, solely as revealed by records maintained from 07-14-1994, through 07-14-2014, and said search reveals the following:

1. THE GRANTEE(S) OF THE LAST DEED(S) OF RECORD IS:

Mildred Croley, Dorothy Sims AKA Dorothy L. Sims AKA Dorothy Croley Sims and Kathy Bush

2. The land covered by this Report is:

LEGAL DESCRIPTION IS ATTACHED HERETO AND MADE A PART HEREOF

3. The following unsatisfied mortgages, liens and judgments affecting the land covered by this Report appear of record:

SEE CONTINUATION PAGE ATTACHED HERETO AND MADE A PART HEREOF

4. Taxes:

SEE CONTINUATION PAGE ATTACHED HERETO AND MADE A PART HEREOF

The foregoing report is prepared and furnished for information only, is not intended to constitute or imply any opinion, warranty, guaranty, insurance, or similar assurance as to the status of title, and no determination has been made of the authenticity of any instrument described or referred to herein. The name search for the purposes of determining applicable judgments and liens is limited to the apparent record owner(s) shown herein, No attempt has been made to determine whether the land is subject to liens or assessments which are not shown as existing liens by the public records. The Company's liability hereunder shall not exceed the cost of this Report, or \$1,000.00 whichever is less.

THIS REPORT SHALL NOT BE USED FOR THE ISSUANCE OF TITLE INSURANCE.

Southern Guaranty Title Company

By: 

July 14, 2014

**OWNERSHIP AND ENCUMBRANCE REPORT  
LEGAL DESCRIPTION**

File No.: 11329

July 14, 2014

**075N304201001005 - Full Legal Description**

BEG SE COR OF NW 1/4 OF SE 1/4 W 447 FT N 60 DEG W TO E R/W LI OF HWY 29 NLY ALG R/W LI 567 FT 84  
DEG 28 MIN RT 195 FT FOR POB CONT SAME COURSE 75 FT 90 DEG LEFT 115 FT 90 DEG LEFT 75 FT 90 DEG  
LEFT 115 FT TO POB OR 6573 P 1012

# SOUTHERN GUARANTY TITLE COMPANY

4400 BAYOU BLVD., SUITE 13-B, CORDOVA SQUARE  
PENSACOLA, FLORIDA 32503

TEL. (850) 478-8121 FAX (850) 476-1437

Email: rcsqt@aol.com

Janet Holley  
Escambia County Tax Collector  
P.O. Box 1312  
Pensacola, FL 32596

CERTIFICATION: TITLE SEARCH FOR TDA

TAX DEED SALE DATE: 10-6-2014

TAX ACCOUNT NO.: 11-1763-010

CERTIFICATE NO.: 2012-~~7692~~ 7962

In compliance with Section 197.256, Florida Statutes, the following is a list of names and addresses of those persons, firms and/or agencies having legal interest in or claim against the above described property. The above referenced tax sale certificate is being submitted as proper notification of tax deed sale.

YES NO

- X Notify City of Pensacola, P.O. Box 12910, 32521
- X Notify Escambia County, 190 Governmental Center, 32502
- X Homestead for 2013 tax year.

Mildred Croley  
Kathy Bush  
20 Upton Rd.  
Century, FL 32535

Dorothy Sims aka  
Dorothy L. Sims aka  
Dorothy Croley Sims  
271 Cox Rd.  
McDavid, FL 32568

Certified and delivered to Escambia County Tax Collector,  
this 14th day of July, 2014.

SOUTHERN GUARANTY TITLE COMPANY

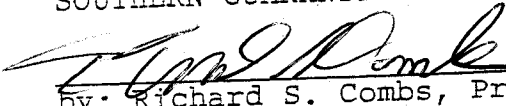
  
By: Richard S. Combs, President

NOTE: The above listed addresses are based upon current information available, but said addresses are not guaranteed to be true or correct.



STATE OF FLORIDA

COUNTY OF ESCAMBIA

THIS QUIT CLAIM DEED, Executed the 25<sup>th</sup> day of  
March, 2010 by Mildred Croley, widow of  
Raymond Croley, first party, to Mildred Croley, 20 Upton Road, Century, Florida  
32535, and daughters, Dorothy Sims, 271 Cox Road, McDavid, Florida 32568, and  
Kathy Bush, 3921 Hwy 4 A, Century, Florida 32535, second party. Joint tenants  
with rights of survivorship.

WITNESSETH, That the first party, for and in consideration of the sum of \$10.00 in  
hand paid by the said second parties, the receipt whereof is hereby acknowledged, does  
hereby remise, release, and quit claim unto the second parties forever, all the right, title,  
interest, claim and demand which the said first party has in and to the following described  
lot, piece or parcel of land, situate, lying and being in the County of Escambia, State of  
Florida, to wit:

**A parcel of land lying and being in the Northwest Quarter (NW 1/4) of Section 7,  
Township 5 North, Range 30 West, described as follows: Starting at the Southeast  
corner of the Northwest Quarter of the Southeast Quarter; thence West 447 feet;  
thence North 60 degrees West to East right-of-way line of State Highway 29; thence  
Northerly along said right-of-way 567 feet; thence at an angle of 84 degree 28  
minutes to the right 195 feet to point of beginning; thence continue 75 feet on same  
course, thence at an angle of 90 degrees to the left 115 feet; thence at an angle of 90  
degrees to the left 75 feet; thence at a angle of 90 degrees to the left 75 feet; thence at**

**an angle of 90 degrees to the left 115 feet to point of beginning. Recorded in Deed Book 516, Page 721 of the official records of Escambia County, Florida.**

TO HAVE AND TO HOLD The same together with all and singular the appurtenances thereunto belonging or in anywise appertaining, and all the estate, right, title, interest, lien, equity and claim whatsoever of the said first party, either in law or equity to the only proper use, benefit and behoof of the said second party forever.

IN WITNESS WHEREOF, the said first party has signed and sealed these presents the day and year first above written.

Signed, sealed and delivered in the presence of:

Louise Harwell  
Witness Signature  
Louise Harwell  
Printed Name

Kristina Wood  
Witness Signature  
Kristina Wood  
Printed Name

Mildred Croley  
MILDRED CROLEY, Grantor  
20 Upton Road  
Century, Florida 32535

STATE OF Florida  
COUNTY OF Escambia

I, hereby Certify that on this day, before me, an officer duly authorized to administer oaths and take acknowledgments, personally appeared, Mildred Croley, known to me to be the person described in and who executed the foregoing instrument, who acknowledged before me that she executed the same, and an oath was not taken. (Check one)  Said person is personally known to me.  Said person provided the following type of identification \_\_\_\_\_.

Witness my hand and official seal in the County and State last aforesaid this 25<sup>th</sup> day of March, 2010.

Karen R. Hughes  
Notary Public  
Karen R. Hughes  
Printed Name

NOTARY SEAL:



This instrument was prepared by Mildred Croley

**OWNERSHIP AND ENCUMBRANCE REPORT  
CONTINUATION PAGE**

File No.: 11329

July 14, 2014

UNSATISFIED MORTGAGES, LIENS AND JUDGMENTS AFFECTING THE LAND COVERED BY THIS REPORT THAT APPEAR OF RECORD:

1. Taxes for the year 2011-2013 delinquent. The assessed value is \$64,502.00. Tax ID 11-1763-010.

PLEASE NOTE THE FOLLOWING:

- A. Subject to current year taxes.
- B. Taxes and assessments due now or in subsequent years.
- C. Subject to Easements, Restrictions and Covenants of record.
- D. Encroachments, overlaps, boundary line disputes, and any other matters which would be disclosed by an accurate survey and inspection of the premises.
- E. Oil, gas and mineral or any other subsurface rights of any kind or nature.

**STATE OF FLORIDA  
COUNTY OF ESCAMBIA**

**CERTIFICATE OF NOTICE OF MAILING  
NOTICE OF APPLICATION FOR TAX DEED**

**CERTIFICATE # 07962 of 2012**

I, PAM CHILDERS, CLERK OF THE CIRCUIT COURT OF ESCAMBIA COUNTY, FLORIDA, do hereby certify that I did on September 4, 2014, mail a copy of the foregoing Notice of Application for Tax Deed, addressed to:

	MILDRED CROLEY 20 UPTON RD CENTURY, FL 32535	DOROTHY SIMS 20 UPTON RD CENTURY, FL 32535
KATHY BUSH 20 UPTON RD CENTURY, FL 32535	DOROTHY SIMS AKA DOROTHY L SIMS AKA DOROTHY CROLEY SIMS 271 COX RD MCDAVID FL 32568	

WITNESS my official seal this 4th day of September 2014.



PAM CHILDERS  
CLERK OF THE CIRCUIT COURT  
ESCAMBIA COUNTY, FLORIDA

By:  
Emily Hogg  
Deputy Clerk

## WARNING

THERE ARE UNPAID TAXES ON PROPERTY WHICH YOU OWN OR IN WHICH YOU HAVE A LEGAL INTEREST. THE PROPERTY WILL BE SOLD AT PUBLIC AUCTION ON October 6, 2014, UNLESS THE TAXES ARE PAID. SHOULD YOU NEED FURTHER INFORMATION CONTACT THE CLERK OF THE CIRCUIT COURT IMMEDIATELY AT THE COUNTY COURTHOUSE IN PENSACOLA, FLORIDA, OR CALL 850-595-3793.

## NOTICE OF APPLICATION FOR TAX DEED

NOTICE IS HEREBY GIVEN, That PPF HOLDINGS III LTD holder of Tax Certificate No. 07962, issued the 1st day of June, A.D., 2012 has filed same in my office and has made application for a tax deed to be issued thereon. Said certificate embraces the following described property in the County of Escambia, State of Florida, to wit:

BEG SE COR OF NW 1/4 OF SE 1/4 W 447 FT N 60 DEG W TO E R/W LI OF HWY 29 NLY ALG R/W LI 567 FT 84 DEG 28 MIN RT 195 FT FOR POB CONT SAME COURSE 75 FT 90 DEG LEFT 115 FT 90 DEG LEFT 75 FT 90 DEG LEFT 115 FT TO POB OR 6573 P 1012

SECTION 07, TOWNSHIP 5 N, RANGE 30 W

TAX ACCOUNT NUMBER 111763010 (14-668)

The assessment of the said property under the said certificate issued was in the name of

**MILDRED CROLEY and DOROTHY SIMS and KATHY BUSH**

Unless said certificate shall be redeemed according to law, the property described therein will be sold to the highest bidder at public auction at 9:00 A.M. on the first Monday in the month of October, which is the 6th day of October 2014.

Dated this 4th day of September 2014.

In accordance with the AMERICANS WITH DISABILITIES ACT, if you are a person with a disability who needs special accommodation in order to participate in this proceeding you are entitled to the provision of certain assistance. Please contact Emily Hogg not later than seven days prior to the proceeding at Escambia County Government Complex, 221 Palafox Place Ste 110, Pensacola FL 32502. Telephone: 850-595-3793.



PAM CHILDERS  
CLERK OF THE CIRCUIT COURT  
ESCAMBIA COUNTY, FLORIDA

By:  
Emily Hogg  
Deputy Clerk

## WARNING

THERE ARE UNPAID TAXES ON PROPERTY WHICH YOU OWN OR IN WHICH YOU HAVE A LEGAL INTEREST. THE PROPERTY WILL BE SOLD AT PUBLIC AUCTION ON October 6, 2014, UNLESS THE TAXES ARE PAID. SHOULD YOU NEED FURTHER INFORMATION CONTACT THE CLERK OF THE CIRCUIT COURT IMMEDIATELY AT THE COUNTY COURTHOUSE IN PENSACOLA, FLORIDA, OR CALL 850-595-3793.

## NOTICE OF APPLICATION FOR TAX DEED

NOTICE IS HEREBY GIVEN, That **PPF HOLDINGS III LTD** holder of Tax Certificate No. **07962**, issued the 1st day of **June, A.D., 2012** has filed same in my office and has made application for a tax deed to be issued thereon. Said certificate embraces the following described property in the County of Escambia, State of Florida, to wit:

**BEG SE COR OF NW 1/4 OF SE 1/4 W 447 FT N 60 DEG W TO E R/W LI OF HWY 29 NLY ALG R/W LI 567 FT 84 DEG 28 MIN RT 195 FT FOR POB CONT SAME COURSE 75 FT 90 DEG LEFT 115 FT 90 DEG LEFT 75 FT 90 DEG LEFT 115 FT TO POB OR 6573 P 1012**

**SECTION 07, TOWNSHIP 5 N, RANGE 30 W**

**TAX ACCOUNT NUMBER 111763010 (14-668)**

The assessment of the said property under the said certificate issued was in the name of

**MILDRED CROLEY and DOROTHY SIMS and KATHY BUSH**

Unless said certificate shall be redeemed according to law, the property described therein will be sold to the highest bidder at public auction at 9:00 A.M. on the **first** Monday in the month of October, which is the **6th day of October 2014**.

Dated this 4th day of September 2014.

In accordance with the AMERICANS WITH DISABILITIES ACT, if you are a person with a disability who needs special accommodation in order to participate in this proceeding you are entitled to the provision of certain assistance. Please contact Emily Hogg not later than seven days prior to the proceeding at Escambia County Government Complex, 221 Palafox Place Ste 110, Pensacola FL 32502. Telephone: 850-595-3793.

### Post Property:

**20 UPTON RD 32535**



**PAM CHILDERS  
CLERK OF THE CIRCUIT COURT  
ESCAMBIA COUNTY, FLORIDA**

By:  
Emily Hogg  
Deputy Clerk

## WARNING

THERE ARE UNPAID TAXES ON PROPERTY WHICH YOU OWN OR IN WHICH YOU HAVE A LEGAL INTEREST. THE PROPERTY WILL BE SOLD AT PUBLIC AUCTION ON October 6, 2014, UNLESS THE TAXES ARE PAID. SHOULD YOU NEED FURTHER INFORMATION CONTACT THE CLERK OF THE CIRCUIT COURT IMMEDIATELY AT THE COUNTY COURTHOUSE IN PENSACOLA, FLORIDA, OR CALL 850-595-3793.

## NOTICE OF APPLICATION FOR TAX DEED

NOTICE IS HEREBY GIVEN, That **PPF HOLDINGS III LTD** holder of Tax Certificate No. 07962, issued the 1st day of June, A.D., 2012 has filed same in my office and has made application for a tax deed to be issued thereon. Said certificate embraces the following described property in the County of Escambia, State of Florida, to wit:

**BEG SE COR OF NW 1/4 OF SE 1/4 W 447 FT N 60 DEG W TO E R/W LI OF HWY 29 NLY ALG R/W LI 567 FT 84 DEG 28 MIN RT 195 FT FOR POB CONT SAME COURSE 75 FT 90 DEG LEFT 115 FT 90 DEG LEFT 75 FT 90 DEG LEFT 115 FT TO POB OR 6573 P 1012**

**SECTION 07, TOWNSHIP 5 N, RANGE 30 W**

**TAX ACCOUNT NUMBER 111763010 (14-668)**

The assessment of the said property under the said certificate issued was in the name of

**MILDRED CROLEY and DOROTHY SIMS and KATHY BUSH**

Unless said certificate shall be redeemed according to law, the property described therein will be sold to the highest bidder at public auction at 9:00 A.M. on the first Monday in the month of October, which is the 6th day of October 2014.

Dated this 4th day of September 2014.

In accordance with the AMERICANS WITH DISABILITIES ACT, if you are a person with a disability who needs special accommodation in order to participate in this proceeding you are entitled to the provision of certain assistance. Please contact Emily Hogg not later than seven days prior to the proceeding at Escambia County Government Complex, 221 Palafox Place Ste 110, Pensacola FL 32502. Telephone: 850-595-3793.

### Personal Services:

**MILDRED CROLEY**  
20 UPTON RD  
CENTURY, FL 32535

**PAM CHILDERS**  
CLERK OF THE CIRCUIT COURT  
ESCAMBIA COUNTY, FLORIDA



By:  
Emily Hogg  
Deputy Clerk



## WARNING

THERE ARE UNPAID TAXES ON PROPERTY WHICH YOU OWN OR IN WHICH YOU HAVE A LEGAL INTEREST. THE PROPERTY WILL BE SOLD AT PUBLIC AUCTION ON October 6, 2014, UNLESS THE TAXES ARE PAID. SHOULD YOU NEED FURTHER INFORMATION CONTACT THE CLERK OF THE CIRCUIT COURT IMMEDIATELY AT THE COUNTY COURTHOUSE IN PENSACOLA, FLORIDA, OR CALL 850-595-3793.

## NOTICE OF APPLICATION FOR TAX DEED

NOTICE IS HEREBY GIVEN, That PPF HOLDINGS III LTD holder of Tax Certificate No. 07962, issued the 1st day of June, A.D., 2012 has filed same in my office and has made application for a tax deed to be issued thereon. Said certificate embraces the following described property in the County of Escambia, State of Florida, to wit:

BEG SE COR OF NW 1/4 OF SE 1/4 W 447 FT N 60 DEG W TO E R/W LI OF HWY 29 NLY ALG R/W LI 567 FT 84 DEG 28 MIN RT 195 FT FOR POB CONT SAME COURSE 75 FT 90 DEG LEFT 115 FT 90 DEG LEFT 75 FT 90 DEG LEFT 115 FT TO POB OR 6573 P 1012

SECTION 07, TOWNSHIP 5 N, RANGE 30 W

TAX ACCOUNT NUMBER 111763010 (14-668)

The assessment of the said property under the said certificate issued was in the name of

**MILDRED CROLEY and DOROTHY SIMS and KATHY BUSH**

Unless said certificate shall be redeemed according to law, the property described therein will be sold to the highest bidder at public auction at 9:00 A.M. on the first Monday in the month of October, which is the 6th day of October 2014.

Dated this 4th day of September 2014.

In accordance with the AMERICANS WITH DISABILITIES ACT, if you are a person with a disability who needs special accommodation in order to participate in this proceeding you are entitled to the provision of certain assistance. Please contact Emily Hogg not later than seven days prior to the proceeding at Escambia County Government Complex, 221 Palafox Place Ste 110, Pensacola FL 32502. Telephone: 850-595-3793.

### Personal Services:

**DOROTHY SIMS**  
20 UPTON RD  
CENTURY, FL 32535

PAM CHILDERS  
CLERK OF THE CIRCUIT COURT  
ESCAMBIA COUNTY, FLORIDA



By:  
Emily Hogg  
Deputy Clerk

## WARNING

THERE ARE UNPAID TAXES ON PROPERTY WHICH YOU OWN OR IN WHICH YOU HAVE A LEGAL INTEREST. THE PROPERTY WILL BE SOLD AT PUBLIC AUCTION ON October 6, 2014, UNLESS THE TAXES ARE PAID. SHOULD YOU NEED FURTHER INFORMATION CONTACT THE CLERK OF THE CIRCUIT COURT IMMEDIATELY AT THE COUNTY COURTHOUSE IN PENSACOLA, FLORIDA, OR CALL 850-595-3793.

## NOTICE OF APPLICATION FOR TAX DEED

NOTICE IS HEREBY GIVEN, That **PPF HOLDINGS III LTD** holder of Tax Certificate No. **07962**, issued the **1st** day of **June, A.D., 2012** has filed same in my office and has made application for a tax deed to be issued thereon. Said certificate embraces the following described property in the County of Escambia, State of Florida, to wit:

**BEG SE COR OF NW 1/4 OF SE 1/4 W 447 FT N 60 DEG W TO E R/W LI OF HWY 29 NLY ALG R/W LI 567 FT 84 DEG 28 MIN RT 195 FT FOR POB CONT SAME COURSE 75 FT 90 DEG LEFT 115 FT 90 DEG LEFT 75 FT 90 DEG LEFT 115 FT TO POB OR 6573 P 1012**

**SECTION 07, TOWNSHIP 5 N, RANGE 30 W**

**TAX ACCOUNT NUMBER 111763010 (14-668)**

The assessment of the said property under the said certificate issued was in the name of

**MILDRED CROLEY and DOROTHY SIMS and KATHY BUSH**

Unless said certificate shall be redeemed according to law, the property described therein will be sold to the highest bidder at public auction at 9:00 A.M. on the **first** Monday in the month of October, which is the **6th** day of **October 2014**.

Dated this 4th day of September 2014.

In accordance with the AMERICANS WITH DISABILITIES ACT, if you are a person with a disability who needs special accommodation in order to participate in this proceeding you are entitled to the provision of certain assistance. Please contact Emily Hogg not later than seven days prior to the proceeding at Escambia County Government Complex, 221 Palafox Place Ste 110, Pensacola FL 32502. Telephone: 850-595-3793.

### Personal Services:

**KATHY BUSH**  
20 UPTON RD  
CENTURY, FL 32535

**PAM CHILDERS**  
CLERK OF THE CIRCUIT COURT  
ESCAMBIA COUNTY, FLORIDA



By:  
Emily Hogg  
Deputy Clerk

12TD079162

<b>SENDER: COMP</b>	ON DELIVERY
<ul style="list-style-type: none"> <li>■ Complete items 1, 2, and 3. Also complete item 4 if Restricted Delivery is desired.</li> <li>■ Print your name and address on the reverse so that we can return the card to you.</li> <li>■ Attach this card to the back of the mailpiece, or on the front if space permits.</li> </ul>	<p>A. Signature <span style="float: right;"><input type="checkbox"/> Agent <input type="checkbox"/> Addressee</span>  <i>x Terry Bush</i></p> <p>B. Received by (Printed Name) <span style="float: right;">C. Date of Delivery</span>  <u>TERRY BUSH</u></p> <p>D. Is delivery address different from item 1? <input type="checkbox"/> Yes          If YES, enter delivery address below: <input type="checkbox"/> No</p>
<p>1. Article Addressed to:</p> <p style="text-align: center;">MILDRED CROLEY [14-668]          20 UPTON RD          CENTURY, FL 32535</p>	<p>3. Service Type</p> <p><input checked="" type="checkbox"/> Certified Mail <input type="checkbox"/> Express Mail  <input type="checkbox"/> Registered <input type="checkbox"/> Return Receipt for Merchandise  <input type="checkbox"/> Insured Mail <input type="checkbox"/> C.O.D.</p> <p>4. Restricted Delivery? (Extra Fee) <input type="checkbox"/> Yes</p>
<p>2. Article Number          (Transfer from service label) <u>7008 1830 0000 0238 4871</u></p>	
<p>PS Form 3811, February 2004 <span style="float: right;">Domestic Return Receipt 102595-02-M-1540</span></p>	

12/079162

<b>SENDER: COMPLETE THIS SECTION</b>	COMPLETE THIS SECTION ON DELIVERY
<ul style="list-style-type: none"> <li>■ Complete items 1, 2, and 3. Also complete item 4 if Restricted Delivery is desired.</li> <li>■ Print your name and address on the reverse so that we can return the card to you.</li> <li>■ Attach this card to the back of the mailpiece, or on the front if space permits.</li> </ul>	<p>A. Signature <span style="float: right;"><input type="checkbox"/> Agent <input type="checkbox"/> Addressee</span>  <i>x Terry Bush</i></p> <p>B. Received by (Printed Name) <span style="float: right;">C. Date of Delivery</span>  <u>TERRY BUSH</u></p> <p>D. Is delivery address different from item 1? <input type="checkbox"/> Yes          If YES, enter delivery address below: <input type="checkbox"/> No</p>
<p>1. Article Addressed to:</p> <p style="text-align: center;">KATHY BUSH [14-668]          20 UPTON RD          CENTURY, FL 32535</p>	<p>3. Service Type</p> <p><input checked="" type="checkbox"/> Certified Mail <input type="checkbox"/> Express Mail  <input type="checkbox"/> Registered <input type="checkbox"/> Return Receipt for Merchandise  <input type="checkbox"/> Insured Mail <input type="checkbox"/> C.O.D.</p> <p>4. Restricted Delivery? (Extra Fee) <input type="checkbox"/> Yes</p>
<p>2. Article Number          (Transfer from service label) <u>7008 1830 0000 0238 4895</u></p>	
<p>PS Form 3811, February 2004 <span style="float: right;">Domestic Return Receipt 102595-02-M-1540</span></p>	

SENDER: COMPLETE	SECTION ON DELIVERY
<ul style="list-style-type: none"> <li>Complete items 1, 2, and 3. Also complete item 4 if Restricted Delivery is desired.</li> <li>Print your name and address on the reverse so that we can return the card to you.</li> <li>Attach this card to the back of the mailpiece, or on the front if space permits.</li> </ul>	<p>A. Signature  <input checked="" type="checkbox"/> <i>Billy Lewis</i> <input type="checkbox"/> Agent  <input type="checkbox"/> Addressee</p> <p>B. Received by (Printed Name) _____ C. Date of Delivery            _____ 9/5/14</p>
<p>1. Article Addressed to:</p> <p>DOROTHY SIMS AKA DOROTHY L            SIMS AKA DOROTHY CROLEY SIMS            [14-668]            271 COX RD            MCDAVID FL 32568</p>	<p>D. Is delivery address different from item 1? <input type="checkbox"/> Yes            If YES, enter delivery address below: <input checked="" type="checkbox"/> No</p> <p>3. Service Type  <input checked="" type="checkbox"/> Certified Mail <input type="checkbox"/> Express Mail  <input type="checkbox"/> Registered <input type="checkbox"/> Return Receipt for Merchandise  <input type="checkbox"/> Insured Mail <input type="checkbox"/> C.O.D.</p> <p>4. Restricted Delivery? (Extra Fee) <input type="checkbox"/> Yes</p>
<p>2. Article Number (Transfer from service label) <u>7008 1830 0000 0238 4901</u></p>	
<p>PS Form 3811, February 2004 Domestic Return Receipt 102595-02-M-1540</p>	

SENDER: COMPLETE THIS SECTION	SECTION ON DELIVERY
<ul style="list-style-type: none"> <li>Complete items 1, 2, and 3. Also complete item 4 if Restricted Delivery is desired.</li> <li>Print your name and address on the reverse so that we can return the card to you.</li> <li>Attach this card to the back of the mailpiece, or on the front if space permits.</li> </ul>	<p>A. Signature  <input checked="" type="checkbox"/> <i>Terry Bush</i> <input type="checkbox"/> Agent  <input type="checkbox"/> Addressee</p> <p>B. Received by (Printed Name) _____ C. Date of Delivery            _____ TERRY BUSH</p>
<p>1. Article Addressed to:</p> <p>DOROTHY SIMS [14-668]            20 UPFON RD            CENTURY, FL 32535</p>	<p>D. Is delivery address different from item 1? <input type="checkbox"/> Yes            If YES, enter delivery address below: <input type="checkbox"/> No</p> <p>3. Service Type  <input checked="" type="checkbox"/> Certified Mail <input type="checkbox"/> Express Mail  <input type="checkbox"/> Registered <input type="checkbox"/> Return Receipt for Merchandise  <input type="checkbox"/> Insured Mail <input type="checkbox"/> C.O.D.</p> <p>4. Restricted Delivery? (Extra Fee) <input type="checkbox"/> Yes</p>
<p>2. Article Number (Transfer from service label) <u>7008 1830 0000 0238 4888</u></p>	
<p>PS Form 3811, February 2004 Domestic Return Receipt 102595-02-M-1540</p>	

7008 1830 0000 0238 4895

U.S. Postal Service  
**CERTIFIED MAIL RECEIPT**  
(Domestic Mail Only; No Insurance Coverage Provided)

For delivery information visit our website at [www.usps.com](http://www.usps.com).

**OFFICIAL USE**

Postage	\$ .49	
Certified Fee	3.30	
Return Receipt Fee (Endorsement Required)	2.70	
Restricted Delivery Fee (Endorsement Required)		
Total Postage & Fees	\$ 6.49	

Sent To  
 Street, Apt or PO Box  
 City, State  
 PS Form

KATHY BUSH [14-668]  
 20 UPTON RD  
 CENTURY, FL 32535

7008 1830 0000 0238 4901

U.S. Postal Service  
**CERTIFIED MAIL RECEIPT**  
(Domestic Mail Only; No Insurance Coverage Provided)

For delivery information visit our website at [www.usps.com](http://www.usps.com).

**OFFICIAL USE**

Postage	\$ .49	
Certified Fee	3.30	
Return Receipt Fee (Endorsement Required)	2.70	
Restricted Delivery Fee (Endorsement Required)		
Total Postage & Fees	\$ 6.49	

Sent To  
 Street, Apt or PO Box  
 City, State  
 PS Form

DOROTHY SIMS AKA DOROTHY L SIMS AKA DOROTHY CROLEY SIMS  
 [14-668]  
 271 COX RD  
 MCDAVID FL 32568

7008 1830 0000 0238 4871

U.S. Postal Service  
**CERTIFIED MAIL RECEIPT**  
(Domestic Mail Only; No Insurance Coverage Provided)

For delivery information visit our website at [www.usps.com](http://www.usps.com).

**OFFICIAL USE**

Postage	\$ .49	
Certified Fee	3.30	
Return Receipt Fee (Endorsement Required)	2.70	
Restricted Delivery Fee (Endorsement Required)		
Total Postage & Fees	\$ 6.49	

Sent To  
 Street, Apt or PO Box  
 City, State  
 PS Form

MILDRED CROLEY [14-668]  
 20 UPTON RD  
 CENTURY, FL 32535

7008 1830 0000 0238 4888

U.S. Postal Service  
**CERTIFIED MAIL RECEIPT**  
(Domestic Mail Only; No Insurance Coverage Provided)

For delivery information visit our website at [www.usps.com](http://www.usps.com).

**OFFICIAL USE**

Postage	\$ .49	
Certified Fee	3.30	
Return Receipt Fee (Endorsement Required)	2.70	
Restricted Delivery Fee (Endorsement Required)		
Total Postage & Fees	\$ 6.49	

Sent To  
 Street, Apt or PO Box  
 City, State  
 PS Form

DOROTHY SIMS [14-668]  
 20 UPTON RD  
 CENTURY, FL 32535

Century

ESCAMBIA COUNTY SHERIFF'S OFFICE  
ESCAMBIA COUNTY, FLORIDA

14-668

**NON-ENFORCEABLE RETURN OF SERVICE**

**Document Number:** ECSO14CIV039879NON  
**Court:** TAX DEED  
**County:** ESCAMBIA  
**Case Number:** CERT NO 07962 2012

**Agency Number:** 14-011947

**Attorney/Agent:**  
PAM CHILDERS  
CLERK OF COURT  
TAX DEED

**Plaintiff:** RE: MILDRED CROLEY AND DOROTHY SIMS AND KATHY BUSH  
**Defendant:**

**Type of Process:** WARNING/NOTICE OF APPLICATION FOR TAX DEED

Received this Writ on 9/4/2014 at 3:01 PM and served same at 3:00 PM on 9/9/2014 in ESCAMBIA COUNTY, FLORIDA, by serving POST PROPERTY , the within named, to wit: , .

POSTED TO PROPERTY PER INSTRUCTIONS FROM CLERK'S OFFICE.

DAVID MORGAN, SHERIFF  
ESCAMBIA COUNTY, FLORIDA

By:  292  
\_\_\_\_\_

KICHLER, P DEPUTY

Service Fee: \$40.00  
Receipt No: BILL

**WARNING**

**THERE ARE UNPAID TAXES ON PROPERTY WHICH YOU OWN OR IN WHICH YOU HAVE A LEGAL INTEREST. THE PROPERTY WILL BE SOLD AT PUBLIC AUCTION ON October 6, 2014, UNLESS THE TAXES ARE PAID. SHOULD YOU NEED FURTHER INFORMATION CONTACT THE CLERK OF THE CIRCUIT COURT IMMEDIATELY AT THE COUNTY COURTHOUSE IN PENSACOLA, FLORIDA, OR CALL 850-595-3793.**

**NOTICE OF APPLICATION FOR TAX DEED**

NOTICE IS HEREBY GIVEN, That **PPF HOLDINGS III LTD** holder of **Tax Certificate No. 07962**, issued the **1st day of June, A.D., 2012** has filed same in my office and has made application for a tax deed to be issued thereon. Said certificate embraces the following described property in the County of Escambia, State of Florida, to wit:

**BEG SE COR OF NW 1/4 OF SE 1/4 W 447 FT N 60 DEG W TO E R/W LI OF HWY 29 NLY ALG R/W LI 567 FT 84 DEG 28 MIN RT 195 FT FOR POB CONT SAME COURSE 75 FT 90 DEG LEFT 115 FT 90 DEG LEFT 75 FT 90 DEG LEFT 115 FT TO POB OR 6573 P 1012**

**SECTION 07, TOWNSHIP 5 N, RANGE 30 W**

**TAX ACCOUNT NUMBER 111763010 (14-668)**

The assessment of the said property under the said certificate issued was in the name of

**MILDRED CROLEY and DOROTHY SIMS and KATHY BUSH**

Unless said certificate shall be redeemed according to law, the property described therein will be sold to the highest bidder at public auction at 9:00 A.M. on the first Monday in the month of October, which is the 6th day of October 2014.

Dated this 4th day of September 2014.

In accordance with the AMERICANS WITH DISABILITIES ACT, if you are a person with a disability who needs special accommodation in order to participate in this proceeding you are entitled to the provision of certain assistance. Please contact Emily Hogg not later than seven days prior to the proceeding at Escambia County Government Complex, 221 Palafox Place Ste 110, Pensacola FL 32502. Telephone: 850-595-3793.

**Post Property:**

20 UPTON RD 32535



**PAM CHILDERS  
CLERK OF THE CIRCUIT COURT  
ESCAMBIA COUNTY, FLORIDA**

By:  
Emily Hogg  
Deputy Clerk

RECEIVED  
SEP 11 2 3:01 PM

Century

ESCAMBIA COUNTY SHERIFF'S OFFICE  
ESCAMBIA COUNTY, FLORIDA

14-668

**NON-ENFORCEABLE RETURN OF SERVICE**

**Document Number:** ECSO14CIV039870NON

**Agency Number:** 14-011945

**Court:** TAX DEED

**County:** ESCAMBIA

**Case Number:** CERT NO 07962 2012

**Attorney/Agent:**

PAM CHILDERS  
CLERK OF COURT  
TAX DEED

**Plaintiff:** RE: MILDRED CROLEY AND DOROTHY SIMS AND KATHY BUSH

**Defendant:**

**Type of Process:** WARNING/NOTICE OF APPLICATION FOR TAX DEED

Substitute

Received this Writ on 9/4/2014 at 2:57 PM and served same on MILDRED CROLEY , in ESCAMBIA COUNTY, FLORIDA, at 3:00 PM on 9/9/2014 by leaving a true copy of this Writ together with a copy of the initial pleadings, if any, with the date and hour of service endorsed thereon by me, at the within named individual's usual place of abode, with a person residing therein who is 15 years of age, or older, to wit: KELLY SIMS, RESIDENT, as a member of the household and informing said person of their contents.

DAVID MORGAN, SHERIFF  
ESCAMBIA COUNTY, FLORIDA

By:  292  
KICHLER, P DEPUTY

Service Fee: \$40.00  
Receipt No: BILL

Printed By: JLBRYANT



WARNING

THERE ARE UNPAID TAXES ON PROPERTY WHICH YOU OWN OR IN WHICH YOU HAVE A LEGAL INTEREST. THE PROPERTY WILL BE SOLD AT PUBLIC AUCTION ON October 6, 2014, UNLESS THE TAXES ARE PAID. SHOULD YOU NEED FURTHER INFORMATION CONTACT THE CLERK OF THE CIRCUIT COURT IMMEDIATELY AT THE COUNTY COURTHOUSE IN PENSACOLA, FLORIDA, OR CALL 850-595-3793.

NOTICE OF APPLICATION FOR TAX DEED

NOTICE IS HEREBY GIVEN, That PPF HOLDINGS III LTD holder of Tax Certificate No. 07962, issued the 1st day of June, A.D., 2012 has filed same in my office and has made application for a tax deed to be issued thereon. Said certificate embraces the following described property in the County of Escambia, State of Florida, to wit:

BEG SE COR OF NW 1/4 OF SE 1/4 W 447 FT N 60 DEG W TO E R/W LI OF HWY 29 NLY ALG R/W LI 567 FT 84 DEG 28 MIN RT 195 FT FOR POB CONT SAME COURSE 75 FT 90 DEG LEFT 115 FT 90 DEG LEFT 75 FT 90 DEG LEFT 115 FT TO POB OR 6573 P 1012

SECTION 07, TOWNSHIP 5 N, RANGE 30 W

TAX ACCOUNT NUMBER 111763010 (14-668)

The assessment of the said property under the said certificate issued was in the name of

MILDRED CROLEY and DOROTHY SIMS and KATHY BUSH

Unless said certificate shall be redeemed according to law, the property described therein will be sold to the highest bidder at public auction at 9:00 A.M. on the first Monday in the month of October, which is the 6th day of October 2014.

Dated this 4th day of September 2014.

In accordance with the AMERICANS WITH DISABILITIES ACT, if you are a person with a disability who needs special accommodation in order to participate in this proceeding you are entitled to the provision of certain assistance. Please contact Emily Hogg not later than seven days prior to the proceeding at Escambia County Government Complex, 221 Palafox Place Ste 110, Pensacola FL 32502. Telephone: 850-595-3793.

Personal Services:

MILDRED CROLEY  
20 UPTON RD  
CENTURY, FL 32535

PAM CHILDERS  
CLERK OF THE CIRCUIT COURT  
ESCAMBIA COUNTY, FLORIDA



By:  
Emily Hogg  
Deputy Clerk

2014 SEP 11 2 21 PM  
RECEIVED