



CERTIFICATION OF TAX DEED APPLICATION

Sections 197.502 and 197.542, Florida Statutes

DR-513
Rule 12D-16.002 F.A.C
Effective 07/19
Page 1 of 2

0424-31

Part 1: Tax Deed Application Information

Applicant Name Applicant Address	RYAN VIGNEAU 4747 MARINA DR APT 12 CARLSBAD, CA 92008	Application date	Oct 24, 2023
Property description	MARKHAM VAUGHN T & MARKHAM SUE S 7666 OLD HICKORY DR PENSACOLA, FL 32507 1100 BLK S FAIRFIELD DR 09-4545-285 BEG AT NE COR OF LT 7 S 1 DEG 58 MIN 50 SEC W ALG E LI OF SEC 682 78/100 FT FOR POB SWLY ALG CENTER (Full legal attached.)	Certificate #	2021 / 4162
		Date certificate issued	06/01/2021

Part 2: Certificates Owned by Applicant and Filed with Tax Deed Application

Column 1 Certificate Number	Column 2 Date of Certificate Sale	Column 3 Face Amount of Certificate	Column 4 Interest	Column 5: Total (Column 3 + Column 4)
# 2021/4162	06/01/2021	63.86	23.95	87.81
→Part 2: Total*				87.81

Part 3: Other Certificates Redeemed by Applicant (Other than County)

Column 1 Certificate Number	Column 2 Date of Other Certificate Sale	Column 3 Face Amount of Other Certificate	Column 4 Tax Collector's Fee	Column 5 Interest	Total (Column 3 + Column 4 + Column 5)
# 2023/4581	06/01/2023	65.60	6.25	4.92	76.77
# 2022/4472	06/01/2022	53.71	6.25	13.70	73.66
# 2020/5236	06/01/2020	86.47	6.25	11.67	104.39
# 2019/4896	06/01/2019	101.22	6.25	5.06	112.53
# 2018/5095	06/01/2018	53.96	6.25	52.61	112.82
# 2017/5074	06/01/2017	54.10	6.25	62.49	122.84
Part 3: Total*					603.01

Part 4: Tax Collector Certified Amounts (Lines 1-7)

1. Cost of all certificates in applicant's possession and other certificates redeemed by applicant (*Total of Parts 2 + 3 above)	690.82
2. Delinquent taxes paid by the applicant	0.00
3. Current taxes paid by the applicant	0.00
4. Property information report fee	200.00
5. Tax deed application fee	175.00
6. Interest accrued by tax collector under s.197.542, F.S. (see Tax Collector Instructions, page 2)	0.00
7. Total Paid (Lines 1-6)	1,065.82

I certify the above information is true and the tax certificates, interest, property information report fee, and tax collector's fees have been paid, and that the property information statement is attached.

Sign here: Escambia, Florida
 Date October 31st, 2023
 Signature, Tax Collector or Designee

Send this certification to the Clerk of Court by 10 days after the date signed. See Instructions on Page 2

Part 5: Clerk of Court Certified Amounts (Lines 8-14)	
8. Processing tax deed fee	
9. Certified or registered mail charge	
10. Clerk of Court advertising, notice for newspaper, and electronic auction fees	
11. Recording fee for certificate of notice	
12. Sheriff's fees	
13. Interest (see Clerk of Court Instructions, page 2)	
14. Total Paid (Lines 8-13)	
15. Plus one-half of the assessed value of homestead property, if applicable under s. 197.502(6)(c), F.S.	
16. Statutory opening bid (total of Lines 7, 14, 15, and 16 if applicable)	
Sign here: _____ Date of sale <u>04/03/2024</u> Signature, Clerk of Court or Designee	

INSTRUCTIONS + 6.25

Tax Collector (complete Parts 1-4)

Part 2: Certificates Owned by Applicant and Filed with Tax Deed Application

Enter the Face Amount of Certificate in Column 3 and the Interest in Column 4 for each certificate number. Add Columns 3 and 4 and enter the amount in Column 5.

Part 3: Other Certificates Redeemed by Applicant (Other than County)

Total. Add the amounts in Columns 3, 4 and 5

Part 4: Tax Collector Certified Amounts (Lines 1-7)

Line 1, enter the total of Part 2 plus the total of Part 3 above.

Total Paid, Line 7: Add the amounts of Lines 1-6

Line 6, Interest accrued by tax collector. Calculate the 1.5 percent interest accrued from the month after the date of application through the month this form is certified to the clerk. Enter the amount to be certified to the clerk on **Line 6**. The interest calculated by the tax collector stops before the interest calculated by the clerk begins. See Section 197.542, F.S., and Rule 12D-13.060(3), Florida Administrative Code.

The tax collector's interest for redemption at the time of the tax deed application is a cost of redemption, which encompasses various percentages of interest on certificates and omitted or delinquent taxes under Section 197.502, F.S. This interest is calculated before the tax collector calculates the interest in Section 197.542, F.S.

Attach certified statement of names and addresses of persons who must be notified before the sale of the property. Send this form and any required attachments to the Clerk of Court within 10 days after it is signed.

Clerk of Court (complete Part 5)

Line 13: Interest is calculated at the rate of 1.5 percent per month starting from the first day of the month after the month of certification of this form through the last day of the month in which the sale will be held. Multiply the calculated rate by the total of **Line 7**, minus **Line 6**, plus **Lines 8 through 12**. Enter the amount on **Line 13**.

Line 14: Enter the total of Lines 8-13. Complete Lines 15-18, if applicable.

BEG AT NE COR OF LT 7 S 1 DEG 58 MIN 50 SEC W ALG E LI OF SEC 682 78/100 FT FOR POB SWLY ALG CENTER LI OF BAYOU CHICO CREEK THE FOLLOWING 4 COURSES & DIST S 70 DEG 39 MIN 0 SEC W 987 39/100 FT S 73 DEG 18 MIN 0 SEC W 700 FT S 42 DEG 58 MIN 0 SEC W 285 FT S 33 DEG 37 MIN 0 SEC W 744 65/100 FT TO NELY RW LI OF S R 289-A WHICH PT LIES ON ARC OF CIRCULAR CURVE CONCAVE SWLY RADIUS 1196 28/100 FT TANGENT BEARS S 42 DEG 19 MIN 05 SEC E SELY ALG SD RW AND CURVE THRU CENTRAL ANG 6 DEG 20 MIN 36 SEC ARC DIST 132 44/100 FT TO NW COR OF LT 1 BLK 2 FAIRFIELD EAST UNIT 1 ELY ALG NLY BOUNDARY OF SD S/D THE FOLLOWING COURSES AND DIST N 60 DEG 15 MIN 50 SEC E 242 32/100 FT N 57 DEG 22 MIN 30 SEC E 37 30/100 FT N 52 DEG 36 MIN 30 SEC E 62 22/100 FT N 7 DEG 59 MIN 10 SEC W 20 FT N 52 DEG 59 MIN 10 SEC W 45 86/100 FT THENCE RT ALG CIRCULAR CURVE CONCAVE SELY RADIUS 150 FT CENTRAL ANG 180 DEG 0 MIN 0 SEC ARC DIST 471 24/100 FT S 52 DEG 59 MIN 10 SEC E 60 FT N 65 DEG 49 MIN 32 SEC E 22 17/100 FT THENCE ALG CIRCULAR CURVE CONCAVE SELY RADIUS 280 FT CENTRAL ANG 23 DEG 0 MIN 06 SEC ARC DIST 112 41/100 FT N 75 DEG 53 MIN 56 SEC E 83 16/100 FT N 30 DEG 53 MIN 56 SEC E 20 FT N 14 DEG 06 MIN 04 SEC W 45 86/100 FT THENCE TO RT ALG CURVE CONCAVE SE RADIUS 150 FT CENTRAL ANG 180 FT 0 MIN 0 SEC ARC DIST 471 24/100 FT S 14 DEG 06 MIN 04 SEC E 45 86/100 FT S 59 DEG 06 MIN 04 SEC E 20 FT N 75 DEG 53

MIN 56 SEC E 48 03/100 FT THENCE RT ALG CIRCULAR CURVE CONCAVE SELY RADIUS 1130 FT CENTRAL ANG 6 DEG 32
MIN 0 SEC ARC DIST 128 85/100 FT N 59 DEG 34 MIN 08 SEC E 25 99/100 FT N 4 DEG 56 MIN 32 SEC W 230 FT N 15 DEG 19
MIN 54 SEC W 97 26/100 FT THENCE RT ALG CIRCULAR CURVE CONCAVE SELY RADIUS 150 FT CENTRAL ANG 87 DEG
09 MIN 54 SEC ARC DIST 228 20/100 FT N 71 DEG 50 MIN 0 SEC E 479 43/100 FT S 37 DEG 57 MIN 16 SEC E 312 14/100 FT
TO NWLY RADIUS 170 FT TANGENT BEARS N 41 DEG 53 MIN 03 SEC E NELY ALG SD R/W AND CURVE THRU CENTRAL
ANG 8 DEG 33 MIN 14 SEC ARC DIST 25 38/100 FT S 56 DEG 40 MIN 21 SEC E 197 69/100 FT N 64 DEG 53 MIN 50 SEC E 34
80/100 FT TO E LI OF SEC 21 N 1 DEG 58 MIN 50 SEC E ALG E LI OF SEC 489 97/100 FT TO POB OR 6410 P 919 SEC 21/15 T
2S R 31 LESS OR 4509 P 1125 ESCAMBIA COUNTY FLORIDA LESS OR 5134 P 1945 MARCHAM

APPLICATION FOR TAX DEED

Section 197.502, Florida Statutes

512
R. 12/16

Application Number: 2300607

To: Tax Collector of ESCAMBA COUNTY, Florida

I,

RYAN VIGNEAU
4747 MARINA DR APT 12
CARLSBAD, CA 92008,

hold the listed tax certificate and hereby surrender the same to the Tax Collector and make tax deed application thereon:

Account Number	Certificate No.	Date	Legal Description
09-4545-285	2021/4162	06-01-2021	BEG AT NE COR OF LT 7 S 1 DEG 58 MIN 50 SEC W ALG E LI OF SEC 682 78/100 FT FOR POB SWLY ALG CENTER LI OF BAYOU CHICO CREEK THE FOLLOWING 4 COURSES & DIST S 70 DEG 39 MIN 0 SEC W 987 39/100 FT S 73 DEG 18 MIN 0 SEC W 700 FT S 42 DEG 58 MIN 0 SEC W 285 FT S 33 DEG 37 MIN 0 SEC W 744 65/100 FT TO NELY R/W LI OF S R 289-A WHICH PT LIES ON ARC OF CIRCULAR CURVE CONCAVE SWLY RADIUS 1196 28/100 FT TANGENT BEARS S 42 DEG 19 MIN 05 SEC E SELY ALG SD R/W AND CURVE THRU CENTRAL ANG 6 DEG 20 MIN 36 SEC ARC DIST 132 44/100 FT TO NW COR OF LT 1 BLK 2 FAIRFIELD EAST UNIT 1 ELY ALG NLY BOUNDARY OF SD S/D THE FOLLOWING COURSES AND DIST N 60 DEG 15 MIN 50 SEC E 242 32/100 FT N 57 DEG 22 MIN 30 SEC E 37 30/100 FT N 52 DEG 36 MIN 30 SEC E 62 22/100 FT N 7 DEG 59 MIN 10 SEC W 20 FT N 52 DEG 59 MIN 10 SEC W 45 86/100 FT THENCE RT ALG CIRCULAR CURVE CONCAVE SELY RADIUS 150 FT CENTRAL ANG 180 DEG 0 MIN 0 SEC ARC DIST 471 24/100 FT S 52 DEG 59 MIN 10 SEC E 60 FT N 65 DEG 49 MIN 32 SEC E 22 17/100 FT THENCE ALG CIRCULAR CURVE CONCAVE SELY RADIUS 280 FT CENTRAL ANG 23 DEG 0 MIN 06 SEC ARC DIST 112 41/100 FT N 75 DEG 53 MIN 56 SEC E 83 16/100 FT N 30 DEG 53 MIN 56 SEC E 20 FT N 14 DEG 06 MIN 04 SEC W 45 86/100 FT THENCE TO RT ALG CURVE CONCAVE SE RADIUS 150 FT CENTRAL ANG 180 FT 0 MIN 0 SEC ARC DIST 471 24/100 FT S 14 DEG 06 MIN 04 SEC E 45 86/100 FT S 59 DEG 06 MIN 04 SEC E 20 FT N 75 DEG 53 MIN 56 SEC E 48 03/100 FT THENCE RT ALG CIRCULAR CURVE CONCAVE SELY RADIUS 1130 FT CENTRAL ANG 6 DEG 32 MIN 0 SEC ARC DIST 128 85/100 FT N 59 DEG 34 MIN 08 SEC E 25 99/100 FT N 4

		DEG 56 MIN 32 SEC W 230 FT N 15 DEG 19 MIN 54 SEC W 97 26/100 FT THENCE RT ALG CIRCULAR CURVE CONCAVE SELY RADIUS 150 FT CENTRAL ANG 87 DEG 09 MIN 54 SEC ARC DIST 228 20/100 FT N 71 DEG 50 MIN 0 SEC E 479 43/100 FT S 37 DEG 57 MIN 16 SEC E 312 14/100 FT TO NWLY RADIUS 170 FT TANGENT BEARS N 41 DEG 53 MIN 03 SEC E NELY ALG SD R/W AND CURVE THRU CENTRAL ANG 8 DEG 33 MIN 14 SEC ARC DIST 25 38/100 FT S 56 DEG 40 MIN 21 SEC E 197 69/100 FT N 64 DEG 53 MIN 50 SEC E 34 80/100 FT TO E LI OF SEC 21 N 1 DEG 58 MIN 50 SEC E ALG E LI OF SEC 489 97/100 FT TO POB OR 6410 P 919 SEC 21/15 T 2S R 31 LESS OR 4509 P 1125 ESCAMBIA COUNTY FLORIDA LESS OR 5134 P 1945 MARCHAM
--	--	--

I agree to:

- pay any current taxes, if due and
- redeem all outstanding tax certificates plus interest not in my possession, and
- pay all delinquent and omitted taxes, plus interest covering the property.
- pay all Tax Collector's fees, property information report costs, Clerk of the Court costs, charges and fees, and Sheriff's costs, if applicable.

Attached is the tax sale certificate on which this application is based and all other certificates of the same legal description which are in my possession.

Electronic signature on file
 RYAN VIGNEAU
 4747 MARINA DR APT 12
 CARLSBAD, CA 92008

10-24-2023
 Application Date

 Applicant's signature



Chris Jones Escambia County Property Appraiser

Real Estate Search

Tangible Property Search

Sale List

[Back](#)

◀ Nav. Mode ☒ Account ☐ Parcel ID ▶

[Printer Friendly Version](#)

General Information Parcel ID: 212S316101003001 Account: 094545285 Owners: MARKHAM VAUGHN T & MARKHAM SUE S Mail: 7666 OLD HICKORY DR PENSACOLA, FL 32507 Situs: 1100 BLK S FAIRFIELD DR 32507 Use Code: VACANT RESIDENTIAL Taxing Authority: COUNTY MSTU Tax Inquiry: Open Tax Inquiry Window Tax Inquiry link courtesy of Scott Lunsford Escambia County Tax Collector		Assessments <table border="1"> <thead> <tr> <th>Year</th> <th>Land</th> <th>Imprv</th> <th>Total</th> <th>Cap Val</th> </tr> </thead> <tbody> <tr> <td>2023</td> <td>\$475</td> <td>\$0</td> <td>\$475</td> <td>\$475</td> </tr> <tr> <td>2022</td> <td>\$475</td> <td>\$0</td> <td>\$475</td> <td>\$475</td> </tr> <tr> <td>2021</td> <td>\$475</td> <td>\$0</td> <td>\$475</td> <td>\$475</td> </tr> </tbody> </table> Disclaimer Tax Estimator File for New Homestead Exemption Online Report Storm Damage		Year	Land	Imprv	Total	Cap Val	2023	\$475	\$0	\$475	\$475	2022	\$475	\$0	\$475	\$475	2021	\$475	\$0	\$475	\$475										
Year	Land	Imprv	Total	Cap Val																													
2023	\$475	\$0	\$475	\$475																													
2022	\$475	\$0	\$475	\$475																													
2021	\$475	\$0	\$475	\$475																													
Sales Data <table border="1"> <thead> <tr> <th>Sale Date</th> <th>Book</th> <th>Page</th> <th>Value</th> <th>Type</th> <th>Official Records (New Window)</th> </tr> </thead> <tbody> <tr> <td>10/18/2008</td> <td>6410</td> <td>919</td> <td>\$100</td> <td>QC</td> <td></td> </tr> <tr> <td>04/1998</td> <td>4254</td> <td>1930</td> <td>\$100</td> <td>WD</td> <td></td> </tr> <tr> <td>05/1987</td> <td>2409</td> <td>607</td> <td>\$11,000</td> <td>WD</td> <td></td> </tr> <tr> <td>02/1979</td> <td>1305</td> <td>732</td> <td>\$50,000</td> <td>OT</td> <td></td> </tr> </tbody> </table> Official Records Inquiry courtesy of Pam Childers Escambia County Clerk of the Circuit Court and Comptroller		Sale Date	Book	Page	Value	Type	Official Records (New Window)	10/18/2008	6410	919	\$100	QC		04/1998	4254	1930	\$100	WD		05/1987	2409	607	\$11,000	WD		02/1979	1305	732	\$50,000	OT		2023 Certified Roll Exemptions None Legal Description BEG AT NE COR OF LT 7 S 1 DEG 58 MIN 50 SEC W ALG E LI OF SEC 682 78/100 FT FOR POB SWLY ALG CENTER LI OF BAYOU... Extra Features None	
Sale Date	Book	Page	Value	Type	Official Records (New Window)																												
10/18/2008	6410	919	\$100	QC																													
04/1998	4254	1930	\$100	WD																													
05/1987	2409	607	\$11,000	WD																													
02/1979	1305	732	\$50,000	OT																													

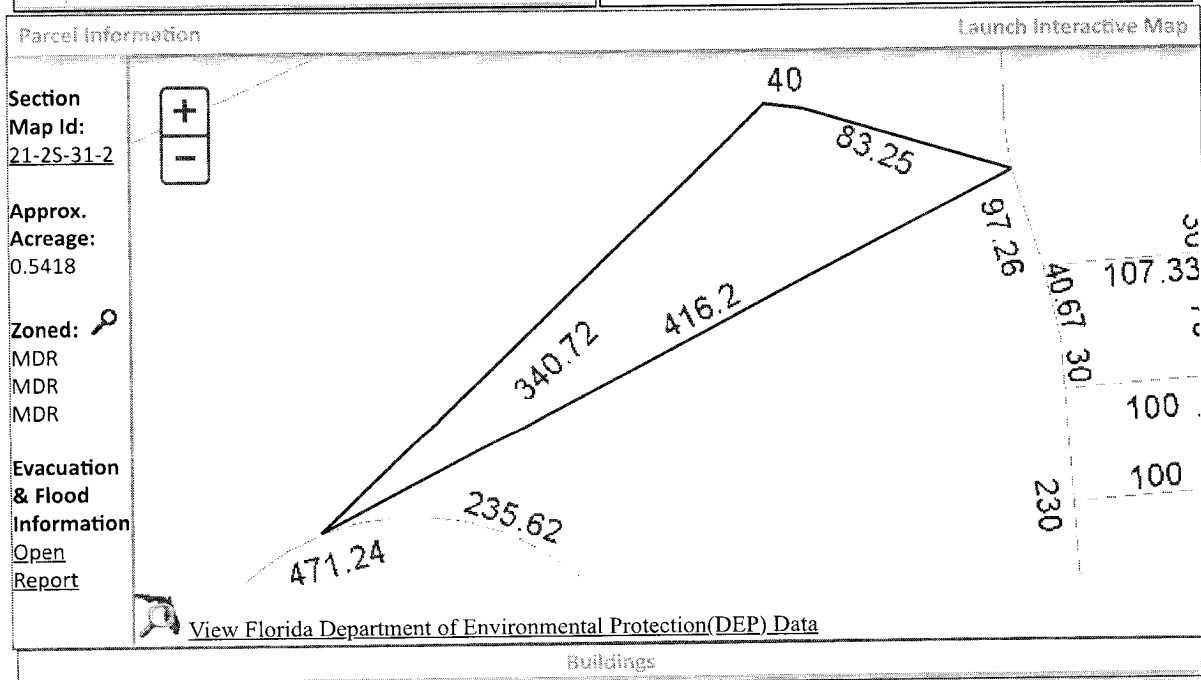

Images

None

The primary use of the assessment data is for the preparation of the current year tax roll. No responsibility or liability is assumed for inaccuracies or errors.

Last Updated: 11/01/2023 (tc.6650)

NOTICE OF APPLICATION FOR TAX DEED

NOTICE IS HEREBY GIVEN, That **RYAN VIGNEAU** holder of **Tax Certificate No. 04162**, issued the 1st day of **June, A.D., 2021** has filed same in my office and has made application for a tax deed to be issued thereon. Said certificate embraces the following described property in the County of Escambia, State of Florida, to wit:

(see attached)

SECTION 21, TOWNSHIP 2 S, RANGE 31 W

TAX ACCOUNT NUMBER 094545285 (0424-31)

The assessment of the said property under the said certificate issued was in the name of

VAUGHN T MARKHAM and SUE S MARKHAM

Unless said certificate shall be redeemed according to law, the property described therein will be sold to the highest bidder at public auction at 9:00 A.M. on the **first** Wednesday in the month of April, which is the **3rd** day of April 2024.

Dated this 1st day of November 2023.

In accordance with the AMERICANS WITH DISABILITIES ACT, if you are a person with a disability who needs special accommodation in order to participate in this proceeding you are entitled to the provision of certain assistance. Please contact Emily Hogg not later than seven days prior to the proceeding at Escambia County Government Complex, 221 Palafox Place Ste 110, Pensacola FL 32502. Telephone: 850-595-3793.

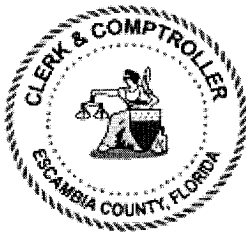

PAM CHILDERS
CLERK OF THE CIRCUIT COURT
ESCAMBIA COUNTY, FLORIDA

By:
Emily Hogg
Deputy Clerk

LEGAL DESCRIPTION

BEG AT NE COR OF LT 7 S 1 DEG 58 MIN 50 SEC W ALG E LI OF SEC 682 78/100 FT FOR POB SWLY ALG CENTER LI OF BAYOU CHICO CREEK THE FOLLOWING 4 COURSES & DIST S 70 DEG 39 MIN 0 SEC W 987 39/100 FT S 73 DEG 18 MIN 0 SEC W 700 FT S 42 DEG 58 MIN 0 SEC W 285 FT S 33 DEG 37 MIN 0 SEC W 744 65/100 FT TO NELY R/W LI OF S R 289-A WHICH PT LIES ON ARC OF CIRCULAR CURVE CONCAVE SWLY RADIUS 1196 28/100 FT TANGENT BEARS S 42 DEG 19 MIN 05 SEC E SELY ALG SD R/W AND CURVE THRU CENTRAL ANG 6 DEG 20 MIN 36 SEC ARC DIST 132 44/100 FT TO NW COR OF LT 1 BLK 2 FAIRFIELD EAST UNIT 1 ELY ALG NLY BOUNDARY OF SD S/D THE FOLLOWING COURSES AND DIST N 60 DEG 15 MIN 50 SEC E 242 32/100 FT N 57 DEG 22 MIN 30 SEC E 37 30/100 FT N 52 DEG 36 MIN 30 SEC E 62 22/100 FT N 7 DEG 59 MIN 10 SEC W 20 FT N 52 DEG 59 MIN 10 SEC W 45 86/100 FT THENCE RT ALG CIRCULAR CURVE CONCAVE SELY RADIUS 150 FT CENTRAL ANG 180 DEG 0 MIN 0 SEC ARC DIST 471 24/100 FT S 52 DEG 59 MIN 10 SEC E 60 FT N 65 DEG 49 MIN 32 SEC E 22 17/100 FT THENCE ALG CIRCULAR CURVE CONCAVE SELY RADIUS 280 FT CENTRAL ANG 23 DEG 0 MIN 06 SEC ARC DIST 112 41/100 FT N 75 DEG 53 MIN 56 SEC E 83 16/100 FT N 30 DEG 53 MIN 56 SEC E 20 FT N 14 DEG 06 MIN 04 SEC W 45 86/100 FT THENCE TO RT ALG CURVE CONCAVE SE RADIUS 150 FT CENTRAL ANG 180 FT 0 MIN 0 SEC ARC DIST 471 24/100 FT S 14 DEG 06 MIN 04 SEC E 45 86/100 FT S 59 DEG 06 MIN 04 SEC E 20 FT N 75 DEG 53 MIN 56 SEC E 48 03/100 FT THENCE RT ALG CIRCULAR CURVE CONCAVE SELY RADIUS 1130 FT CENTRAL ANG 6 DEG 32 MIN 0 SEC ARC DIST 128 85/100 FT N 59 DEG 34 MIN 08 SEC E 25 99/100 FT N 4 DEG 56 MIN 32 SEC W 230 FT N 15 DEG 19 MIN 54 SEC W 97 26/100 FT THENCE RT ALG CIRCULAR CURVE CONCAVE SELY RADIUS 150 FT CENTRAL ANG 87 DEG 09 MIN 54 SEC ARC DIST 228 20/100 FT N 71 DEG 50 MIN 0 SEC E 479 43/100 FT S 37 DEG 57 MIN 16 SEC E 312 14/100 FT TO NWLY RADIUS 170 FT TANGENT BEARS N 41 DEG 53 MIN 03 SEC E NELY ALG SD R/W AND CURVE THRU CENTRAL ANG 8 DEG 33 MIN 14 SEC ARC DIST 25 38/100 FT S 56 DEG 40 MIN 21 SEC E 197 69/100 FT N 64 DEG 53 MIN 50 SEC E 34 80/100 FT TO E LI OF SEC 21 N 1 DEG 58 MIN 50 SEC E ALG E LI OF SEC 489 97/100 FT TO POB OR 6410 P 919 SEC 21/15 T 2S R 31 LESS OR 4509 P 1125 ESCAMBIA COUNTY FLORIDA LESS OR 5134 P 1945 MARCHAM



PROPERTY INFORMATION REPORT
3050 Concho Drive, Pensacola, Florida 32507 | Phone: 850-466-3077

THE ATTACHED REPORT IS ISSUED TO:

SCOTT LUNSFORD, ESCAMBIA COUNTY TAX COLLECTOR

TAX ACCOUNT #: 09-4545-285 CERTIFICATE #: 2021-4162

THIS REPORT IS NOT TITLE INSURANCE. THE LIABILITY FOR ERRORS OR OMISSIONS IN THIS REPORT IS LIMITED TO THE PERSON(S) EXPRESSLY IDENTIFIED BY NAME IN THE PROPERTY INFORMATION REPORT AS THE RECIPIENT(S) OF THE PROPERTY INFORMATION REPORT.

The attached Report prepared in accordance with the instructions given by the user named above includes a listing of the owner(s) of record of the land described herein together with current and delinquent ad valorem tax information and a listing and copies of all open or unsatisfied leases, mortgages, judgments and encumbrances recorded in the Official Record Books of Escambia County, Florida that appear to encumber the title to said land as listed on page 2 herein. It is the responsibility of the party named above to verify receipt of each document listed. If a copy of any document listed is not received, the office issuing this Report must be contacted immediately.

This Report is subject to: Current year taxes; taxes and assessments due now or in subsequent years; oil, gas, and mineral or any subsurface rights of any kind or nature; easements, restrictions and covenants of record; encroachments, overlaps, boundary line disputes, and any other matters that would be disclosed by an accurate survey and inspection of the premises.

This Report does not insure or guarantee the validity or sufficiency of any document attached, nor is it to be considered a title insurance policy, an opinion of title, a guarantee of title, or as any other form of guarantee or warranty of title.

Use of the term "Report" herein refers to the Property Information Report and the documents attached hereto.

Period Searched: January 11, 2004 to and including January 11, 2024 Abstractor: Cody Campbell

BY

Michael A. Campbell,
As President
Dated: January 19, 2024

PROPERTY INFORMATION REPORT
CONTINUATION PAGE

January 19, 2024

Tax Account #: **09-4545-285**

1. The Grantee(s) of the last deed(s) of record is/are: **VAUGHN T. MARKHAM AND SUE S. MARKHAM**

By Virtue of Quit Claim Deed recorded 12/30/2008 in OR 6410/919

2. The land covered by this Report is: **See Attached Exhibit "A"**
3. The following unsatisfied mortgages, liens, and judgments affecting the land covered by this Report appear of record:

NONE

4. Taxes:

Taxes for the year(s) 2016 - 2022 are delinquent.

Tax Account #: 09-4545-285

Assessed Value: \$475

Exemptions: NONE OR LIST IN ALL CAPS

5. We find the following HOA names in our search (if a condominium, the condo docs book and page are included for your review): **NONE**

Payment of any special liens/assessments imposed by City, County, and/or State.

Note: Escambia County and/or local municipalities may impose special liens/assessments. These liens/assessments are not discovered in a title search or shown above. These special assessments typically create a lien on real property. The entity that governs subject property must be contacted to verify payment status.

PERDIDO TITLE & ABSTRACT, INC.
PROPERTY INFORMATION REPORT
3050 Concho Drive, Pensacola, Florida 32507 | Phone 850-466-3077

Scott Lunsford
Escambia County Tax Collector
P.O. Box 1312
Pensacola, FL 32591

CERTIFICATION: TITLE SEARCH FOR TDA

TAX DEED SALE DATE: APR 3, 2024

TAX ACCOUNT #: 09-4545-285

CERTIFICATE #: 2021-4162

In compliance with Section 197.522, Florida Statutes, the following is a list of names and addresses of those persons, firms, and/or agencies having legal interest in or claim against the above-described property. The above-referenced tax sale certificate is being submitted as proper notification of tax deed sale.

YES	NO	
<input type="checkbox"/>	<input checked="" type="checkbox"/>	Notify City of Pensacola, P.O. Box 12910, 32521
<input type="checkbox"/>	<input checked="" type="checkbox"/>	Notify Escambia County, 190 Governmental Center, 32502
<input type="checkbox"/>	<input checked="" type="checkbox"/>	Homestead for <u>2023</u> tax year.

VAUGHN T. MARKHAM
AND SUE S. MARKHAM
7666 OLD HICKORY DR
PENSACOLA, FL 32507

Certified and delivered to Escambia County Tax Collector, this 19th day of January, 2024

PERDIDO TITLE & ABSTRACT, INC.



BY: Michael A. Campbell, As It's President

NOTE: The above listed addresses are based upon current information available, but addresses are not guaranteed to be true or correct.

PROPERTY INFORMATION REPORT

January 19, 2024

Tax Account #:09-4545-285

LEGAL DESCRIPTION EXHIBIT "A"

BEG AT NE COR OF LT 7 S 1 DEG 58 MIN 50 SEC W ALG E LI OF SEC 682 78/100 FT FOR POB SWLY ALG CENTER LI OF BAYOU CHICO CREEK THE FOLLOWING 4 COURSES & DIST S 70 DEG 39 MIN 0 SEC W 987 39/100 FT S 73 DEG 18 MIN 0 SEC W 700 FT S 42 DEG 58 MIN 0 SEC W 285 FT S 33 DEG 37 MIN 0 SEC W 744 65/100 FT TO NELY R/W LI OF S R 289-A WHICH PT LIES ON ARC OF CIRCULAR CURVE CONCAVE SWLY RADIUS 1196 28/100 FT TANGENT BEARS S 42 DEG 19 MIN 05 SEC E SELY ALG SD R/W AND CURVE THRU CENTRAL ANG 6 DEG 20 MIN 36 SEC ARC DIST 132 44/100 FT TO NW COR OF LT 1 BLK 2 FAIRFIELD EAST UNIT 1 ELY ALG NLY BOUNDARY OF SD S/D THE FOLLOWING COURSES AND DIST N 60 DEG 15 MIN 50 SEC E 242 32/100 FT N 57 DEG 22 MIN 30 SEC E 37 30/100 FT N 52 DEG 36 MIN 30 SEC E 62 22/100 FT N 7 DEG 59 MIN 10 SEC W 20 FT N 52 DEG 59 MIN 10 SEC W 45 86/100 FT THENCE RT ALG CIRCULAR CURVE CONCAVE SELY RADIUS 150 FT CENTRAL ANG 180 DEG 0 MIN 0 SEC ARC DIST 471 24/100 FT S 52 DEG 59 MIN 10 SEC E 60 FT N 65 DEG 49 MIN 32 SEC E 22 17/100 FT THENCE ALG CIRCULAR CURVE CONCAVE SELY RADIUS 280 FT CENTRAL ANG 23 DEG 0 MIN 06 SEC ARC DIST 112 41/100 FT N 75 DEG 53 MIN 56 SEC E 83 16/100 FT N 30 DEG 53 MIN 56 SEC E 20 FT N 14 DEG 06 MIN 04 SEC W 45 86/100 FT THENCE TO RT ALG CURVE CONCAVE SE RADIUS 150 FT CENTRAL ANG 180 FT 0 MIN 0 SEC ARC DIST 471 24/100 FT S 14 DEG 06 MIN 04 SEC E 45 86/100 FT S 59 DEG 06 MIN 04 SEC E 20 FT N 75 DEG 53 MIN 56 SEC E 48 03/100 FT THENCE RT ALG CIRCULAR CURVE CONCAVE SELY RADIUS 1130 FT CENTRAL ANG 6 DEG 32 MIN 0 SEC ARC DIST 128 85/100 FT N 59 DEG 34 MIN 08 SEC E 25 99/100 FT N 4 DEG 56 MIN 32 SEC W 230 FT N 15 DEG 19 MIN 54 SEC W 97 26/100 FT THENCE RT ALG CIRCULAR CURVE CONCAVE SELY RADIUS 150 FT CENTRAL ANG 87 DEG 09 MIN 54 SEC ARC DIST 228 20/100 FT N 71 DEG 50 MIN 0 SEC E 479 43/100 FT S 37 DEG 57 MIN 16 SEC E 312 14/100 FT TO NWLY RADIUS 170 FT TANGENT BEARS N 41 DEG 53 MIN 03 SEC E NELY ALG SD R/W AND CURVE THRU CENTRAL ANG 8 DEG 33 MIN 14 SEC ARC DIST 25 38/100 FT S 56 DEG 40 MIN 21 SEC E 197 69/100 FT N 64 DEG 53 MIN 50 SEC E 34 80/100 FT TO E LI OF SEC 21 N 1 DEG 58 MIN 50 SEC E ALG E LI OF SEC 489 97/100 FT TO POB OR 6410 P 919 SEC 21/15 T 2S R 31 LESS OR 4509 P 1125 ESCAMBA COUNTY FLORIDA LESS OR 5134 P 1945 MARCHAM

SECTION 21, TOWNSHIP 2 S, RANGE 31 W

TAX ACCOUNT NUMBER 09-4545-285(0424-31)

ABTRACTOR'S NOTE: WE CAN NOT CERTIFY LEGAL AS WRITTEN ON TAX ROLL WITHOUT A CURRENT SURVEY. WE DO NOT FIND ACCESS RECORDED FOR THIS PARCEL.

This instrument was prepared by and return to:
Wilson, Harrell, Smith, Farrington and Ford, P.A.
307 South Palafox Street
Pensacola, FL 32502
prepared without the benefit of title insurance
and at the grantors request

PARCEL I.D. #212S31-6101-003-001

QUIT CLAIM DEED

KNOW ALL MEN BY THESE PRESENTS, that **Gary Ray Williams, a married man, and Bettie A. Williams, a married woman**, Grantors, for and in consideration of the sum of (\$10.00) TEN AND NO/100 DOLLARS, the receipt whereof is hereby acknowledged, do remise, release, and quit claim unto **Vaughn T. Markham and Sue S. Markham, husband and wife**, whose address is 7666 Old Hickory Drive, Pensacola, FL 32507, Grantee, Grantee's heirs, executors, administrators and assigns, forever, the following described property, situated in the County of Escambia, State of Florida, to-wit:

SEE ATTACHED EXHIBIT A FOR LEGAL DESCRIPTION

Subject property is vacant and unimproved.

Together with all and singular the tenements, hereditaments and appurtenances thereto belonging or in anywise appertaining, free from all exemptions and right of homestead.

IN WITNESS WHEREOF, I have hereunto set my hand and seal this 18 day of October, 2008, A.D.

Signed, Sealed and Delivered
in the presence of:

Sign: [Signature]
Print: John E Moore

Sign: [Signature]
Print: Lisa P. Moore

[Signature] (SEAL)
Gary Ray Williams

[Signature] (SEAL)
Bettie A. Williams

STATE OF FLORIDA
COUNTY OF ESCAMBIA

The foregoing instrument was acknowledged before me this 18th day of October, 2008, by Gary Ray Williams, a married man, and Bettie A. Williams, a married woman, who is personally known to me or who produced _____ as identification.

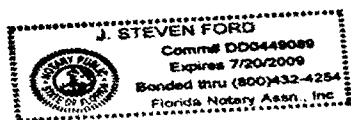

Sign: [Signature]
Print: J. Steven Ford
NOTARY PUBLIC - STATE OF FLORIDA
My Commission Expires: 7/20/09
My Commission Number: DD0449089

escpaLegal 212S316101003001

Page 1 of 1

Escambia County Property Appraiser
212S316101003001 - Full Legal Description

BEG AT NE COR OF LT 7 S 1 DEG 58 MIN 50 SEC W ALG E LI OF SEC 682 78/100 FT FOR POB SWLY ALG CENTER LI OF BAYOU CHICO CREEK THE FOLLOWING 4 COURSES & DIST S 70 DEG 39 MIN 0 SEC W 987 39/100 FT S 73 DEG 18 MIN 0 SEC W 700 FT S 42 DEG 58 MIN 0 SEC W 285 FT S 33 DEG 37 MIN 0 SEC W 744 65/100 FT TO NELY R/W LI OF S R 289-A WHICH PT LIES ON ARC OF CIRCULAR CURVE CONCAVE SWLY RADIUS 1196 28/100 FT TANGENT BEARS S 42 DEG 19 MIN 05 SEC E SELY ALG SD R/W AND CURVE THRU CENTRAL ANG 6 DEG 20 MIN 36 SEC ARC DIST 132 44/100 FT TO NW COR OF LT 1 BLK 2 FAIRFIELD EAST UNIT 1 ELY ALG NLY BOUNDARY OF SD S/D THE FOLLOWING COURSES AND DIST N 60 DEG 15 MIN 50 SEC E 242 32/100 FT N 57 DEG 22 MIN 30 SEC E 37 30/100 FT N 52 DEG 36 MIN 30 SEC E 62 22/100 FT N 7 DEG 59 MIN 10 SEC W 20 FT N 52 DEG 59 MIN 10 SEC W 45 86/100 FT THENCE RT ALG CIRCULAR CURVE CONCAVE SELY RADIUS 150 FT CENTRAL ANG 180 DEG 0 MIN 0 SEC ARC DIST 471 24/100 FT S 52 DEG 59 MIN 10 SEC E 60 FT N 65 DEG 49 MIN 32 SEC E 22 17/100 FT THENCE ALG CIRCULAR CURVE CONCAVE SELY RADIUS 280 FT CENTRAL ANG 23 DEG 0 MIN 06 SEC ARC DIST 112 41/100 FT N 75 DEG 53 MIN 56 SEC E 83 16/100 FT N 30 DEG 53 MIN 56 SEC E 20 FT N 14 DEG 06 MIN 04 SEC W 45 86/100 FT THENCE TO RT ALG CURVE CONCAVE SE RADIUS 150 FT CENTRAL ANG 180 FT 0 MIN 0 SEC ARC DIST 471 24/100 FT S 14 DEG 06 MIN 04 SEC E 45 86/100 FT S 59 DEG 06 MIN 04 SEC E 20 FT N 75 DEG 53 MIN 56 SEC E 48 03/100 FT THENCE RT ALG CIRCULAR CURVE CONCAVE SELY RADIUS 1130 FT CENTRAL ANG 6 DEG 32 MIN 0 SEC ARC DIST 128 85/100 FT N 59 DEG 34 MIN 08 SEC E 25 99/100 FT N 4 DEG 56 MIN 32 SEC W 230 FT N 15 DEG 19 MIN 54 SEC W 97 26/100 FT THENCE RT ALG CIRCULAR CURVE CONCAVE SELY RADIUS 150 FT CENTRAL ANG 87 DEG 09 MIN 54 SEC ARC DIST 228 20/100 FT N 71 DEG 50 MIN 0 SEC E 479 43/100 FT S 37 DEG 57 MIN 16 SEC E 312 14/100 FT TO NWLY RADIUS 170 FT TANGENT BEARS N 41 DEG 53 MIN 03 SEC E NELY ALG SD R/W AND CURVE THRU CENTRAL ANG 8 DEG 33 MIN 14 SEC ARC DIST 25 38/100 FT S 56 DEG 40 MIN 21 SEC E 197 69/100 FT N 64 DEG 53 MIN 50 SEC E 34 80/100 FT TO E LI OF SEC 21 N 1 DEG 58 MIN 50 SEC E ALG E LI OF SEC 489 97/100 FT TO POB SEC 21/15 T 2S R 31 OR 4151 P 1304 LESS OR 4509 P 1125 ESCAMBIA COUNTY FLORIDA LESS OR 5134 P 1945 MARCHAM

Exhibit A

**STATE OF FLORIDA
COUNTY OF ESCAMBIA**

**CERTIFICATE OF NOTICE OF MAILING
NOTICE OF APPLICATION FOR TAX DEED**

CERTIFICATE # 04162 of 2021

I, PAM CHILDERS, CLERK OF THE CIRCUIT COURT OF ESCAMBIA COUNTY, FLORIDA, do hereby certify that I did on February 15, 2024, mail a copy of the foregoing Notice of Application for Tax Deed, addressed to:

VAUGHN T MARKHAM SUE S MARKHAM
7666 OLD HICKORY DR 7666 OLD HICKORY DR
PENSACOLA, FL 32507 PENSACOLA, FL 32507

WITNESS my official seal this 15th day of February 2024.



PAM CHILDERS
CLERK OF THE CIRCUIT COURT
ESCAMBIA COUNTY, FLORIDA

By:
Emily Hogg
Deputy Clerk

WARNING

THERE ARE UNPAID TAXES ON PROPERTY WHICH YOU OWN OR IN WHICH YOU HAVE A LEGAL INTEREST. THE PROPERTY WILL BE SOLD AT PUBLIC AUCTION ON April 3, 2024, UNLESS THE TAXES ARE PAID. SHOULD YOU NEED FURTHER INFORMATION CONTACT THE CLERK OF THE CIRCUIT COURT IMMEDIATELY AT THE COUNTY COURTHOUSE IN PENSACOLA, FLORIDA, OR CALL 850-595-3793.

NOTICE OF APPLICATION FOR TAX DEED

NOTICE IS HEREBY GIVEN, That RYAN VIGNEAU holder of Tax Certificate No. 04162, issued the 1st day of June, A.D., 2021 has filed same in my office and has made application for a tax deed to be issued thereon. Said certificate embraces the following described property in the County of Escambia, State of Florida, to wit:

(see attached)

SECTION 21, TOWNSHIP 2 S, RANGE 31 W

TAX ACCOUNT NUMBER 094545285 (0424-31)

The assessment of the said property under the said certificate issued was in the name of

VAUGHN T MARKHAM and SUE S MARKHAM

Unless said certificate shall be redeemed according to law, the property described therein will be sold to the highest bidder at public auction at 9:00 A.M. on the first Wednesday in the month of April, which is the 3rd day of April 2024.

Dated this 2nd day of February 2024.

In accordance with the AMERICANS WITH DISABILITIES ACT, if you are a person with a disability who needs special accommodation in order to participate in this proceeding you are entitled to the provision of certain assistance. Please contact Emily Hogg not later than seven days prior to the proceeding at Escambia County Government Complex, 221 Palafox Place Ste 110, Pensacola FL 32502. Telephone: 850-595-3793.



PAM CHILDERS
CLERK OF THE CIRCUIT COURT
ESCAMBIA COUNTY, FLORIDA

By:
Emily Hogg
Deputy Clerk

LEGAL DESCRIPTION

BEG AT NE COR OF LT 7 S 1 DEG 58 MIN 50 SEC W ALG E LI OF SEC 682 78/100 FT FOR POB SWLY ALG CENTER LI OF BAYOU CHICO CREEK THE FOLLOWING 4 COURSES & DIST S 70 DEG 39 MIN 0 SEC W 987 39/100 FT S 73 DEG 18 MIN 0 SEC W 700 FT S 42 DEG 58 MIN 0 SEC W 285 FT S 33 DEG 37 MIN 0 SEC W 744 65/100 FT TO NELY R/W LI OF S R 289-A WHICH PT LIES ON ARC OF CIRCULAR CURVE CONCAVE SWLY RADIUS 1196 28/100 FT TANGENT BEARS S 42 DEG 19 MIN 05 SEC E SELY ALG SD R/W AND CURVE THRU CENTRAL ANG 6 DEG 20 MIN 36 SEC ARC DIST 132 44/100 FT TO NW COR OF LT 1 BLK 2 FAIRFIELD EAST UNIT 1 ELY ALG NLY BOUNDARY OF SD S/D THE FOLLOWING COURSES AND DIST N 60 DEG 15 MIN 50 SEC E 242 32/100 FT N 57 DEG 22 MIN 30 SEC E 37 30/100 FT N 52 DEG 36 MIN 30 SEC E 62 22/100 FT N 7 DEG 59 MIN 10 SEC W 20 FT N 52 DEG 59 MIN 10 SEC W 45 86/100 FT THENCE RT ALG CIRCULAR CURVE CONCAVE SELY RADIUS 150 FT CENTRAL ANG 180 DEG 0 MIN 0 SEC ARC DIST 471 24/100 FT S 52 DEG 59 MIN 10 SEC E 60 FT N 65 DEG 49 MIN 32 SEC E 22 17/100 FT THENCE ALG CIRCULAR CURVE CONCAVE SELY RADIUS 280 FT CENTRAL ANG 23 DEG 0 MIN 06 SEC ARC DIST 112 41/100 FT N 75 DEG 53 MIN 56 SEC E 83 16/100 FT N 30 DEG 53 MIN 56 SEC E 20 FT N 14 DEG 06 MIN 04 SEC W 45 86/100 FT THENCE TO RT ALG CURVE CONCAVE SE RADIUS 150 FT CENTRAL ANG 180 FT 0 MIN 0 SEC ARC DIST 471 24/100 FT S 14 DEG 06 MIN 04 SEC E 45 86/100 FT S 59 DEG 06 MIN 04 SEC E 20 FT N 75 DEG 53 MIN 56 SEC E 48 03/100 FT THENCE RT ALG CIRCULAR CURVE CONCAVE SELY RADIUS 1130 FT CENTRAL ANG 6 DEG 32 MIN 0 SEC ARC DIST 128 85/100 FT N 59 DEG 34 MIN 08 SEC E 25 99/100 FT N 4 DEG 56 MIN 32 SEC W 230 FT N 15 DEG 19 MIN 54 SEC W 97 26/100 FT THENCE RT ALG CIRCULAR CURVE CONCAVE SELY RADIUS 150 FT CENTRAL ANG 87 DEG 09 MIN 54 SEC ARC DIST 228 20/100 FT N 71 DEG 50 MIN 0 SEC E 479 43/100 FT S 37 DEG 57 MIN 16 SEC E 312 14/100 FT TO NWLY RADIUS 170 FT TANGENT BEARS N 41 DEG 53 MIN 03 SEC E NELY ALG SD R/W AND CURVE THRU CENTRAL ANG 8 DEG 33 MIN 14 SEC ARC DIST 25 38/100 FT S 56 DEG 40 MIN 21 SEC E 197 69/100 FT N 64 DEG 53 MIN 50 SEC E 34 80/100 FT TO E LI OF SEC 21 N 1 DEG 58 MIN 50 SEC E ALG E LI OF SEC 489 97/100 FT TO POB OR 6410 P 919 SEC 21/15 T 2S R 31 LESS OR 4509 P 1125 ESCAMBIA COUNTY FLORIDA LESS OR 5134 P 1945 MARCHAM

WARNING

THERE ARE UNPAID TAXES ON PROPERTY WHICH YOU OWN OR IN WHICH YOU HAVE A LEGAL INTEREST. THE PROPERTY WILL BE SOLD AT PUBLIC AUCTION ON April 3, 2024, UNLESS THE TAXES ARE PAID. SHOULD YOU NEED FURTHER INFORMATION CONTACT THE CLERK OF THE CIRCUIT COURT IMMEDIATELY AT THE COUNTY COURTHOUSE IN PENSACOLA, FLORIDA, OR CALL 850-595-3793.

NOTICE OF APPLICATION FOR TAX DEED

NOTICE IS HEREBY GIVEN, That RYAN VIGNEAU holder of Tax Certificate No. 04162, issued the 1st day of June, A.D., 2021 has filed same in my office and has made application for a tax deed to be issued thereon. Said certificate embraces the following described property in the County of Escambia, State of Florida, to wit:

(see attached)

SECTION 21, TOWNSHIP 2 S, RANGE 31 W

TAX ACCOUNT NUMBER 094545285 (0424-31)

The assessment of the said property under the said certificate issued was in the name of

VAUGHN T MARKHAM and SUE S MARKHAM

Unless said certificate shall be redeemed according to law, the property described therein will be sold to the highest bidder at public auction at 9:00 A.M. on the first Wednesday in the month of April, which is the 3rd day of April 2024.

Dated this 30th day of January 2024.

In accordance with the AMERICANS WITH DISABILITIES ACT, if you are a person with a disability who needs special accommodation in order to participate in this proceeding you are entitled to the provision of certain assistance. Please contact Emily Hogg not later than seven days prior to the proceeding at Escambia County Government Complex, 221 Palafox Place Ste 110, Pensacola FL 32502. Telephone: 850-595-3793.

Personal Services:

VAUGHN T MARKHAM
7666 OLD HICKORY DR
PENSACOLA, FL 32507

PAM CHILDERS
CLERK OF THE CIRCUIT COURT
ESCAMBIA COUNTY, FLORIDA



By:
Emily Hogg
Deputy Clerk

LEGAL DESCRIPTION

BEG AT NE COR OF LT 7 S 1 DEG 58 MIN 50 SEC W ALG E LI OF SEC 682 78/100 FT FOR POB SWLY ALG CENTER LI OF BAYOU CHICO CREEK THE FOLLOWING 4 COURSES & DIST S 70 DEG 39 MIN 0 SEC W 987 39/100 FT S 73 DEG 18 MIN 0 SEC W 700 FT S 42 DEG 58 MIN 0 SEC W 285 FT S 33 DEG 37 MIN 0 SEC W 744 65/100 FT TO NELY R/W LI OF S R 289-A WHICH PT LIES ON ARC OF CIRCULAR CURVE CONCAVE SWLY RADIUS 1196 28/100 FT TANGENT BEARS S 42 DEG 19 MIN 05 SEC E SELY ALG SD R/W AND CURVE THRU CENTRAL ANG 6 DEG 20 MIN 36 SEC ARC DIST 132 44/100 FT TO NW COR OF LT 1 BLK 2 FAIRFIELD EAST UNIT 1 ELY ALG NLY BOUNDARY OF SD S/D THE FOLLOWING COURSES AND DIST N 60 DEG 15 MIN 50 SEC E 242 32/100 FT N 57 DEG 22 MIN 30 SEC E 37 30/100 FT N 52 DEG 36 MIN 30 SEC E 62 22/100 FT N 7 DEG 59 MIN 10 SEC W 20 FT N 52 DEG 59 MIN 10 SEC W 45 86/100 FT THENCE RT ALG CIRCULAR CURVE CONCAVE SELY RADIUS 150 FT CENTRAL ANG 180 DEG 0 MIN 0 SEC ARC DIST 471 24/100 FT S 52 DEG 59 MIN 10 SEC E 60 FT N 65 DEG 49 MIN 32 SEC E 22 17/100 FT THENCE ALG CIRCULAR CURVE CONCAVE SELY RADIUS 280 FT CENTRAL ANG 23 DEG 0 MIN 06 SEC ARC DIST 112 41/100 FT N 75 DEG 53 MIN 56 SEC E 83 16/100 FT N 30 DEG 53 MIN 56 SEC E 20 FT N 14 DEG 06 MIN 04 SEC W 45 86/100 FT THENCE TO RT ALG CURVE CONCAVE SE RADIUS 150 FT CENTRAL ANG 180 FT 0 MIN 0 SEC ARC DIST 471 24/100 FT S 14 DEG 06 MIN 04 SEC E 45 86/100 FT S 59 DEG 06 MIN 04 SEC E 20 FT N 75 DEG 53 MIN 56 SEC E 48 03/100 FT THENCE RT ALG CIRCULAR CURVE CONCAVE SELY RADIUS 1130 FT CENTRAL ANG 6 DEG 32 MIN 0 SEC ARC DIST 128 85/100 FT N 59 DEG 34 MIN 08 SEC E 25 99/100 FT N 4 DEG 56 MIN 32 SEC W 230 FT N 15 DEG 19 MIN 54 SEC W 97 26/100 FT THENCE RT ALG CIRCULAR CURVE CONCAVE SELY RADIUS 150 FT CENTRAL ANG 87 DEG 09 MIN 54 SEC ARC DIST 228 20/100 FT N 71 DEG 50 MIN 0 SEC E 479 43/100 FT S 37 DEG 57 MIN 16 SEC E 312 14/100 FT TO NWLY RADIUS 170 FT TANGENT BEARS N 41 DEG 53 MIN 03 SEC E NELY ALG SD R/W AND CURVE THRU CENTRAL ANG 8 DEG 33 MIN 14 SEC ARC DIST 25 38/100 FT S 56 DEG 40 MIN 21 SEC E 197 69/100 FT N 64 DEG 53 MIN 50 SEC E 34 80/100 FT TO E LI OF SEC 21 N 1 DEG 58 MIN 50 SEC E ALG E LI OF SEC 489 97/100 FT TO POB OR 6410 P 919 SEC 21/15 T 2S R 31 LESS OR 4509 P 1125 ESCAMBIA COUNTY FLORIDA LESS OR 5134 P 1945 MARCHAM

WARNING

THERE ARE UNPAID TAXES ON PROPERTY WHICH YOU OWN OR IN WHICH YOU HAVE A LEGAL INTEREST. THE PROPERTY WILL BE SOLD AT PUBLIC AUCTION ON April 3, 2024, UNLESS THE TAXES ARE PAID. SHOULD YOU NEED FURTHER INFORMATION CONTACT THE CLERK OF THE CIRCUIT COURT IMMEDIATELY AT THE COUNTY COURTHOUSE IN PENSACOLA, FLORIDA, OR CALL 850-595-3793.

NOTICE OF APPLICATION FOR TAX DEED

NOTICE IS HEREBY GIVEN, That **RYAN VIGNEAU** holder of **Tax Certificate No. 04162**, issued the 1st day of **June, A.D., 2021** has filed same in my office and has made application for a tax deed to be issued thereon. Said certificate embraces the following described property in the County of Escambia, State of Florida, to wit:

(see attached)

SECTION 21, TOWNSHIP 2 S, RANGE 31 W

TAX ACCOUNT NUMBER 094545285 (0424-31)

The assessment of the said property under the said certificate issued was in the name of

VAUGHN T MARKHAM and SUE S MARKHAM

Unless said certificate shall be redeemed according to law, the property described therein will be sold to the highest bidder at public auction at 9:00 A.M. on the **first** Wednesday in the month of April, which is the **3rd** day of April 2024.

Dated this 30th day of January 2024.

In accordance with the AMERICANS WITH DISABILITIES ACT, if you are a person with a disability who needs special accommodation in order to participate in this proceeding you are entitled to the provision of certain assistance. Please contact Emily Hogg not later than seven days prior to the proceeding at Escambia County Government Complex, 221 Palafox Place Ste 110, Pensacola FL 32502. Telephone: 850-595-3793.

Personal Services:

SUE S MARKHAM
7666 OLD HICKORY DR
PENSACOLA, FL 32507

PAM CHILDERS
CLERK OF THE CIRCUIT COURT
ESCAMBIA COUNTY, FLORIDA

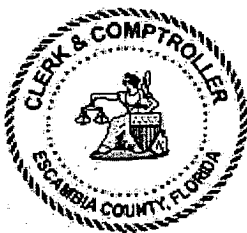

By:
Emily Hogg
Deputy Clerk

LEGAL DESCRIPTION

BEG AT NE COR OF LT 7 S 1 DEG 58 MIN 50 SEC W ALG E LI OF SEC 682 78/100 FT FOR POB SWLY ALG CENTER LI OF BAYOU CHICO CREEK THE FOLLOWING 4 COURSES & DIST S 70 DEG 39 MIN 0 SEC W 987 39/100 FT S 73 DEG 18 MIN 0 SEC W 700 FT S 42 DEG 58 MIN 0 SEC W 285 FT S 33 DEG 37 MIN 0 SEC W 744 65/100 FT TO NELY R/W LI OF S R 289-A WHICH PT LIES ON ARC OF CIRCULAR CURVE CONCAVE SWLY RADIUS 1196 28/100 FT TANGENT BEARS S 42 DEG 19 MIN 05 SEC E SELY ALG SD R/W AND CURVE THRU CENTRAL ANG 6 DEG 20 MIN 36 SEC ARC DIST 132 44/100 FT TO NW COR OF LT 1 BLK 2 FAIRFIELD EAST UNIT 1 ELY ALG NLY BOUNDARY OF SD S/D THE FOLLOWING COURSES AND DIST N 60 DEG 15 MIN 50 SEC E 242 32/100 FT N 57 DEG 22 MIN 30 SEC E 37 30/100 FT N 52 DEG 36 MIN 30 SEC E 62 22/100 FT N 7 DEG 59 MIN 10 SEC W 20 FT N 52 DEG 59 MIN 10 SEC W 45 86/100 FT THENCE RT ALG CIRCULAR CURVE CONCAVE SELY RADIUS 150 FT CENTRAL ANG 180 DEG 0 MIN 0 SEC ARC DIST 471 24/100 FT S 52 DEG 59 MIN 10 SEC E 60 FT N 65 DEG 49 MIN 32 SEC E 22 17/100 FT THENCE ALG CIRCULAR CURVE CONCAVE SELY RADIUS 280 FT CENTRAL ANG 23 DEG 0 MIN 06 SEC ARC DIST 112 41/100 FT N 75 DEG 53 MIN 56 SEC E 83 16/100 FT N 30 DEG 53 MIN 56 SEC E 20 FT N 14 DEG 06 MIN 04 SEC W 45 86/100 FT THENCE TO RT ALG CURVE CONCAVE SE RADIUS 150 FT CENTRAL ANG 180 FT 0 MIN 0 SEC ARC DIST 471 24/100 FT S 14 DEG 06 MIN 04 SEC E 45 86/100 FT S 59 DEG 06 MIN 04 SEC E 20 FT N 75 DEG 53 MIN 56 SEC E 48 03/100 FT THENCE RT ALG CIRCULAR CURVE CONCAVE SELY RADIUS 1130 FT CENTRAL ANG 6 DEG 32 MIN 0 SEC ARC DIST 128 85/100 FT N 59 DEG 34 MIN 08 SEC E 25 99/100 FT N 4 DEG 56 MIN 32 SEC W 230 FT N 15 DEG 19 MIN 54 SEC W 97 26/100 FT THENCE RT ALG CIRCULAR CURVE CONCAVE SELY RADIUS 150 FT CENTRAL ANG 87 DEG 09 MIN 54 SEC ARC DIST 228 20/100 FT N 71 DEG 50 MIN 0 SEC E 479 43/100 FT S 37 DEG 57 MIN 16 SEC E 312 14/100 FT TO NWLY RADIUS 170 FT TANGENT BEARS N 41 DEG 53 MIN 03 SEC E NELY ALG SD R/W AND CURVE THRU CENTRAL ANG 8 DEG 33 MIN 14 SEC ARC DIST 25 38/100 FT S 56 DEG 40 MIN 21 SEC E 197 69/100 FT N 64 DEG 53 MIN 50 SEC E 34 80/100 FT TO E LI OF SEC 21 N 1 DEG 58 MIN 50 SEC E ALG E LI OF SEC 489 97/100 FT TO POB OR 6410 P 919 SEC 21/15 T 2S R 31 LESS OR 4509 P 1125 ESCAMBIA COUNTY FLORIDA LESS OR 5134 P 1945 MARCHAM

ESCAMBIA COUNTY SHERIFF'S OFFICE
ESCAMBIA COUNTY, FLORIDA

NON-ENFORCEABLE RETURN OF SERVICE

0424-31

Document Number: ECSO24CIV007223NON

Agency Number: 24-004023

Court: TAX DEED

County: ESCAMBIA

Case Number: CERT NO 04162 2021

Attorney/Agent:

PAM CHILDERS
CLERK OF COURT
TAX DEED

Plaintiff: RE: VAUGHN T MARKHAM AND SUE S MARKHAM

Defendant:

Type of Process: NOTICE OF APPLICATION FOR TAX DEED

Individual

Received this Writ on 2/23/2024 at 8:41 AM and served same on VAUGHN T MARKHAM , at 8:05 AM on 2/27/2024 in ESCAMBIA COUNTY, FLORIDA, by delivering a true copy of this Writ together with a copy of the initial pleadings, if any, with the date and hour of service endorsed thereon by me.

CHIP W SIMMONS, SHERIFF
ESCAMBIA COUNTY, FLORIDA

By: _____



D. NELSON, CPS

Service Fee: \$40.00
Receipt No: BILL

Printed By: LSTRAVIS

WARNING

THERE ARE UNPAID TAXES ON PROPERTY WHICH YOU OWN OR IN WHICH YOU HAVE A LEGAL INTEREST. THE PROPERTY WILL BE SOLD AT PUBLIC AUCTION ON April 3, 2024, UNLESS THE TAXES ARE PAID. SHOULD YOU NEED FURTHER INFORMATION CONTACT THE CLERK OF THE CIRCUIT COURT IMMEDIATELY AT THE COUNTY COURTHOUSE IN PENSACOLA, FLORIDA, OR CALL 850-595-3793.

NOTICE OF APPLICATION FOR TAX DEED

NOTICE IS HEREBY GIVEN, That RYAN VIGNEAU holder of Tax Certificate No. 04162, issued the 1st day of June, A.D., 2021 has filed same in my office and has made application for a tax deed to be issued thereon. Said certificate embraces the following described property in the County of Escambia, State of Florida, to wit:

(see attached)

SECTION 21, TOWNSHIP 2 S, RANGE 31 W

TAX ACCOUNT NUMBER 094545285 (0424-31)

The assessment of the said property under the said certificate issued was in the name of

VAUGHN T MARKHAM and SUE S MARKHAM

Unless said certificate shall be redeemed according to law, the property described therein will be sold to the highest bidder at public auction at 9:00 A.M. on the first Wednesday in the month of April, which is the 3rd day of April 2024.

Dated this 30th day of January 2024.

In accordance with the AMERICANS WITH DISABILITIES ACT, if you are a person with a disability who needs special accommodation in order to participate in this proceeding you are entitled to the provision of certain assistance. Please contact Emily Hogg not later than seven days prior to the proceeding at Escambia County Government Complex, 221 Palafox Place Ste 110, Pensacola FL 32502. Telephone: 850-595-3793.

Personal Services:

VAUGHN T MARKHAM
7666 OLD HICKORY DR
PENSACOLA, FL 32507

PAM CHILDERS
CLERK OF THE CIRCUIT COURT
ESCAMBIA COUNTY, FLORIDA



By:
Emily Hogg
Deputy Clerk

ESCAMBIA COUNTY, FL
CLERK OF THE CIRCUIT COURT
RECEIVED

2024 FEB 23 AM 9:41

RECEIVED

LEGAL DESCRIPTION

BEG AT NE COR OF LT 7 S 1 DEG 58 MIN 50 SEC W ALG E LI OF SEC 682 78/100 FT FOR POB SWLY ALG CENTER LI OF BAYOU CHICO CREEK THE FOLLOWING 4 COURSES & DIST S 70 DEG 39 MIN 0 SEC W 987 39/100 FT S 73 DEG 18 MIN 0 SEC W 700 FT S 42 DEG 58 MIN 0 SEC W 285 FT S 33 DEG 37 MIN 0 SEC W 744 65/100 FT TO NELY R/W LI OF S R 289-A WHICH PT LIES ON ARC OF CIRCULAR CURVE CONCAVE SWLY RADIUS 1196 28/100 FT TANGENT BEARS S 42 DEG 19 MIN 05 SEC E SELY ALG SD R/W AND CURVE THRU CENTRAL ANG 6 DEG 20 MIN 36 SEC ARC DIST 132 44/100 FT TO NW COR OF LT 1 BLK 2 FAIRFIELD EAST UNIT 1 ELY ALG NLY BOUNDARY OF SD S/D THE FOLLOWING COURSES AND DIST N 60 DEG 15 MIN 50 SEC E 242 32/100 FT N 57 DEG 22 MIN 30 SEC E 37 30/100 FT N 52 DEG 36 MIN 30 SEC E 62 22/100 FT N 7 DEG 59 MIN 10 SEC W 20 FT N 52 DEG 59 MIN 10 SEC W 45 86/100 FT THENCE RT ALG CIRCULAR CURVE CONCAVE SELY RADIUS 150 FT CENTRAL ANG 180 DEG 0 MIN 0 SEC ARC DIST 471 24/100 FT S 52 DEG 59 MIN 10 SEC E 60 FT N 65 DEG 49 MIN 32 SEC E 22 17/100 FT THENCE ALG CIRCULAR CURVE CONCAVE SELY RADIUS 280 FT CENTRAL ANG 23 DEG 0 MIN 06 SEC ARC DIST 112 41/100 FT N 75 DEG 53 MIN 56 SEC E 83 16/100 FT N 30 DEG 53 MIN 56 SEC E 20 FT N 14 DEG 06 MIN 04 SEC W 45 86/100 FT THENCE TO RT ALG CURVE CONCAVE SE RADIUS 150 FT CENTRAL ANG 180 FT 0 MIN 0 SEC ARC DIST 471 24/100 FT S 14 DEG 06 MIN 04 SEC E 45 86/100 FT S 59 DEG 06 MIN 04 SEC E 20 FT N 75 DEG 53 MIN 56 SEC E 48 03/100 FT THENCE RT ALG CIRCULAR CURVE CONCAVE SELY RADIUS 1130 FT CENTRAL ANG 6 DEG 32 MIN 0 SEC ARC DIST 128 85/100 FT N 59 DEG 34 MIN 08 SEC E 25 99/100 FT N 4 DEG 56 MIN 32 SEC W 230 FT N 15 DEG 19 MIN 54 SEC W 97 26/100 FT THENCE RT ALG CIRCULAR CURVE CONCAVE SELY RADIUS 150 FT CENTRAL ANG 87 DEG 09 MIN 54 SEC ARC DIST 228 20/100 FT N 71 DEG 50 MIN 0 SEC E 479 43/100 FT S 37 DEG 57 MIN 16 SEC E 312 14/100 FT TO NWLY RADIUS 170 FT TANGENT BEARS N 41 DEG 53 MIN 03 SEC E NELY ALG SD R/W AND CURVE THRU CENTRAL ANG 8 DEG 33 MIN 14 SEC ARC DIST 25 38/100 FT S 56 DEG 40 MIN 21 SEC E 197 69/100 FT N 64 DEG 53 MIN 50 SEC E 34 80/100 FT TO E LI OF SEC 21 N 1 DEG 58 MIN 50 SEC E ALG E LI OF SEC 489 97/100 FT TO POB OR 6410 P 919 SEC 21/15 T 2S R 31 LESS OR 4509 P 1125 ESCAMBIA COUNTY FLORIDA LESS OR 5134 P 1945 MARCHAM

ESCAMBIA COUNTY SHERIFF'S OFFICE
ESCAMBIA COUNTY, FLORIDA

NON-ENFORCEABLE RETURN OF SERVICE

0424-31

Document Number: ECSO24CIV007220NON

Agency Number: 24-004022

Court: TAX DEED

County: ESCAMBIA

Case Number: CERT NO 04162 2021

Attorney/Agent:

PAM CHILDERS
CLERK OF COURT
TAX DEED

Plaintiff: RE: VAUGHN T MARKHAM AND SUE S MARKHAM

Defendant:

Type of Process: NOTICE OF APPLICATION FOR TAX DEED

Substitute

Received this Writ on 2/23/2024 at 8:41 AM and served same on SUE S MARKHAM , in ESCAMBIA COUNTY, FLORIDA, at 8:05 AM on 2/27/2024 by leaving a true copy of this Writ together with a copy of the initial pleadings, if any, with the date and hour of service endorsed thereon by me, at the within named individual's usual place of abode, with a person residing therein who is 15 years of age, or older, to wit: VAUGHN MARKHAM, HUSBAND, as a member of the household and informing said person of their contents.

CHIP W SIMMONS, SHERIFF
ESCAMBIA COUNTY, FLORIDA

By: _____

D Nelson 925

D. NELSON, CPS

Service Fee: \$40.00

Receipt No: BILL

Printed By: LSTRAVIS

WARNING

THERE ARE UNPAID TAXES ON PROPERTY WHICH YOU OWN OR IN WHICH YOU HAVE A LEGAL INTEREST. THE PROPERTY WILL BE SOLD AT PUBLIC AUCTION ON April 3, 2024, UNLESS THE TAXES ARE PAID. SHOULD YOU NEED FURTHER INFORMATION CONTACT THE CLERK OF THE CIRCUIT COURT IMMEDIATELY AT THE COUNTY COURTHOUSE IN PENSACOLA, FLORIDA, OR CALL 850-595-3793.

NOTICE OF APPLICATION FOR TAX DEED

NOTICE IS HEREBY GIVEN, That RYAN VIGNEAU holder of Tax Certificate No. 04162, issued the 1st day of June, A.D., 2021 has filed same in my office and has made application for a tax deed to be issued thereon. Said certificate embraces the following described property in the County of Escambia, State of Florida, to wit:

(see attached)

SECTION 21, TOWNSHIP 2 S, RANGE 31 W

TAX ACCOUNT NUMBER 094545285 (0424-31)

The assessment of the said property under the said certificate issued was in the name of

VAUGHN T MARKHAM and SUE S MARKHAM

Unless said certificate shall be redeemed according to law, the property described therein will be sold to the highest bidder at public auction at 9:00 A.M. on the first Wednesday in the month of April, which is the 3rd day of April 2024.

Dated this 30th day of January 2024.

In accordance with the AMERICANS WITH DISABILITIES ACT, if you are a person with a disability who needs special accommodation in order to participate in this proceeding you are entitled to the provision of certain assistance. Please contact Emily Hogg not later than seven days prior to the proceeding at Escambia County Government Complex, 221 Palafox Place Ste 110, Pensacola FL 32502. Telephone: 850-595-3793.

Personal Services:

SUE S MARKHAM
7666 OLD HICKORY DR
PENSACOLA, FL 32507

PAM CHILDERS
CLERK OF THE CIRCUIT COURT
ESCAMBIA COUNTY, FLORIDA



By:
Emily Hogg
Deputy Clerk

RECORDED
2024 FEB 23 AM 8:41
ESCAMBIA COUNTY FL
CLERK OF THE CIRCUIT COURT

LEGAL DESCRIPTION

BEG AT NE COR OF LT 7 S 1 DEG 58 MIN 50 SEC W ALG E LI OF SEC 682 78/100 FT FOR POB SWLY ALG CENTER LI OF BAYOU CHICO CREEK THE FOLLOWING 4 COURSES & DIST S 70 DEG 39 MIN 0 SEC W 987 39/100 FT S 73 DEG 18 MIN 0 SEC W 700 FT S 42 DEG 58 MIN 0 SEC W 285 FT S 33 DEG 37 MIN 0 SEC W 744 65/100 FT TO NELY R/W LI OF S R 289-A WHICH PT LIES ON ARC OF CIRCULAR CURVE CONCAVE SWLY RADIUS 1196 28/100 FT TANGENT BEARS S 42 DEG 19 MIN 05 SEC E SELY ALG SD R/W AND CURVE THRU CENTRAL ANG 6 DEG 20 MIN 36 SEC ARC DIST 132 44/100 FT TO NW COR OF LT 1 BLK 2 FAIRFIELD EAST UNIT 1 ELY ALG NLY BOUNDARY OF SD S/D THE FOLLOWING COURSES AND DIST N 60 DEG 15 MIN 50 SEC E 242 32/100 FT N 57 DEG 22 MIN 30 SEC E 37 30/100 FT N 52 DEG 36 MIN 30 SEC E 62 22/100 FT N 7 DEG 59 MIN 10 SEC W 20 FT N 52 DEG 59 MIN 10 SEC W 45 86/100 FT THENCE RT ALG CIRCULAR CURVE CONCAVE SELY RADIUS 150 FT CENTRAL ANG 180 DEG 0 MIN 0 SEC ARC DIST 471 24/100 FT S 52 DEG 59 MIN 10 SEC E 60 FT N 65 DEG 49 MIN 32 SEC E 22 17/100 FT THENCE ALG CIRCULAR CURVE CONCAVE SELY RADIUS 280 FT CENTRAL ANG 23 DEG 0 MIN 06 SEC ARC DIST 112 41/100 FT N 75 DEG 53 MIN 56 SEC E 83 16/100 FT N 30 DEG 53 MIN 56 SEC E 20 FT N 14 DEG 06 MIN 04 SEC W 45 86/100 FT THENCE TO RT ALG CURVE CONCAVE SE RADIUS 150 FT CENTRAL ANG 180 FT 0 MIN 0 SEC ARC DIST 471 24/100 FT S 14 DEG 06 MIN 04 SEC E 45 86/100 FT S 59 DEG 06 MIN 04 SEC E 20 FT N 75 DEG 53 MIN 56 SEC E 48 03/100 FT THENCE RT ALG CIRCULAR CURVE CONCAVE SELY RADIUS 1130 FT CENTRAL ANG 6 DEG 32 MIN 0 SEC ARC DIST 128 85/100 FT N 59 DEG 34 MIN 08 SEC E 25 99/100 FT N 4 DEG 56 MIN 32 SEC W 230 FT N 15 DEG 19 MIN 54 SEC W 97 26/100 FT THENCE RT ALG CIRCULAR CURVE CONCAVE SELY RADIUS 150 FT CENTRAL ANG 87 DEG 09 MIN 54 SEC ARC DIST 228 20/100 FT N 71 DEG 50 MIN 0 SEC E 479 43/100 FT S 37 DEG 57 MIN 16 SEC E 312 14/100 FT TO NWLY RADIUS 170 FT TANGENT BEARS N 41 DEG 53 MIN 03 SEC E NELY ALG SD R/W AND CURVE THRU CENTRAL ANG 8 DEG 33 MIN 14 SEC ARC DIST 25 38/100 FT S 56 DEG 40 MIN 21 SEC E 197 69/100 FT N 64 DEG 53 MIN 50 SEC E 34 80/100 FT TO E LI OF SEC 21 N 1 DEG 58 MIN 50 SEC E ALG E LI OF SEC 489 97/100 FT TO POB OR 6410 P 919 SEC 21/15 T 2S R 31 LESS OR 4509 P 1125 ESCAMBIA COUNTY FLORIDA LESS OR 5134 P 1945 MARCHAM

VAUGHN T MARKHAM [0424-31]
7666 OLD HICKORY DR
PENSACOLA, FL 32507

9171 9690 0935 0127 2284 69

SUE S MARKHAM [0424-31]
7666 OLD HICKORY DR
PENSACOLA, FL 32507

9171 9690 0935 0127 2284 52

Served



Scott Lunsford, CFC • Escambia County Tax Collector

EscambiaTaxCollector.com

facebook.com/ECTaxCollector

twitter.com/escambiatc



2023

REAL ESTATE

TAXES

Notice of Ad Valorem and Non-Ad Valorem Assessments

SCAN TO PAY ONLINE

ACCOUNT NUMBER	MILLAGE CODE	ESCROW CODE	PROPERTY REFERENCE NUMBER
09-4545-285	06		2125316101003001

PROPERTY ADDRESS:

1100 BLK S FAIRFIELD DR

EXEMPTIONS:

MARKHAM VAUGHN T &
 MARKHAM SUE S
 7666 OLD HICKORY DR
 PENSACOLA, FL 32507

PRIOR YEAR(S) TAXES OUTSTANDING

21 / 4162

AD VALOREM TAXES

TAXING AUTHORITY	MILLAGE RATE	ASSESSED VALUE	EXEMPTION AMOUNT	TAXABLE AMOUNT	TAXES LEVIED
COUNTY	6.6165	475	0	475	3.14
PUBLIC SCHOOLS					
BY LOCAL BOARD	1.9620	475	0	475	0.93
BY STATE LAW	3.1820	475	0	475	1.51
WATER MANAGEMENT	0.0234	475	0	475	0.01
SHERIFF	0.6850	475	0	475	0.33
M.S.T.U. LIBRARY	0.3590	475	0	475	0.17
ESCAMBIA CHILDRENS TRUST	0.4365	475	0	475	0.21

TOTAL MILLAGE 13.2644

AD VALOREM TAXES

\$6.30

LEGAL DESCRIPTION

NON-AD VALOREM ASSESSMENTS

LEGAL DESCRIPTION	TAXING AUTHORITY	RATE	AMOUNT
BEG AT NE COR OF LT 7 S 1 DEG 58 MIN 50 SEC W ALG E LI OF SEC 682 78/100 FT FOR See Additional Legal on Tax Roll	FP FIRE PROTECTION		15.03
NON-AD VALOREM ASSESSMENTS			\$15.03

Pay online at EscambiaTaxCollector.com

Payments must be in U.S. funds drawn from a U.S. bank

COMBINED TAXES AND ASSESSMENTS

\$21.33

If Paid By	Mar 31, 2024	Apr 30, 2024	May 31, 2024
Please Pay	\$21.33	\$21.97	\$56.97

RETAIN FOR YOUR RECORDS

2023 REAL ESTATE TAXES

DETACH HERE AND RETURN THIS PORTION WITH YOUR PAYMENT

Make checks payable to:

Scott Lunsford, CFC
 Escambia County Tax Collector

P.O. BOX 1312
 PENSACOLA, FL 32591

Pay online at EscambiaTaxCollector.com

**PRIOR YEAR(S) TAXES
OUTSTANDING**

Payments in U.S. funds from a U.S. bank

PAY ONLY ONE AMOUNT

AMOUNT IF PAID BY	Mar 31, 2024
	21.33
AMOUNT IF PAID BY	Apr 30, 2024
	21.97
AMOUNT IF PAID BY	May 31, 2024
	56.97
AMOUNT IF PAID BY	
AMOUNT IF PAID BY	

DO NOT FOLD, STAPLE, OR MUTILATE

ACCOUNT NUMBER

09-4545-285

PROPERTY ADDRESS

1100 BLK S FAIRFIELD DR

MARKHAM VAUGHN T &
 MARKHAM SUE S
 7666 OLD HICKORY DR
 PENSACOLA, FL 32507

1 094545285 2023 1

THE SUMMATION WEEKLY

A Weekly Publication of the Escambia-Santa Rosa Bar Association Since 2014

NOTICE OF APPLICATION FOR TAX DEED

NOTICE IS HEREBY GIVEN, That RYAN VIGNEAU holder of Tax Certificate No. 04162, issued the 1st day of June, A.D., 2021 has filed same in my office and has made application for a tax deed to be issued thereon. Said certificate embraces the following described property in the County of Escambia, State of Florida, to wit:

(see attached)

SECTION 21, TOWNSHIP 2 S, RANGE 31 W
TAX ACCOUNT NUMBER 094545285 (0424-31)

The assessment of the said property under the said certificate issued was in the name of

VAUGHN T MARKHAM and SUE S MARKHAM

Unless said certificate shall be redeemed according to law, the property described therein will be sold to the highest bidder at public auction at 9:00 A.M. on the first Wednesday in the month of April, which is the 3rd day of April 2024.

Dated this 22nd day of February 2024.

In accordance with the AMERICANS WITH DISABILITIES ACT, if you are a person with a disability who needs special accommodation in order to participate in this proceeding you are entitled to the provision of certain assistance. Please contact Emily Hogg not later than seven days prior to the proceeding at Escambia County Government Complex, 221 Palafox Place Ste 110, Pensacola FL 32502. Telephone: 850-595-3793.

PAM CHILDERS
CLERK OF THE CIRCUIT COURT
ESCAMBIA COUNTY, FLORIDA

By:
Emily Hogg
Deputy Clerk

Before the undersigned authority personally appeared Malcolm Ballinger who under oath says that he is the Legal Administrator and Publisher of The Summation Weekly Newspaper published at Pensacola in Escambia & Santa Rosa County, Florida; that the attached copy of the advertisement, being a notice in the matter of 2021-TD-04162 in the Escambia County Court was published in said newspaper in and was printed and released on March 6, 2024; March 13, 2024; March 20, 2024; and March 27, 2024.

Affiant further says that the said Summation Weekly is a newspaper published at Pensacola, in said Escambia & Santa Rosa Counties, Florida, and that the said newspaper has heretofore been continuously published in said Escambia & Santa Rosa Counties, Florida each week and has been entered as second class mail matter at the post office in Pensacola, in said Escambia County, Florida, for a period of one year next preceding the first publication of the attached copy of advertisement; and affiant further says that he has neither paid nor promised any person, firm or corporation any discount, rebate, commission or refund for the purpose of securing this advertisement for publication of the said newspaper.

X

MALCOLM BALLINGER, PUBLISHER FOR THE
SUMMATION WEEKLY

STATE OF FLORIDA
COUNTY OF ESCAMBIA

The foregoing instrument was acknowledged before me by means of ☒ physical presence or ☐ online notarization, this 27th day of March, 2024, by MALCOLM BALLINGER, who is personally known to me.

X

, NOTARY PUBLIC



Brooklyn Faith Coates
Notary Public
State of Florida
Comm# HH053675
Expires 10/14/2024

THE SUMMATION WEEKLY

A Weekly Publication of the Escambia-Santa Rosa Bar Association Since 2014

LEGAL DESCRIPTION

BEG AT NE COR OF LT 7 S 1 DEG 58 MIN 50 SEC W ALG E LI OF SEC 682 78/100 FT FOR POB SWLY ALG CENTER LI OF BAYOU CHICO CREEK THE FOLLOWING 4 COURSES & DIST S 70 DEG 39 MIN 0 SEC W 987 39/100 FT S 73 DEG 18 MIN 0 SEC W 700 FT S 42 DEG 58 MIN 0 SEC W 285 FT S 33 DEG 37 MIN 0 SEC W 744 65/100 FT TO NELY RW LI OF S R 289-A WHICH PT LIES ON ARC OF CIRCULAR CURVE CONCAVE SWLY RADIUS 1196 28/100 FT TANGENT BEARS S 42 DEG 19 MIN 05 SEC E SELY ALG SD RW AND CURVE THRU CENTRAL ANG 6 DEG 20 MIN 36 SEC ARC DIST 132 44/100 FT TO NW COR OF LT 1 BLK 2 FAIRFIELD EAST UNIT 1 ELY ALG NLY BOUNDARY OF SD S/D THE FOLLOWING COURSES AND DIST N 60 DEG 15 MIN 50 SEC E 242 32/100 FT N 57 DEG 22 MIN 30 SEC E 37 30/100 FT N 52 DEG 36 MIN 30 SEC E 62 22/100 FT N 7 DEG 59 MIN 10 SEC W 20 FT N 52 DEG 59 MIN 10 SEC W 45 86/100 FT THENCE RT ALG CIRCULAR CURVE CONCAVE SELY RADIUS 150 FT CENTRAL ANG 180 DEG 0 MIN 0 SEC ARC DIST 471 24/100 FT S 52 DEG 59 MIN 10 SEC E 60 FT N 65 DEG 49 MIN 32 SEC E 22 17/100 FT THENCE ALG CIRCULAR CURVE CONCAVE SELY RADIUS 280 FT CENTRAL ANG 23 DEG 0 MIN 06 SEC ARC DIST 112 41/100 FT N 75 DEG 53 MIN 56 SEC E 83 16/100 FT N 30 DEG 53 MIN 56 SEC E 20 FT N 14 DEG 06 MIN 04 SEC W 45 86/100 FT THENCE TO RT ALG CURVE CONCAVE SE RADIUS 150 FT CENTRAL ANG 180 FT 0 MIN 0 SEC ARC DIST 471 24/100 FT S 14 DEG 06 MIN 04 SEC E 45 86/100 FT S 59 DEG 06 MIN 04 SEC E 20 FT N 75 DEG 53 MIN 56 SEC E 48 03/100 FT THENCE RT ALG CIRCULAR CURVE CONCAVE SELY RADIUS 1130 FT CENTRAL ANG 6 DEG 32 MIN 0 SEC ARC DIST 128 85/100 FT N 59 DEG 34 MIN 08 SEC E 25 99/100 FT N 4 DEG 56 MIN 32 SEC W 230 FT N 15 DEG 19 MIN 54 SEC W 97 26/100 FT THENCE RT ALG CIRCULAR CURVE CONCAVE SELY RADIUS 150 FT CENTRAL ANG 87 DEG 09 MIN 54 SEC ARC DIST 228 20/100 FT N 71 DEG 50 MIN 0 SEC E 479 43/100 FT S 37 DEG 57 MIN 16 SEC E 312 14/100 FT TO NWLY RADIUS 170 FT TANGENT BEARS N 41 DEG 53 MIN 03 SEC E NELY ALG SD RW AND CURVE THRU CENTRAL ANG 8 DEG 33 MIN 14 SEC ARC DIST 25 38/100 FT S 56 DEG 40 MIN 21 SEC E 197 69/100 FT N 64 DEG 53 MIN 50 SEC E 34 80/100 FT TO E LI OF SEC 21 N 1 DEG 58 MIN 50 SEC E ALG E LI OF SEC 489 97/100 FT TO POB OR 6410 P 919 SEC 21/15 T 2S R 31 LESS OR 4509 P 1125 ESCAMBIA COUNTY FLORIDA LESS OR 5134 P 1945 MARCHAM

4WR3/6-3/27TD



Escambia Sun Press

PUBLISHED WEEKLY SINCE 1948
(Warrington) Pensacola, Escambia County, Florida

STATE OF FLORIDA

County of Escambia

Before the undersigned authority personally appeared Michael P. Driver who is personally known to me and who on oath says that he is Publisher of The Escambia Sun Press, a weekly newspaper published at (Warrington) Pensacola in Escambia County, Florida; that the attached copy of advertisement, being a

NOTICE

in the matter of

TAX DEED SALE

DATE 05-01-2024 - TAX CERTIFICATE # 04162

in the

Court

was published in said newspaper in the issues of

APRIL 18, 2024

Affiant further says that the said Escambia Sun-Press is a newspaper published at (Warrington) Pensacola, in said Escambia County, Florida, and that the said newspaper has heretofore been continuously published in said Escambia County, Florida each week and has been entered as second class mail matter at the post office in Pensacola, in said Escambia and Santa Rosa Counties, Florida, for a period of one year next preceding the first publication of the attached copy of advertisement; and affiant further says that he has neither paid nor promised any person, firm or corporation any discount, rebate, commission or refund for the purpose of securing this advertisement for publication in the said newspaper.

Digitally signed by Michael P. Driver
DN: c=US, o=The Escambia Sun Press LLC,
dnQualifier=A01410D00000181FD1A68F30006C09B, cn=Michael P. Driver
Date: 2024.04.18 09:34:25 -05'00'

PUBLISHER

Sworn to and subscribed before me this 18TH day of APRIL
A.D., 2024

Digitally signed by Heather Tuttle
DN: c=US, o=The Escambia Sun Press LLC,
dnQualifier=A01410C000001890CD5793600064AAE, cn=Heather Tuttle
Date: 2024.04.18 09:37:37 -05'00'

HEATHER TUTTLE
NOTARY PUBLIC



HEATHER TUTTLE
Notary Public, State of Florida
My Comm. Expires June 24, 2024
Commission No. HH4627

Page 1 of 2

NOTICE OF APPLICATION FOR TAX DEED

NOTICE IS HEREBY GIVEN, That RYAN VIGNEAU holder of Tax Certificate No. 04162, issued the 1st day of June, A.D., 2021 has filed same in my office and has made application for a tax deed to be issued thereon. Said certificate embraces the following described property in the County of Escambia, State of Florida, to wit:

LEGAL DESCRIPTION

BEG AT NE COR OF LT 7 S 1 DEG 58 MIN 50 SEC W ALG E LI OF SEC 682 78/100 FT FOR POB SWLY ALG CENTER LI OF BAYOU CHICO CREEK THE FOLLOWING 4 COURSES & DIST S 70 DEG 39 MIN 0 SEC W 987 39/100 FT S 73 DEG 18 MIN 0 SEC W 700 FT S 42 DEG 58 MIN 0 SEC W 285 FT S 33 DEG 37 MIN 0 SEC W 744 65/100 FT TO NELY R/W LI OF S R 289-A WHICH PT LIES ON ARC OF CIRCULAR CURVE CONCAVE SWLY RADIUS 1196 28/100 FT TANGENT BEARS S 42 DEG 19 MIN 05 SEC E SELY ALG SD R/W AND CURVE THRU CENTRAL ANG 6 DEG 20 MIN 36 SEC ARC DIST 132 44/100 FT TO NW COR OF LT 1 BLK 2 FAIRFIELD EAST UNIT 1 ELY ALG NLY BOUNDARY OF SD S/D THE FOLLOWING COURSES AND DIST N 60 DEG 15 MIN 50 SEC E 242 32/100 FT N 57 DEG 22 MIN 30 SEC E 37 30/100 FT N 52 DEG 36 MIN 30 SEC E 62 22/100 FT N 7 DEG 59 MIN 10 SEC W 20 FT N 52 DEG 59 MIN 10 SEC W 45 86/100 FT THENCE RT ALG CIRCULAR CURVE CONCAVE SELY RADIUS 150 FT CENTRAL ANG 180 DEG 0 MIN 0 SEC ARC DIST 471 24/100 FT S 52 DEG 59 MIN 10 SEC E 60 FT N 65 DEG 49 MIN 32 SEC E 22 17/100 FT THENCE ALG CIRCULAR CURVE CONCAVE SELY RADIUS 280 FT CENTRAL ANG 23 DEG 0 MIN 06 SEC ARC DIST 112 41/100 FT N 75 DEG 53 MIN 56 SEC E 83 16/100 FT N 30 DEG 53 MIN 56 SEC E 20 FT N 14 DEG 06 MIN 04 SEC W 45 86/100 FT THENCE TO RT ALG CURVE CONCAVE SE RADIUS 150 FT CENTRAL ANG 180 FT 0 MIN 0 SEC ARC DIST 471 24/100 FT S 14 DEG 06 MIN 04 SEC E 45 86/100 FT S 59 DEG 06 MIN 04 SEC E 20 FT N 75 DEG 53 MIN 56 SEC E 48 03/100 FT THENCE RT ALG CIRCULAR CURVE CONCAVE SELY RADIUS 1130 FT CENTRAL ANG 6 DEG 32 MIN 0 SEC ARC DIST 128 85/100 FT N 59 DEG 34 MIN 08 SEC E 25 99/100 FT N 4 DEG 56 MIN 32 SEC W 230 FT N 15 DEG 19 MIN 54 SEC W 97 26/100 FT THENCE RT ALG CIRCULAR CURVE CONCAVE SELY RADIUS 150 FT CENTRAL ANG 87 DEG 09 MIN 54 SEC ARC DIST 228 20/100 FT N 71 DEG 50 MIN 0 SEC E 479 43/100 FT S 37 DEG 57 MIN 16 SEC E 312 14/100 FT TO NWLY RADIUS 170 FT TANGENT BEARS N 41 DEG 53 MIN 03 SEC E NELY ALG SD R/W AND CURVE THRU CENTRAL ANG 8 DEG 33 MIN 14 SEC ARC DIST 25 38/100 FT S 56 DEG 40 MIN 21 SEC E 197 69/100 FT N 64 DEG 53 MIN 50 SEC E 34 80/100 FT TO E LI OF SEC 21 N 1 DEG 58 MIN 50 SEC E ALG E LI OF SEC 489 97/100 FT TO POB OR 6410 P 919 SEC 21/15 T 2S R 31 LESS OR 4509 P 1125 ESCAMBIA COUNTY

FLORIDA LESS OR 5134 P 1945 MAR-
CHAM

SECTION 21, TOWNSHIP 2 S, RANGE
31 W

TAX ACCOUNT NUMBER 094545285
(0424-31)

The assessment of the said property under
the said certificate issued was in the name
of **VAUGHN T MARKHAM and SUE S
MARKHAM**

Unless said certificate shall be redeemed
according to law, the property described
therein will be sold to the highest bidder at
public auction at 9:00 A.M. on the **first**
Wednesday in the month of May, which is
the **1st day of May 2024**.

Dated this 5th day of April 2024.

In accordance with the AMERICANS
WITH DISABILITIES ACT, if you are a
person with a disability who needs special
accommodation in order to participate in
this proceeding you are entitled to the pro-
vision of certain assistance. Please contact
Emily Hogg not later than seven days prior
to the proceeding at Escambia County Gov-
ernment Complex, 221 Palafox Place Ste
110, Pensacola FL 32502. Telephone: 850-
595-3793.

PAM CHILDERS
CLERK OF THE CIRCUIT COURT
ESCAMBIA COUNTY, FLORIDA
(SEAL)

By: Emily Hogg
Deputy Clerk

oaw-1w-04-18-2024

Sworn to and subscribed before me this 18TH day of APRIL A.D., 2024

Heather Tuttle

Digitally signed by Heather Tuttle
DN: c=US, o=The Escambia Sun Press LLC,
dnQualifier=A01410C00001890CD5793600064AAE, cn=Heather Tuttle
Date: 2024.04.18 09:37:44 -0500

HEATHER TUTTLE
NOTARY PUBLIC

Page 2 of 2



HEATHER TUTTLE
Notary Public, State of Florida
My Comm. Expires June 24, 2024
Commission No. HH4627